

**KLIPPON K1 EX****Weidmüller Interface GmbH & Co. KG**

Klingenbergstraße 26

D-32758 Detmold

Germany

www.weidmueller.com

**Similar to illustration**

The aluminium Klippon® K enclosures are suitable for use in an extremely wide range of different areas. Various components can be installed inside the enclosures, and will benefit in particular from the high temperature resistance, the excellent IP protection and the good impact resistance.

No matter what kind of application the customer is planning, Weidmüller is able to provide a wide range of aluminium enclosures precisely fitting the customer's requirements.

Klippon® K enclosures for hazardous areas are available on request.

Our extensive product range offers the following advantages:

- Available in two surface finishes: natural and powder-coated (RAL 7001)
- With chloroprene moulded seal as standard (silicone moulded seal optionally available)
- Standardised closure system with Torx slotted screw head for 19 enclosure sizes
- Mounting holes outside of the gasket area
- High IP protection classes: IP66, IP67 and IP68 according to DIN EN 60529
- Impact resistance of up to 7 (10) Joules
- The enclosures are approved according ATEX, IECEx, cULus, and DNV GL as well as the empty enclosure standard.

- Suitable for railway applications according to EN 45545-2:2013
- Alloy is resistant to salt water
- Standardised distributor enclosures with threaded holes and a variety of terminal configurations

**General ordering data**

Version	Klippon K (aluminium empty enclosure), Empty enclosure, Aluminium enclosure, Height: 70 mm, Width: 70 mm, Depth: 45 mm, Material: Aluminium AISi12, untreated, silver
Order No.	<a href="#">9526840000</a>
Type	KLIPPON K1 EX
GTIN (EAN)	4032248019151
Qty.	1 pc(s).

## KLIPPON K1 EX

Weidmüller Interface GmbH &amp; Co. KG

Klingenbergstraße 26

D-32758 Detmold

Germany

www.weidmueller.com

## Technical data

## Dimensions and weights

Depth	45 mm	Depth (inches)	1.772 inch
Height	70 mm	Height (inches)	2.756 inch
Width	70 mm	Width (inches)	2.756 inch
Mounting dimension - height	42 mm	Mounting dimension - width	58 mm
Net weight	272 g		

## Temperatures

Operating temperature	-60 °C...135 °C
-----------------------	-----------------

## Cable glands, left

M12	1	M16	1
-----	---	-----	---

## Cable glands, right

M12	1	M16	1
-----	---	-----	---

## Cable glands, top/bottom

M12	2	M16	2
M20	1		

## Certificate numbers enclosure

Approval conditions	DNV, GL, RMRS, ATEX, IECEX, UL AEx Class Div., CCC, INMETRO	Attestation of Conformity No. (AoC)	DE PS24 10 160308 001ISS01
Certificate No. (ATEX)	IBEXU12ATEX1145X	Certificate No. (DNV)	TAE00002SM
Certificate No. (IECEX)	IECEXIBE13.0002X	Certificate no. Terminal Box (ATEX)	IBEXU12ATEX1145 X
Certificate no. Terminal Box (IECEX)	IECEX IBE 13.0002X	Certificate no. Terminal Box (INMETRO)	LMP 23.0527X
Certificate no. empty enclosure (ATEX)	IBEXU12ATEX1144 U	Certificate no. empty enclosure (IECEX)	IECEX IBE 13.0001U
Certificate no. empty enclosure (INMETRO)	LMP 23.0526U	Declaration of Conformity No. (DoC LVD)	DE_PS24 10_160412_001ISS01

## General information

Access opening: height	63 mm	Access opening: width	63 mm
Areas of use	Explosive risk zone, Process industry, Transportation, Packaging industry, Marine engineering, Machine construction, Harbour facilities	Enclosure attachment	
Flange plate	No		Holes 4 mm
Integral fixing	Threaded holes M4	Impact resistance	7 J ATEX version
Lid attachment	M4 torx stainless steel screws with slot	Lid	Yes
Material thickness of cover	3 mm	Material	Aluminium AlSi12
Number of lid screws	4	Material thickness of enclosure	3.5 mm
Operating temperature, min.	-60 °C	Operating temperature, max.	135 °C
Seal material	Silicone	Protection degree	IP66, IP67
Surface finish	untreated	Standards	IEC 60079-0, IEC 60079-7, IEC 60079-31, EN 45545-2:2013
		Torque for lid screws	2.5 Nm

## KLIPPON K1 EX

Weidmüller Interface GmbH &amp; Co. KG

Klingenbergstraße 26

D-32758 Detmold

Germany

www.weidmueller.com

## Technical data

## horizontal assembly

WDU 2,5 / ZDU 2,5 / IDU 2,5

1x5

WDU 4 / ZDU 4

1x1\*

## vertical assembly

WDU 2,5 / ZDU 2,5 / IDU 2,5

1x1\*

WDU 4 / ZDU 4

1x1\*

## Classifications

ETIM 6.0

EC002503

ETIM 7.0

EC002503

ETIM 8.0

EC002503

ETIM 9.0

EC002503

ECLASS 9.0

27-18-05-02

ECLASS 9.1

27-18-05-02

ECLASS 10.0

27-18-05-02

ECLASS 11.0

27-18-05-02

ECLASS 12.0

27-18-05-02

ECLASS 13.0

27-18-05-02

## Environmental Product Compliance

REACH SVHC

Lead 7439-92-1

SCIP

9e4cab4e-239c-4e14-b9df-a0fee300d28a

## Approvals

Approvals



ROHS

Conform

## Downloads

Approval/Certificate/Document of Conformity

[CCC 2020322303000040 Klippon K Assembly Enclosure](#)
[UKCA TÜV 22 UKEX 7094 U](#)
[UKCA TÜV 22 UKEX 7095 X](#)
[Attestation of Conformity - Klippon K Empty Enclosures - AoC DE PS2410 160308 001ISS03](#)
[IBEXU12ATEX1145X](#)
[IECEXIBE13.0001U](#)
[IECEXIBE13.0002X](#)
[TAE00002SM](#)
[IBEXU12ATEX1144U](#)
[INMETRO LMP 23.0527X - Teminal Box CAIXAS DE JUNÇÃO KLIPPON K](#)
[INMETRO CERTIFICADO LMP 23.0526U - INVÓLUCROS VAZIOS Empty Enclosure KLIPPON K](#)
[EU Declaration of Conformity - Klippon K Empty Enclosures - DoC DE PS2410 160412 001ISS02](#)
[DoM Klippon K salt water resistance](#)
[DoM Klippon K EN 45545-2 2013 Railway](#)

Engineering Data

[CAD data – STEP](#)

Product Change Notification

[Technical change to Klippon K® enclosure series](#)
[Technische Änderung für Klippon® K Gehäuse](#)
[20240315-PCN-Klippon K Enclosure Instruction](#)

Tender specification

[Klippon K1 Ex\\_9526840000\\_DE](#)
[Klippon K1 Ex\\_9526840000\\_EN](#)

User Documentation

[Assembly guidelines - empty enclosures](#)

Catalogues

[Catalogues in PDF-format](#)

Brochures

[MB OVERV. PROCESS WD DE](#)
[MB KLIPPON ENCL.TECN EN](#)
[MB PROCESS EN](#)
[FL RAILWAY 2014 EN](#)
[FL RAILWAY 2014 EN](#)

Creation date April 28, 2024 2:01:40 AM CEST

Catalogue status 20.04.2024 / We reserve the right to make technical changes.

**KLIPPON K1 EX**

**Weidmüller Interface GmbH & Co. KG**  
Klingenbergstraße 26  
D-32758 Detmold  
Germany

[www.weidmueller.com](http://www.weidmueller.com)

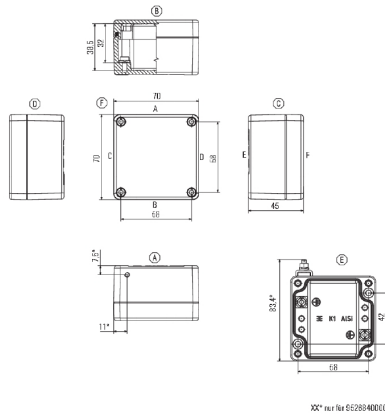
**Drawings****Dimensioned drawing**

## KLIPPON K1 EX

Weidmüller Interface GmbH &amp; Co. KG

Klingenbergstraße 26

D-32758 Detmold

Germany

www.weidmueller.com

## Accessories

## Klippon® K - Mounting plates



The system accessories for the Klippon® K enclosure series allows you to easily adapt the enclosures to meet the specific requirements of every application.

- DIN Rails TS 35 and TS 15
- Mounting plates
- Hinges
- Wall-mounted holder

## General ordering data

Type	MOPL K1 N FE	Version
Order No.	<a href="#">1905280000</a>	Klippon K (aluminium empty enclosure), Mounting plate, Mounting
GTIN (EAN)	4032248524426	plate, Height: 52 mm, Width: 61 mm, Depth: 3 mm, Material: Sheet
Qty.	1 pc(s).	steel, galvanized, galvanized, silver

## Installation material



### Integrate, expand and customise - the perfect supplement to every application

The fully structured range of system accessories for the new Klippon® TB enclosure series allows you to easily adapt the enclosures to meet the specific requirements of every application.

#### Mounting hardware kits

Mounting hardware kits are available for quick and easy installation of type label holders, document holders and rain hoods.

The **label fastening set – SD** is required to install a plastic (Trafolyte) ID or type label. With the aid of this set can you mount the ID or type label directly on the enclosure cover. The label fastening set has been specially developed for this purpose. Only by using this fastening set can you ensure that there will be no leaks into the enclosure or damage to the label.

The **universal fastening set – TPSD** has been developed to enable secure and quick installation of type label holders, rain covers or document holders, for example. By using this fastening set, the risk of leaks can be minimised, if not avoided.

## General ordering data

Type	TPSD FIXING SET KTB	Version
Order No.	<a href="#">1252190000</a>	Klippon TB (Terminal Box), Type plate fixings set, Material: Stainless
GTIN (EAN)	4050118043969	steel, rust-proof, untreated, silver
Qty.	1 pc(s).	
Type	SD FIXING SET	Version
Order No.	<a href="#">1285200000</a>	Klippon TB (Terminal Box), Identification plate fixing set, Height: 12
GTIN (EAN)	4050118075472	mm, Width: 12 mm, Depth: 16.4 mm, Material: Stainless steel, rust-
Qty.	1 pc(s).	proof, untreated, silver

## KLIPPON K1 EX

Weidmüller Interface GmbH &amp; Co. KG

Klingenbergstraße 26

D-32758 Detmold

Germany

www.weidmueller.com

## Accessories

## TS 15



The system accessories for the Klippon® K enclosure series allows you to easily adapt the enclosures to meet the specific requirements of every application.

- DIN Rails TS 35 and TS 15
- Mounting plates
- Hinges
- Wall-mounted holder

## General ordering data

Type	TS15 60 Klippon K1 CSS	Version
Order No.	<a href="#">1909980000</a>	Rail, TS 15, Width: 60 mm, without slot, Steel, galvanized, chromium-plated
GTIN (EAN)	4032248536900	
Qty.	1 pc(s).	
Type	TS15X5 ST K1	Version
Order No.	<a href="#">8000003883</a>	Rail, TS 15, Width: 60 mm, without slot, Steel, galvanic zinc plated and passivated
GTIN (EAN)	4050118653328	
Qty.	20 pc(s).	

## Screws



Depending on the terminal block or also accessories, we offer different types of screws as additional items or also spare parts.

## General ordering data

Type	FKSC M4X6 D8/SW2	Version
Order No.	<a href="#">1567480000</a>	SAK Series, Allen hex screw, Screws, Number of poles: 1
GTIN (EAN)	4008190033491	
Qty.	100 pc(s).	