

KLIPPON POK1 M16BCSS EX**Weidmüller Interface GmbH & Co. KG**

Klingenbergstraße 26

D-32758 Detmold

Germany

www.weidmueller.com

Various types of terminal boxes are available for installing signal / power supplies or distributors in explosive risk zones. The terminal boxes are explosion-protected equipment approved for use in Ex areas in zones 0, 1, 2 and 20, 21, 22. They are certified in accordance with the latest international standards Ex e, Ex ia and Ex tb. Customer-specific configuration means these terminal boxes are the optimum solution for all applications. Use the product overview to find the right solution for you! Combine the enclosure, with or without threaded holes, a suitable mounting rail or pre-fitted strip terminals. We have put together a small selection for you, but we are happy to configure a bespoke solution for you.

Features:

- Available in a wide range of versions to meet customer requirements
- Additional international approvals alongside IECEx and ATEX also available
- Increased quality thanks to the use of established basic products in the Klippon® brand

General ordering data

Version	Terminal Box, ATEX II 2GD T85°C Ex e II T6, KLIPPON POK 080806 EX, KL SET 6A4 S, Drill holes side A: 2 x M16x1.5, Drill holes side B: 2 x M16x1.5
Order No.	8000004222
Type	KLIPPON POK1 M16BCSS EX
GTIN (EAN)	4032248986415
Qty.	1 pc(s).
Reference product	1306000000 8000004144

KLIPPON POK1 M16BCSS EX**Weidmüller Interface GmbH & Co. KG**

Klingenbergstraße 26

D-32758 Detmold

Germany

www.weidmueller.com

Technical data**Dimensions and weights**

Depth	75 mm	Depth (inches)	2.953 inch
Height	55 mm	Height (inches)	2.165 inch
Width	80 mm	Width (inches)	3.15 inch
Net weight	450 g		

Certificate numbers enclosure

Certificate no. Terminal Box (ATEX)	IBExU13ATEX1004 X	Certificate no. Terminal Box (IECEX)	IECEX IBE 13.0004X
-------------------------------------	-------------------	--------------------------------------	--------------------

Housing

Drill holes side A	2 x M16x1.5	Drill holes side B	2 x M16x1.5
Material	Glass fibre-reinforced polyester		

Classifications

ETIM 6.0	EC002503	ETIM 7.0	EC002503
ETIM 8.0	EC002503	ETIM 9.0	EC002503
ECLASS 9.0	27-18-05-02	ECLASS 9.1	27-18-05-90
ECLASS 10.0	27-18-05-02	ECLASS 11.0	27-18-05-02
ECLASS 12.0	27-18-05-02	ECLASS 13.0	27-18-05-02

Environmental Product Compliance

REACH SVHC	Lead 7439-92-1
SCIP	c0b142f1-4049-4b95-bbc3-9959a2d3b09c

Downloads

Approval/Certificate/Document of Conformity	IECEXIBE13.0004X IBEXU13ATEX1004X EU Declaration of Conformity - Klippon POK Terminal Box - DoC DE PS270X 160308 003ISS03
User Documentation	INSTR POK EQUIP
Catalogues	Catalogues in PDF-format
Brochures	

KLIPPON POK1 M16BCSS EX

Weidmüller Interface GmbH & Co. KG
Klingenbergstraße 26
D-32758 Detmold
Germany

www.weidmueller.com

Drawings

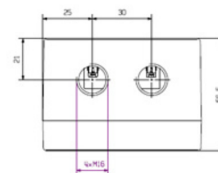
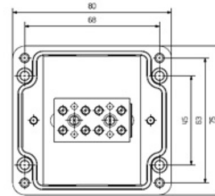

KLIPPON POK1 M16BCSS EX**Weidmüller Interface GmbH & Co. KG**

Klingenbergstraße 26

D-32758 Detmold

Germany

www.weidmueller.com**Accessories****Metric**

A2L type cable glands are suitable for un-armored cable, maintains flameproof Ex d and Increased Safety Ex e explosion protection.

General ordering data

Type	A2L/16/M16-WM	Version
Order No.	1186880000	A2L (Klippon unarmored Ex e/d cable gland), Cable glands, straight,
GTIN (EAN)	4050118074345	M 16 x 1.5, 16 mm, OD min. 4.5 - OD max. 8.7 mm, Brass, nickel-
Qty.	24 pc(s).	plated

Plastic blanking plugs Ex e/i 7 Joule

In addition to cable glands for a wide range of applications, the product portfolio is rounded off by plugs, pressure compensation elements, adaptors and the corresponding accessories such as locknuts, sealing rings, flat washers and earthing rings.

General ordering data

Type	VP M16 EX SI 7J	Version
Order No.	2066720000	VPK EX 7J (Ex blanking plug, plastic, 7J), Blanking plug, in closed
GTIN (EAN)	4050118415438	state, M 16, 12 mm, IP54, IP66, IP67, IP68 - 5 bar (30 min.),
Qty.	100 pc(s).	Polyamide 6

KLIPPON POK1 M16BCSS EX**Weidmüller Interface GmbH & Co. KG**

Klingenbergstraße 26

D-32758 Detmold

Germany

www.weidmueller.com**Accessories****Brass blanking plugs, VP HEX head Ex e/d**

VP series stopping plugs provide a method of filling unused entries in Ex equipment while maintaining Flameproof Ex d and Increased Safety Ex e explosion protection and IP66/67/68 ingress rate.

General ordering data

Type	VP-HEX M16-EX W	Version
Order No.	1218940000	VP-HEX (Klippon Ex blanking plug with hexagon head), Blanking plug,
GTIN (EAN)	4050118075564	straight, M 16 x 1.5, 16 mm, Brass, nickel-plated
Qty.	24 pc(s).	

External thread M16

ADAP series adaptors provide flexibility and versatility infilling unused entries in Ex equipment while maintaining Flameproof Ex d and Increased Safety Ex e explosion protection and IP66/67/68 ingress rate.

General ordering data

Type	ADAP M16-M20-W	Version
Order No.	1262730000	ADAP (Klippon Ex adaptor), Adapter, straight, M 16 ,M 20, Brass,
GTIN (EAN)	4050118088618	nickel-plated
Qty.	16 pc(s).	

KLIPPON POK1 M16BCSS EX**Weidmüller Interface GmbH & Co. KG**

Klingenbergstraße 26

D-32758 Detmold

Germany

www.weidmueller.com**Accessories****Silicone seal material, -60°C - +70°C**

Polyamide cable glands, which are suitable for usage in explosion risk zones Ex e (increased safety) and Ex i (intrinsic safety).

Weidmüller offers a product family without restrictions and besides compliance with standards, the cable gland excels thanks to its increased impact resistance of 4/7 Joule and a possible temperature range down to -60°C without restrictions. They have been tested to the current standard and EN 60079-0 directive, they are ATEX and IECEx certified.

General ordering data

Type	VG M16 EXE 6-10 SI7J G4	Version
Order No.	2722090000	VG Exe 7J (Ex plastic cable gland 7J Exe), Cable glands, straight, M
GTIN (EAN)	4050118821321	16, 10 mm, OD min. 6 - OD max. 10 mm, IP54, IP66, IP67, IP68 - 5
Qty.	50 pc(s).	bar (30 min.), Polyamide 6
Type	VG M16 EXE 5-8 SI7J G4	Version
Order No.	2722080000	VG Exe 7J (Ex plastic cable gland 7J Exe), Cable glands, straight, M
GTIN (EAN)	4050118821314	16, 10 mm, OD min. 5 - OD max. 8 mm, IP54, IP66, IP67, IP68 - 5 bar
Qty.	50 pc(s).	(30 min.), Polyamide 6