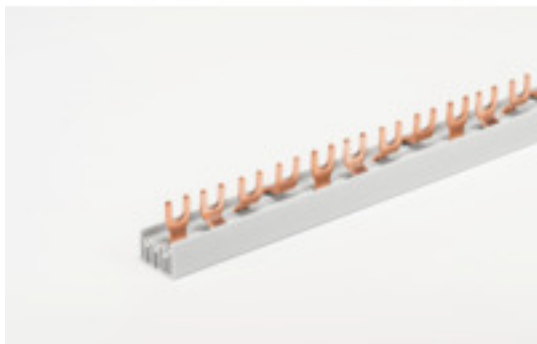

**G-4L+9-1000/16 C****Weidmüller Interface GmbH & Co. KG**

Klingenbergstraße 26

D-32758 Detmold

Germany

[www.weidmueller.com](http://www.weidmueller.com)

Similar to illustration

4-pole fork-type phase distribution bars are used for potential distribution to other components in the control cabinet such as circuit breakers, residual current circuit breakers and other installation devices.

**General ordering data**

Version	Cross-connector (terminal), Number of poles: 48, Pitch in mm (P): 17.80, 80 A, grey
Order No.	<a href="#">2658780000</a>
Type	G-4L+9-1000/16 C
GTIN (EAN)	4050118671742
Qty.	15 pc(s).

**G-4L+9-1000/16 C****Weidmüller Interface GmbH & Co. KG**

Klingenbergstraße 26

D-32758 Detmold

Germany

[www.weidmueller.com](http://www.weidmueller.com)**Technical data****Dimensions and weights**

Depth	20.2 mm	Depth (inches)	0.795 inch
Height	28.5 mm	Height (inches)	1.122 inch
Width	1,016 mm	Width (inches)	40 inch
Net weight	523.933 g		

**Material data**

Colour	grey
--------	------

**Dimensions**

Pitch in mm (P)	17.8 mm
-----------------	---------

**General**

Number of poles	48
-----------------	----

**Rating data**

Rated cross-section	16 mm <sup>2</sup>	Rated current	80 A
---------------------	--------------------	---------------	------

**Classifications**

ETIM 6.0	EC000489	ETIM 7.0	EC000489
ETIM 8.0	EC000489	ETIM 9.0	EC000489
ECLASS 9.0	27-14-11-40	ECLASS 9.1	27-14-11-40
ECLASS 10.0	27-14-11-40	ECLASS 11.0	27-14-11-40
ECLASS 12.0	27-14-11-40	ECLASS 13.0	27-25-03-03

**Approvals**

Approvals	
-----------	--



ROHS	Conform
------	---------

**Downloads**

Approval/Certificate/Document of Conformity	<a href="#">CE Declaration of Conformity</a>
Catalogues	<a href="#">Catalogues in PDF-format</a>

## G-4L+9-1000/16 C

**Weidmüller Interface GmbH & Co. KG**  
Klingenbergstraße 26  
D-32758 Detmold  
Germany

[www.weidmueller.com](http://www.weidmueller.com)

## Drawings

### Drawing

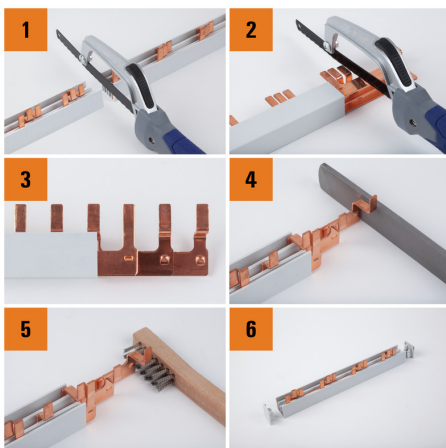
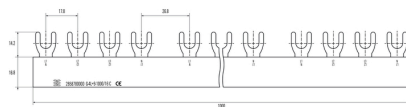

## G-4L+9-1000/16 C

Weidmüller Interface GmbH &amp; Co. KG

Klingenbergstraße 26

D-32758 Detmold

Germany

www.weidmueller.com

## Accessories

## End caps and covers



End caps and covers ensure the required creepage distances in the system even after the bus bars have been cut to length or in the case of free-standing contacts, and guarantee finger safety in accordance with DIN EN 50274.

## General ordering data

Type	END CAP G+S 4L/16	Version
Order No.	<a href="#">2659030000</a>	Terminal cover, grey
GTIN (EAN)	4050118671506	
Qty.	10 pc(s).	
Type	PROTECTION COVER G+S /5	Version
Order No.	<a href="#">2659040000</a>	Terminal cover, yellow
GTIN (EAN)	4050118671490	
Qty.	10 pc(s).	

## Feed in terminals



Our feed-in modules facilitate handling when feeding the system. For example, the bending radius of the cable can be reduced by using a feed-in module with side entry.

## General ordering data

Type	FIT 25 GN	Version
Order No.	<a href="#">2659050000</a>	Auxiliary connection (terminal), 25 mm <sup>2</sup>
GTIN (EAN)	4050118671483	
Qty.	10 pc(s).	
Type	FIT 50 SN	Version
Order No.	<a href="#">2659080000</a>	Auxiliary connection (terminal), 50 mm <sup>2</sup>
GTIN (EAN)	4050118671452	
Qty.	3 pc(s).	
Type	FIT 50 GN	Version
Order No.	<a href="#">2659070000</a>	Auxiliary connection (terminal), 50 mm <sup>2</sup>
GTIN (EAN)	4050118671469	
Qty.	3 pc(s).	
Type	FIT 50 GN/F	Version
Order No.	<a href="#">2659090000</a>	Auxiliary connection (terminal), 50 mm <sup>2</sup>
GTIN (EAN)	4050118671445	
Qty.	3 pc(s).	

**G-4L+9-1000/16 C****Weidmüller Interface GmbH & Co. KG**

Klingenbergstraße 26

D-32758 Detmold

Germany

[www.weidmueller.com](http://www.weidmueller.com)**Accessories**

Type	FIT 25 SN	Version
Order No.	<a href="#">2659060000</a>	Auxiliary connection (terminal), 25 mm <sup>2</sup>
GTIN (EAN)	4050118671476	
Qty.	10 pc(s).	
Type	FIT 50 SN/F	Version
Order No.	<a href="#">2659100000</a>	Auxiliary connection (terminal), 50 mm <sup>2</sup>
GTIN (EAN)	4050118671438	
Qty.	3 pc(s).	