

**S-1L-320/16****Weidmüller Interface GmbH & Co. KG**

Klingenbergstraße 26

D-32758 Detmold

Germany

[www.weidmueller.com](http://www.weidmueller.com)**Product image**

1-pole pin-type phase distribution bars are used for potential distribution to other components in the control cabinet such as circuit breakers, residual current circuit breakers and other installation devices.

**General ordering data**

Version	Cross-connector (terminal), Number of poles: 18, Pitch in mm (P): 17.80, 80 A, grey
Order No.	<a href="#">2658020000</a>
Type	S-1L-320/16
GTIN (EAN)	4050118672503
Qty.	20 pc(s).

**S-1L-320/16****Weidmüller Interface GmbH & Co. KG**

Klingenbergstraße 26

D-32758 Detmold

Germany

[www.weidmueller.com](http://www.weidmueller.com)**Technical data****Dimensions and weights**

Depth	16.8 mm	Depth (inches)	0.661 inch
Height	15.5 mm	Height (inches)	0.61 inch
Width	320 mm	Width (inches)	12.598 inch
Net weight	36.6 g		

**Material data**

Colour	grey
--------	------

**Dimensions**

Pitch in mm (P)	17.8 mm
-----------------	---------

**General**

Number of poles	18
-----------------	----

**Rating data**

Rated cross-section	16 mm <sup>2</sup>	Rated current	80 A
---------------------	--------------------	---------------	------

**Classifications**

ETIM 6.0	EC000489	ETIM 7.0	EC000489
ETIM 8.0	EC000489	ETIM 9.0	EC000489
ECLASS 9.0	27-14-11-40	ECLASS 9.1	27-14-11-40
ECLASS 10.0	27-14-11-40	ECLASS 11.0	27-14-11-40
ECLASS 12.0	27-14-11-40	ECLASS 13.0	27-25-03-03

**Approvals**

Approvals	
-----------	--



ROHS	Conform
------	---------

**Downloads**

Approval/Certificate/Document of Conformity	<a href="#">CE Declaration of Conformity</a>
Catalogues	<a href="#">Catalogues in PDF-format</a>

## S-1L-320/16

**Weidmüller Interface GmbH & Co. KG**

Klingenbergstraße 26

D-32758 Detmold

Germany

[www.weidmueller.com](http://www.weidmueller.com)

## Drawings

### Drawing

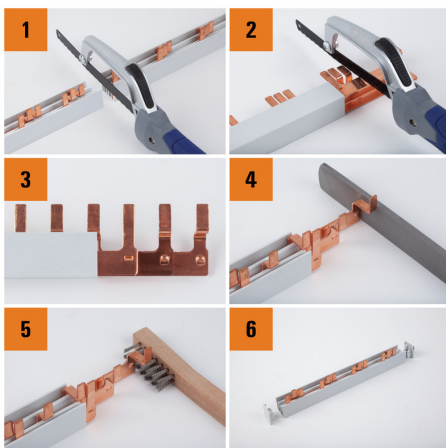

## S-1L-320/16

Weidmüller Interface GmbH &amp; Co. KG

Klingenbergstraße 26

D-32758 Detmold

Germany

www.weidmueller.com

## Accessories

## Feed in terminals



Our feed-in modules facilitate handling when feeding the system. For example, the bending radius of the cable can be reduced by using a feed-in module with side entry.

## General ordering data

Type	FIT 25 GN	Version
Order No.	<a href="#">2659050000</a>	Auxiliary connection (terminal), 25 mm <sup>2</sup>
GTIN (EAN)	4050118671483	
Qty.	10 pc(s).	
Type	FIT 50 SN/F	Version
Order No.	<a href="#">2659100000</a>	Auxiliary connection (terminal), 50 mm <sup>2</sup>
GTIN (EAN)	4050118671438	
Qty.	3 pc(s).	
Type	FIT 50 GN/F	Version
Order No.	<a href="#">2659090000</a>	Auxiliary connection (terminal), 50 mm <sup>2</sup>
GTIN (EAN)	4050118671445	
Qty.	3 pc(s).	
Type	FIT 50 GN	Version
Order No.	<a href="#">2659070000</a>	Auxiliary connection (terminal), 50 mm <sup>2</sup>
GTIN (EAN)	4050118671469	
Qty.	3 pc(s).	
Type	FIT 50 SN	Version
Order No.	<a href="#">2659080000</a>	Auxiliary connection (terminal), 50 mm <sup>2</sup>
GTIN (EAN)	4050118671452	
Qty.	3 pc(s).	
Type	FIT 25 SN	Version
Order No.	<a href="#">2659060000</a>	Auxiliary connection (terminal), 25 mm <sup>2</sup>
GTIN (EAN)	4050118671476	
Qty.	10 pc(s).	

**S-1L-320/16****Weidmüller Interface GmbH & Co. KG**

Klingenbergstraße 26

D-32758 Detmold

Germany

[www.weidmueller.com](http://www.weidmueller.com)**Accessories****End caps and covers**

End caps and covers ensure the required creepage distances in the system even after the bus bars have been cut to length or in the case of free-standing contacts, and guarantee finger safety in accordance with DIN EN 50274.

**General ordering data**

Type	END CAP G+S 1L/10-16	Version
Order No.	<a href="#">2658970000</a>	Terminal cover, grey
GTIN (EAN)	4050118671551	
Qty.	10 pc(s).	
Type	PROTECTION COVER G+S /5	Version
Order No.	<a href="#">2659040000</a>	Terminal cover, yellow
GTIN (EAN)	4050118671490	
Qty.	10 pc(s).	