

IE-PCB-M12X-S-90**Weidmüller Interface GmbH & Co. KG**

Klingenbergstraße 26

D-32758 Detmold

Germany

www.weidmueller.com**General ordering data**

| | |
|------------|---|
| Version | PCB plug-in connector, M12, Solder connection, Cat.6A / Class EA (ISO/IEC 11801 2010), IP67, when screwed in, Reflow compatible, 1-part |
| Order No. | 2168220000 |
| Type | IE-PCB-M12X-S-90 |
| GTIN (EAN) | 4050118427233 |
| Qty. | 10 pc(s). |

IE-PCB-M12X-S-90

Weidmüller Interface GmbH & Co. KG

Klingenbergstraße 26

D-32758 Detmold

Germany

www.weidmueller.com

Technical data

Dimensions and weights

| | | | |
|----------------------|--------|----------------------|--------|
| Wall thickness, min. | 1 mm | Wall thickness, max. | 2.5 mm |
| Net weight | 0.01 g | | |

Temperatures

| | |
|-----------------------|----------------|
| Operating temperature | -40 °C...85 °C |
|-----------------------|----------------|

Technical data of PCB plug-in connector

| | | | |
|-------------------|------------------|-----------------------|-----------------------|
| Coding | X-coded | Number of poles | 8 |
| Rated voltage | 48 V | Protection degree | IP67, when screwed in |
| Contact surface | Gold over nickel | Housing main material | CuZn |
| Connection thread | M12 | Insulation strength | 100 MΩ |
| Plugging cycles | ≥ 100 | Contact material | Cu-alloy |

General Info

| | | | |
|-----------------------|--------------------------|--------------------|--|
| Number of poles | 8 | Connection 1 | M12 |
| Connection 2 | Solder connection | Configuration | Reflow compatible |
| Housing main material | CuZn | Category | Cat.6A / Class EA (ISO/IEC 11801 2010) |
| Connection thread | M12 | Contact material | Cu-alloy |
| Contact surface | Gold over nickel | Shielding material | CuSn |
| Shielding | 360° all-round enclosure | Protection degree | IP67, when screwed in |
| Plugging cycles | ≥ 100 | | |

Classifications

| | | | |
|-------------|-------------|-------------|-------------|
| ETIM 6.0 | EC002638 | ETIM 7.0 | EC003568 |
| ETIM 8.0 | EC003568 | ETIM 9.0 | EC003568 |
| ECLASS 9.0 | 27-44-03-09 | ECLASS 9.1 | 27-44-03-09 |
| ECLASS 10.0 | 27-44-03-09 | ECLASS 11.0 | 27-44-01-10 |
| ECLASS 12.0 | 27-44-01-10 | ECLASS 13.0 | 27-44-01-10 |

Environmental Product Compliance

| | |
|------------|--------------------------------------|
| REACH SVHC | Lead 7439-92-1 |
| SCIP | 67cf1078-beca-4687-860b-dc475a6ec24a |

Approvals

Approvals



| | |
|-------------------------|------------|
| ROHS | Conform |
| UL File Number Search | UL Website |
| Certificate no. (cULus) | E316369 |

IE-PCB-M12X-S-90

Weidmüller Interface GmbH & Co. KG

Klingenbergstraße 26

D-32758 Detmold

Germany

www.weidmueller.com

Technical data

Downloads

| | |
|---|--|
| Approval/Certificate/Document of Conformity | DUXR.E316369 CC Link IE Field M12-X PROFINET Manufacturer's Declaration |
| Engineering Data | CAD data – STEP |
| User Documentation | MAN IE GUIDE DE MAN IE GUIDE EN |
| Catalogues | Catalogues in PDF-format |
| Brochures | MB FREECONTACT EN FL FIELDWIRING EN PI PROFINET CABLING EN PI PROFINET CABLING EN |

IE-PCB-M12X-S-90

Weidmüller Interface GmbH & Co. KG
 Klingenbergstraße 26
 D-32758 Detmold
 Germany

www.weidmueller.com

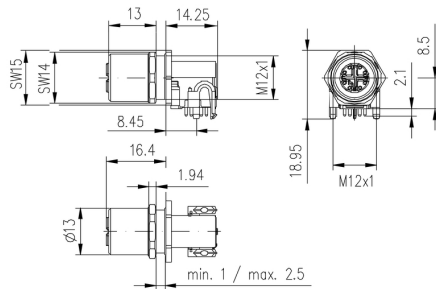
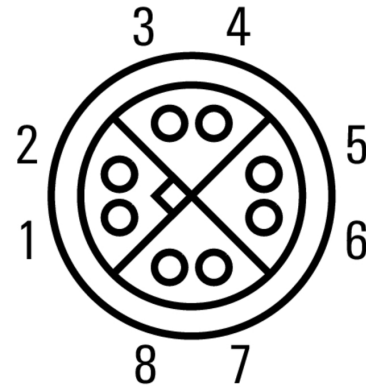
Drawings
Dimensioned drawing

Pinning

Drilling template
