

**KLIPPON K11 VMQ RAL7001****Weidmüller Interface GmbH & Co. KG**

Klingenbergstraße 26

D-32758 Detmold

Germany

[www.weidmueller.com](http://www.weidmueller.com)**Similar to illustration**

The aluminium Klippon® K enclosures are suitable for use in an extremely wide range of different areas. Various components can be installed inside the enclosures, and will benefit in particular from the high temperature resistance, the excellent IP protection and the good impact resistance.

No matter what kind of application the customer is planning, Weidmüller is able to provide a wide range of aluminium enclosures precisely fitting the customer's requirements.

Klippon® K enclosures for hazardous areas are available on request.

Our extensive product range offers the following advantages:

- Available in two surface finishes: natural and powder-coated (RAL 7001)
- With chloroprene moulded seal as standard (silicone moulded seal optionally available)
- Standardised closure system with Torx slotted screw head for 19 enclosure sizes
- Mounting holes outside of the gasket area
- High IP protection classes: IP66, IP67 and IP68 according to DIN EN 60529
- Impact resistance of up to 7 (10) Joules
- The enclosures are approved according ATEX, IECEx, cULus, and DNV GL as well as the empty enclosure standard.

- Suitable for railway applications according to EN 45545-2:2013
- Alloy is resistant to salt water
- Standardised distributor enclosures with threaded holes and a variety of terminal configurations

**General ordering data**

Version	Klippon K (aluminium empty enclosure), Empty enclosure, Aluminium enclosure, Height: 80 mm, Width: 75 mm, Depth: 57 mm, Material: Aluminium AISi12, Powder-coated, textured, Silver grey
Order No.	<a href="#">1937910000</a>
Type	KLIPPON K11 VMQ RAL7001
GTIN (EAN)	4032248610136
Qty.	10 pc(s).
Unassembled to fit rail	<a href="#">1909990000</a>

## KLIPPON K11 VMQ RAL7001

Weidmüller Interface GmbH &amp; Co. KG

Klingenbergstraße 26

D-32758 Detmold

Germany

www.weidmueller.com

## Technical data

## Dimensions and weights

Depth	57 mm	Depth (inches)	2.244 inch
Height	80 mm	Height (inches)	3.15 inch
Width	75 mm	Width (inches)	2.953 inch
Mounting dimension - height	52 mm	Mounting dimension - width	63 mm
Net weight	319.6 g		

## Temperatures

Operating temperature	-60 °C...135 °C
-----------------------	-----------------

## Cable glands, left

M12	2	M16	2
M20	1		

## Cable glands, right

M12	2	M16	2
M20	1		

## Cable glands, top/bottom

M12	2	M16	2
M20	1	M25	1

## Certificate numbers enclosure

Approval conditions	cULus, RMRS, DNV	Certificate No. (DNV)	TAE00002SM
Certificate no. (cULus)	E197061	Declaration of Conformity No. (DoC LVD)	DE_PS2410_160412_001ISS01

## General information

Access opening: height	72 mm	Access opening: width	67 mm
Areas of use	Process industry, Transportation, Marine engineering, Packaging industry, Harbour facilities, Machine construction	Enclosure attachment	
Flange plate	No	Impact resistance	Holes 4 mm 10 J version standard
Integral fixing	Threaded holes M4	Lid	Yes
Lid attachment	M4 torx stainless steel screws with slot	Material	Aluminium AlSi12
Material thickness of cover	2.5 mm	Material thickness of enclosure	4 mm
Max. payload	0.6 kg	Note: protection class	IP68 (t=72h, h=1m)
Number of lid screws	4	Operating temperature, max.	135 °C
Operating temperature, min.	-60 °C	Protection class (UL)	Type 4, Type 4X
Protection degree	IP66, IP67, IP68	Seal material	Silicone
Standards	EN 45545-2:2013	Surface finish	Powder-coated, textured
Torque for lid screws	2.5 Nm		

## horizontal assembly

WDU 2,5 / ZDU 2,5 / IDU 2,5	1x5	WDU 4 / ZDU 4	1x4
-----------------------------	-----	---------------	-----

## KLIPPON K11 VMQ RAL7001

Weidmüller Interface GmbH &amp; Co. KG

Klingenbergstraße 26

D-32758 Detmold

Germany

www.weidmueller.com

## Technical data

## vertical assembly

WDU 2,5 / ZDU 2,5 / IDU 2,5

1x1\*

WDU 4 / ZDU 4

1x1\*

## Classifications

ETIM 6.0

EC000261

ETIM 7.0

EC000261

ETIM 8.0

EC000261

ETIM 9.0

EC000261

ECLASS 9.0

27-18-01-01

ECLASS 9.1

27-18-92-90

ECLASS 10.0

27-18-01-01

ECLASS 11.0

27-18-01-01

ECLASS 12.0

27-18-01-01

ECLASS 13.0

27-18-01-01

## Environmental Product Compliance

REACH SVHC

Lead 7439-92-1

SCIP

9e4cab4e-239c-4e14-b9df-a0fee300d28a

## Approvals

Approvals



ROHS

Conform

UL File Number Search

UL Website

Certificate no. (cULus)

E197061

## Downloads

Approval/Certificate/Document of Conformity

[TAE00002SM](#)[EU Declaration of Conformity - Klippon K Empty Enclosures - DoC DE PS2410 160412 001ISS02](#)[DoM Klippon K salt water resistance](#)[DoM Klippon K EN 45545-2 2013 Railway](#)

Engineering Data

[CAD data – STEP](#)

Product Change Notification

[Technical change to Klippon K® enclosure series](#)[Technische Änderung für Klippon® K Gehäuse](#)[20240315-PCN-Klippon K Enclosure Instruction](#)

Tender specification

[Klippon K11 VMQ RAL7001\\_1937910000\\_DE](#)[Klippon K11 VMQ RAL7001\\_1937910000\\_EN](#)

User Documentation

[Assembly guidelines - empty enclosures](#)

Catalogues

[Catalogues in PDF-format](#)

Brochures

[MB KLIPPON ENCL.TECN EN](#)[FL RAILWAY 2014 EN](#)[FL RAILWAY 2014 EN](#)

## KLIPPON K11 VMQ RAL7001

**Weidmüller Interface GmbH & Co. KG**  
Klingenbergstraße 26  
D-32758 Detmold  
Germany

[www.weidmueller.com](http://www.weidmueller.com)

## Drawings

### Dimensioned drawing

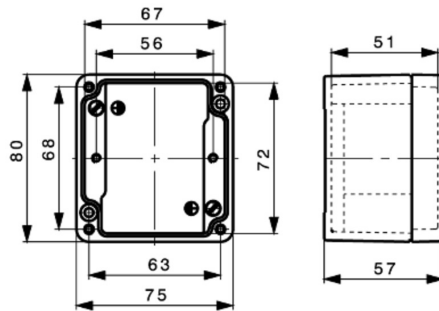

**KLIPPON K11 VMQ RAL7001****Weidmüller Interface GmbH & Co. KG**

Klingenbergstraße 26

D-32758 Detmold

Germany

[www.weidmueller.com](http://www.weidmueller.com)**Accessories****Klippon® K - Mounting plates**

The system accessories for the Klippon® K enclosure series allows you to easily adapt the enclosures to meet the specific requirements of every application.

- DIN Rails TS 35 and TS 15
- Mounting plates
- Hinges
- Wall-mounted holder

**General ordering data**

Type	MOPL K11 STAHL	Version
Order No.	<a href="#">3073000000</a>	Klippon K (aluminium empty enclosure), Mounting plate, Mounting
GTIN (EAN)	4008190857936	plate, Height: 67 mm, Width: 64 mm, Depth: 2 mm, Material: Sheet
Qty.	1 pc(s).	steel, galvanized, galvanized, silver

**Klippon® K - Hinge**

The system accessories for the Klippon® K enclosure series allows you to easily adapt the enclosures to meet the specific requirements of every application.

- DIN Rails TS 35 and TS 15
- Mounting plates
- Hinges
- Wall-mounted holder

**General ordering data**

Type	HG K+POK	Version
Order No.	<a href="#">1580360000</a>	Klippon POK (polyester empty enclosure), External joint, Hinge,
GTIN (EAN)	4008190203542	Material: Aluminium AlSi12, silver
Qty.	1 pc(s).	

## KLIPPON K11 VMQ RAL7001

**Weidmüller Interface GmbH & Co. KG**

Klingenbergstraße 26

D-32758 Detmold

Germany

[www.weidmueller.com](http://www.weidmueller.com)

## Accessories

### TS 15



The system accessories for the Klippon® K enclosure series allows you to easily adapt the enclosures to meet the specific requirements of every application.

- DIN Rails TS 35 and TS 15
- Mounting plates
- Hinges
- Wall-mounted holder

#### General ordering data

Type	TS15 64 KLIPPON K11	Version
Order No.	<a href="#">1909990000</a>	Rail, TS 15, Width: 64 mm, without slot, Steel, galvanized, chromium-plated
GTIN (EAN)	4032248536917	
Qty.	1 pc(s).	
Type	TS15X5 ST K11	Version
Order No.	<a href="#">8000003888</a>	Rail, TS 15, Width: 64 mm, without slot, Steel, galvanized, chromium-plated
GTIN (EAN)	4050118652390	
Qty.	20 pc(s).	

### Spacer



Stainless steel spacers in three lengths to increase the distance between the mounting rails or DIN rails and the rear wall of the enclosure.

#### General ordering data

Type	SP M6 30 MSZN	Version
Order No.	<a href="#">3896300000</a>	Klippon EB (Essential Box), Spacer, Height: 11.2 mm, Width: 10 mm, Depth: 30 mm, Material: Steel, silver
GTIN (EAN)	4008190850241	
Qty.	2 pc(s).	
Type	SP M6 15 MSZN	Version
Order No.	<a href="#">3896100000</a>	Klippon EB (Essential Box), Spacer, Height: 11.2 mm, Width: 10 mm, Depth: 15 mm, Material: Steel, silver
GTIN (EAN)	4008190857851	
Qty.	2 pc(s).	
Type	SP M6 20 MSZN	Version
Order No.	<a href="#">3896200000</a>	Klippon EB (Essential Box), Spacer, Height: 11.2 mm, Width: 10 mm, Depth: 20 mm, Material: Steel, silver
GTIN (EAN)	4008190850234	
Qty.	2 pc(s).	

**KLIPPON K11 VMQ RAL7001****Weidmüller Interface GmbH & Co. KG**

Klingenbergstraße 26

D-32758 Detmold

Germany

[www.weidmueller.com](http://www.weidmueller.com)**Accessories****Screws**

Depending on the terminal block or also accessories, we offer different types of screws as additional items or also spare parts.

**General ordering data**

Type	FKSC M4X6 D8/SW2	Version
Order No.	<a href="#">1567480000</a>	SAK Series, Allen hex screw, Screws, Number of poles: 1
GTIN (EAN)	4008190033491	
Qty.	100 pc(s).	

**Depth 7.5 mm**

The system accessories for the Klippon® K enclosure series allows you to easily adapt the enclosures to meet the specific requirements of every application.

- DIN Rails TS 35 and TS 15
- Mounting plates
- Hinges
- Wall-mounted holder

**General ordering data**

Type	TS35X7.5 ST K11	Version
Order No.	<a href="#">8000003899</a>	Rail, TS 35, TS 35 x 7.5, Width: 64 mm, without slot, Steel, galvanic
GTIN (EAN)	4050118652383	zinc plated and passivated
Qty.	20 pc(s).	

**KLIPPON K11 VMQ RAL7001****Weidmüller Interface GmbH & Co. KG**

Klingenbergstraße 26

D-32758 Detmold

Germany

[www.weidmueller.com](http://www.weidmueller.com)**Accessories****Depth 15 mm**

The system accessories for the Klippon® K enclosure series allows you to easily adapt the enclosures to meet the specific requirements of every application.

- DIN Rails TS 35 and TS 15
- Mounting plates
- Hinges
- Wall-mounted holder

**General ordering data**

Type	TS35X15 ST K11	Version
Order No.	<a href="#">8000073084</a>	Rail, TS 35, TS 35 x 15, Width: 64 mm, with slot, Steel, galvanic zinc
GTIN (EAN)	4064675336945	plated and passivated
Qty.	20 pc(s).	