

**KSI/1,5-2,5****Weidmüller Interface GmbH & Co. KG**

Klingenbergstraße 26

D-32758 Detmold

Germany

[www.weidmueller.com](http://www.weidmueller.com)**Insulated pin-cable connector made from PVC or PC/PA**

- Conventional designs
- Not soldered
- With conical entry funnel

**General ordering data**

Version	cable lug, terminal end, Insulated cable connector, 2.5 mm <sup>2</sup> , 1.5 mm <sup>2</sup> - 2.5 mm <sup>2</sup>
Order No.	<a href="#">1491410000</a>
Type	KSI/1,5-2,5
GTIN (EAN)	4050118301632
Qty.	100 pc(s).

**KSI/1,5-2,5****Weidmüller Interface GmbH & Co. KG**

Klingenbergstraße 26

D-32758 Detmold

Germany

[www.weidmueller.com](http://www.weidmueller.com)**Technical data****Dimensions and weights**

Net weight	0.98 g
------------	--------

**Connectors**

Conductor cross-section	2.5 mm <sup>2</sup>	Conductor cross-section, max.	2.5 mm <sup>2</sup>
Conductor cross-section, min.	1.5 mm <sup>2</sup>	Identification colour	blue
Inside diameter of collar (d4)	4.5 mm	Inside diameter of shaft (d1)	2.3 mm
Insulation	Available	Length 1 (l1)	27 mm
Length 2 (l2)	14 mm	Material/plastic	PC
Outside diameter of shaft (d3)	1.9 mm		

**Classifications**

ETIM 6.0	EC001059	ETIM 7.0	EC001059
ETIM 8.0	EC001059	ETIM 9.0	EC001059
ECLASS 9.0	27-40-02-92	ECLASS 9.1	27-40-02-12
ECLASS 10.0	27-40-02-92	ECLASS 11.0	27-40-02-92
ECLASS 12.0	27-40-02-92	ECLASS 13.0	27-40-02-92

**Approvals**

ROHS	Conform
------	---------

**Downloads**

Catalogues	<a href="#">Catalogues in PDF-format</a>
Brochures	

## KSI/1,5-2,5

**Weidmüller Interface GmbH & Co. KG**  
Klingenbergstraße 26  
D-32758 Detmold  
Germany

[www.weidmueller.com](http://www.weidmueller.com)

## Drawings

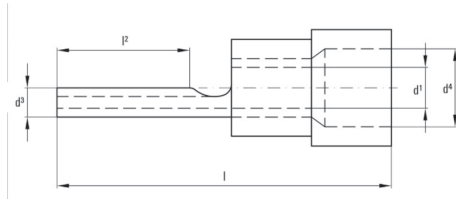

KSI/1,5-2,5

Weidmüller Interface GmbH &amp; Co. KG

Klingenbergstraße 26

D-32758 Detmold

Germany

[www.weidmueller.com](http://www.weidmueller.com)

## Accessories

## Crimping tools

**Crimping tools for insulated connectors**

cable lugs, terminal pins, parallel and serial connectors, plug-in connectors

- Ratchet guarantees precise crimping
- Release option in the event of incorrect operation
- With stop for exact positioning of the contacts.
- Tested to DIN EN 60352 part 2

## General ordering data

Type	CTI 6 G	Version
Order No.	<a href="#">9202850000</a>	Pressing tool, Tool for insulated cable connectors, 0.5mm <sup>2</sup> , 6mm <sup>2</sup> ,
GTIN (EAN)	4032248517855	Oval crimping, Parallel crimp
Qty.	1 pc(s).	
Type	HTI 15	Version
Order No.	<a href="#">9014400000</a>	Pressing tool, Tool for insulated cable connectors, 0.5mm <sup>2</sup> , 2.5mm <sup>2</sup> ,
GTIN (EAN)	4008190159412	Double crimp
Qty.	1 pc(s).	
Type	CTI 6	Version
Order No.	<a href="#">9006120000</a>	Pressing tool, Crimping tool for contacts, 0.5mm <sup>2</sup> , 6mm <sup>2</sup> , Oval
GTIN (EAN)	4008190044527	crimping, Double crimp
Qty.	1 pc(s).	