

KSI/1,5-2,5**Weidmüller Interface GmbH & Co. KG**

Klingenbergstraße 26

D-32758 Detmold

Germany

www.weidmueller.com**Insulated pin-cable connector made from PVC or PC/PA**

- Conventional designs
- Not soldered
- With conical entry funnel

General ordering data

| | |
|------------|---|
| Version | cable lug, terminal end, Insulated cable connector, 2.5 mm ² , 1.5 mm ² - 2.5 mm ² |
| Order No. | 1491390000 |
| Type | KSI/1,5-2,5 |
| GTIN (EAN) | 4050118301458 |
| Qty. | 100 pc(s). |

KSI/1,5-2,5**Weidmüller Interface GmbH & Co. KG**

Klingenbergstraße 26

D-32758 Detmold

Germany

www.weidmueller.com**Technical data****Dimensions and weights**

| | |
|------------|--------|
| Net weight | 0.89 g |
|------------|--------|

Connectors

| | | | |
|--------------------------------|---------------------|-------------------------------|---------------------|
| Conductor cross-section | 2.5 mm ² | Conductor cross-section, max. | 2.5 mm ² |
| Conductor cross-section, min. | 1.5 mm ² | Identification colour | blue |
| Inside diameter of collar (d4) | 4.5 mm | Inside diameter of shaft (d1) | 2.3 mm |
| Insulation | Available | Length 1 (l1) | 22.8 mm |
| Length 2 (l2) | 11 mm | Material/plastic | PC |
| Outside diameter of shaft (d3) | 1.9 mm | | |

Classifications

| | | | |
|-------------|-------------|-------------|-------------|
| ETIM 6.0 | EC001059 | ETIM 7.0 | EC001059 |
| ETIM 8.0 | EC001059 | ETIM 9.0 | EC001059 |
| ECLASS 9.0 | 27-40-02-92 | ECLASS 9.1 | 27-40-02-12 |
| ECLASS 10.0 | 27-40-02-92 | ECLASS 11.0 | 27-40-02-92 |
| ECLASS 12.0 | 27-40-02-92 | ECLASS 13.0 | 27-40-02-92 |

Approvals

| | |
|------|---------|
| ROHS | Conform |
|------|---------|

Downloads

| | |
|------------|--|
| Catalogues | Catalogues in PDF-format |
|------------|--|

KSI/1,5-2,5

Weidmüller Interface GmbH & Co. KG
Klingenbergstraße 26
D-32758 Detmold
Germany

www.weidmueller.com

Drawings

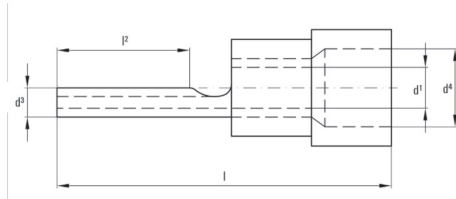

KSI/1,5-2,5**Weidmüller Interface GmbH & Co. KG**

Klingenbergstraße 26

D-32758 Detmold

Germany

www.weidmueller.com**Accessories****Crimping tools****Crimping tools for insulated connectors**

cable lugs, terminal pins, parallel and serial connectors, plug-in connectors

- Ratchet guarantees precise crimping
- Release option in the event of incorrect operation
- With stop for exact positioning of the contacts.
- Tested to DIN EN 60352 part 2

General ordering data

| | | |
|------------|----------------------------|---|
| Type | CTI 6 G | Version |
| Order No. | 9202850000 | Pressing tool, Tool for insulated cable connectors, 0.5mm ² , 6mm ² , |
| GTIN (EAN) | 4032248517855 | Oval crimping, Parallel crimp |
| Qty. | 1 pc(s). | |
| Type | HTI 15 | Version |
| Order No. | 9014400000 | Pressing tool, Tool for insulated cable connectors, 0.5mm ² , 2.5mm ² , |
| GTIN (EAN) | 4008190159412 | Double crimp |
| Qty. | 1 pc(s). | |
| Type | CTI 6 | Version |
| Order No. | 9006120000 | Pressing tool, Crimping tool for contacts, 0.5mm ² , 6mm ² , Oval |
| GTIN (EAN) | 4008190044527 | crimping, Double crimp |
| Qty. | 1 pc(s). | |