

**SAIE-M23S-S-EM-M20****Weidmüller Interface GmbH & Co. KG**

Klingenbergstraße 26

D-32758 Detmold

Germany

[www.weidmueller.com](http://www.weidmueller.com)**Similar to illustration**

The M23 round plug-in connectors offer a high number of mating cycles, high current-carrying capacity and high contact-density coupled with minimum dimensions. Enclosures, inserts and crimp contacts need to be ordered separately.

**General ordering data**

Version	Sensor/Actuator plug-in connector, Built-in plugs, Empty enclosure
Order No.	<a href="#">1373440000</a>
Type	SAIE-M23S-S-EM-M20
GTIN (EAN)	4050118175028
Qty.	1 pc(s).

**SAIE-M23S-S-EM-M20****Weidmüller Interface GmbH & Co. KG**

Klingenbergstraße 26

D-32758 Detmold

Germany

[www.weidmueller.com](http://www.weidmueller.com)**Technical data****Dimensions and weights**

Net weight	20 g
------------	------

**Technical data customisable plug-in connectors**

Housing main material	Copper-zinc alloy	Pollution severity	3
Protection degree	IP67, IP69K	Shield connection	Yes
Temperature range of housing	-40...+125 °C		

**Classifications**

ETIM 6.0	EC000437	ETIM 7.0	EC003556
ETIM 8.0	EC003556	ETIM 9.0	EC003556
ECLASS 9.1	27-44-02-02	ECLASS 10.0	27-44-02-24
ECLASS 11.0	27-44-02-24	ECLASS 12.0	27-44-02-24
ECLASS 13.0	27-44-02-24		

**Environmental Product Compliance**

REACH SVHC	Lead 7439-92-1
SCIP	1c533b66-fcff-4da5-b89f-fd55fbf5cb55

**Approvals**

ROHS	Conform
------	---------

**Downloads**

Catalogues	<a href="#">Catalogues in PDF-format</a>
Brochures	<a href="#">FL FIELDWIRING EN</a>

## SAIE-M23S-S-EM-M20

**Weidmüller Interface GmbH & Co. KG**  
Klingenbergstraße 26  
D-32758 Detmold  
Germany

[www.weidmueller.com](http://www.weidmueller.com)

## Drawings

### Dimensioned drawing

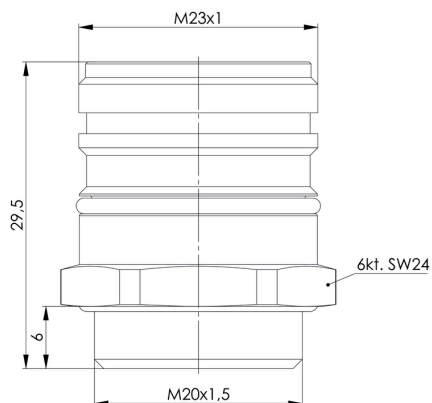

### Installation cut-out

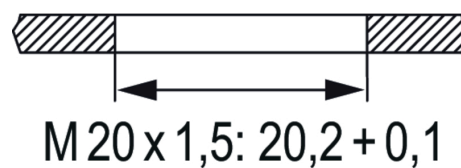

## Device connector, male

