

IE-C5ES8UG0015M40M40-G**Weidmüller Interface GmbH & Co. KG**

Klingenbergstraße 26

D-32758 Detmold

Germany

www.weidmueller.com

Assembled cables, patch cable Cabinet Line, Cat. 5, PUR, green

General ordering data

Version	System cable, RJ45 IP 20, RJ45 IP 20, Cat.5 (ISO/IEC 11801), PUR, 1.5 m
Order No.	1166000015
Type	IE-C5ES8UG0015M40M40-G
GTIN (EAN)	4032248956548
Qty.	1 pc(s).

IE-C5ES8UG0015M40M40-G

Weidmüller Interface GmbH & Co. KG

Klingenbergstraße 26

D-32758 Detmold

Germany

www.weidmueller.com

Technical data

Dimensions and weights

Length	1.5 m	Length (inches)	59.055 inch
Net weight	69 g		

Temperatures

Operating temperature	-40 °C...75 °C	Installation temperature	-10 °C...60 °C
-----------------------	----------------	--------------------------	----------------

Electrical properties

PoE / PoE+	conforming to IEEE 802.3at
------------	----------------------------

General standards

Certificate no. (cULus)	E316369	Connector standard	IEC 60603-7-51
-------------------------	---------	--------------------	----------------

Standards

Connector standard	IEC 60603-7-51
--------------------	----------------

Cable structure

Arrangement of wire cores		Colour sequence or wires - wire pairs	white/blue - blue, white/ orange - orange, white/ green - green, white/ brown - brown
	Twisted pair		
Complete shielding	Shielding braid made from copper wiring	Cross-section	4*2*AWG 26/7 - 4*2*0.128 mm ²
Insulation	PE	Insulation cross-section	0.98 mm
Material sheath	PUR	Number of wires	8
Sheath diameter, max.	6 mm	Sheath diameter, min.	5.6 mm
Sheathing colour	green	Shielding	SF/UTP
Strands	7	Wire material	Stranded tin-plated copper wire
Wire pair shielding	Aluminium foil		

Electrical properties of cable

Category	Cat.5 (ISO/IEC 11801)	Test voltage: wire-wire-shield	750 V DC, 1 min
Transmission rate	10/100 MBit/s, 1000 MBit/s		

Mechanical and material properties of cable

Abrasion resistance	very good	Halogen	halogen-free, according to IEC 60754-2
Min. bending radius, once only	5 x cable diameter	Min. bending radius, repetitive	10 x cable diameter
Resistance to oils	EN 50305	Resistance to spread of flame	in accordance with IEC 60332-1
Silicone-free	Yes	UV-resistant	Yes

Plug

Plug left	RJ45, IP20, male contact, straight, plug, Plastic, shielded	Plug right	RJ45, IP20, male contact, straight, plug, Plastic, shielded
-----------	---	------------	---

Creation date May 3, 2024 5:02:42 AM CEST

Catalogue status 20.04.2024 / We reserve the right to make technical changes.

IE-C5ES8UG0015M40M40-G

Weidmüller Interface GmbH & Co. KG

Klingenbergstraße 26

D-32758 Detmold

Germany

www.weidmueller.com

Technical data

Plug, left

Plug left	RJ45, IP20, male contact, straight, plug, Plastic, shielded
-----------	---

Plug, right

Plug right	RJ45, IP20, male contact, straight, plug, Plastic, shielded
------------	---

Classifications

ETIM 6.0	EC002599	ETIM 7.0	EC002599
ETIM 8.0	EC002599	ETIM 9.0	EC002599
ECLASS 9.0	27-06-03-08	ECLASS 9.1	27-06-03-08
ECLASS 10.0	27-06-03-08	ECLASS 11.0	27-06-03-08
ECLASS 12.0	27-06-03-08	ECLASS 13.0	27-06-03-08

Approvals

Approvals



ROHS	Conform
UL File Number Search	UL Website
Certificate no. (cULus)	E316369

Downloads

Engineering Data	CAD data – STEP
Product Change Notification	PCN-PB47-20180213-00-A_EN PCN-PB47-20180213-00-A_DE
User Documentation	MAN IE GUIDE DE MAN IE GUIDE EN
Catalogues	Catalogues in PDF-format
Brochures	FL FIELDWIRING EN PI PROFINET CABLING EN PI PROFINET CABLING EN

IE-C5ES8UG0015M40M40-G**Weidmüller Interface GmbH & Co. KG**

Klingenbergstraße 26

D-32758 Detmold

Germany

www.weidmueller.com**Drawings****Wiring**

RJ45	1	white, orange	1	RJ45
	2	orange	2	
	3	white, green	3	
	4	blue	4	
	5	white, blue	5	
	6	green	6	
	7	white, brown	7	
	8	brown	8	

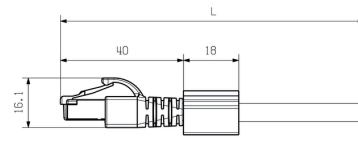
Dimensioned drawing

IE-C5ES8UG0015M40M40-G**Weidmüller Interface GmbH & Co. KG**

Klingenbergstraße 26

D-32758 Detmold

Germany

www.weidmueller.com**Accessories****Blank**

TM-I is an acknowledged and accredited marker type for traffic engineering applications. There are various different tag lengths available for individual labelling with long character strings. Easy handling of separation and installation thanks to the project marker field. Pre-attachment of sleeves and retrofitting of tags offer excellent versatility

The special contour of TM-I allows easy assembly and secures firm positioning. They are compatible with a number of commercially available sleeves. Thanks to the MultiCard format, the tags can be printed quickly and conveniently with the PrintJet CONNECT, plotter or the STI pen.

- Easy handling of separation and installation thanks to the project marker field.
- Acknowledged and accredited marker for traffic engineering applications
- Pre-attachment of sleeves and retrofitting of tags offer excellent versatility
- Not suited for labelling with P-Ink or STI pen in connection with CLI T sleeves

For custom printing: Please send us a file of our labeling software M-Print PRO or M-Print PRO Online (without installation) for your labeling specifications.

General ordering data

Type	TM-I 12 MC NE WS	Version
Order No.	1718411044	TM-I, Insert markers, 12 x 4 mm, white
GTIN (EAN)	4008190348977	
Qty.	320 pc(s).	

IE-C5ES8UG0015M40M40-G**Weidmüller Interface GmbH & Co. KG**

Klingenbergstraße 26

D-32758 Detmold

Germany

www.weidmueller.com**Accessories****Blank**

TM-I is an acknowledged and accredited marker type for traffic engineering applications. There are various different tag lengths available for individual labelling with long character strings. Easy handling of separation and installation thanks to the project marker field. Pre-attachment of sleeves and retrofitting of tags offer excellent versatility

The special contour of TM-I allows easy assembly and secures firm positioning. They are compatible with a number of commercially available sleeves. Thanks to the MultiCard format, the tags can be printed quickly and conveniently with the PrintJet CONNECT, plotter or the STI pen.

- Easy handling of separation and installation thanks to the project marker field.
- Acknowledged and accredited marker for traffic engineering applications
- Pre-attachment of sleeves and retrofitting of tags offer excellent versatility
- Not suited for labelling with P-Ink or STI pen in connection with CLI T sleeves

For custom printing: Please send us a file of our labeling software M-Print PRO or M-Print PRO Online (without installation) for your labeling specifications.

General ordering data

Type	TM-I 18 MC NE WS	Version
Order No.	1718431044	TM-I, Insert markers, 18 x 4 mm, white
GTIN (EAN)	4008190349011	
Qty.	320 pc(s).	