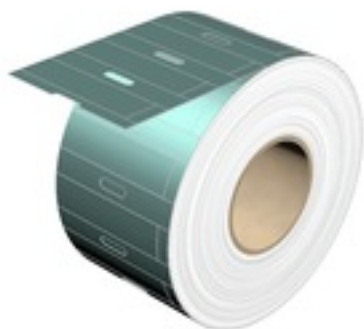

**THM ET S7 300-1 TU****Weidmüller Interface GmbH & Co. KG**

Klingenbergstraße 26

D-32758 Detmold

Germany

[www.weidmueller.com](http://www.weidmueller.com)

THM ET S7 non-adhesive, roll-packaged labels are used to label the SIMATIC ET 200S and S7-modules from Siemens.

The M-Print® PRO software can be used to individually print the THM ET S7 labels with a THM printer. Labels can be easily separated. The THM MultiMark printer ensures highly-resistant printing.

**General ordering data**

Version	THM, Device markers, 103 x 22.6 mm, Siemens, Turquoise
Order No.	<a href="#">1161750000</a>
Type	THM ET S7 300-1 TU
GTIN (EAN)	4032248950829
Qty.	1 pc(s).
compatible printer	<a href="#">2599430000</a> <a href="#">2599440000</a>

**THM ET S7 300-1 TU****Weidmüller Interface GmbH & Co. KG**

Klingenbergstraße 26

D-32758 Detmold

Germany

[www.weidmueller.com](http://www.weidmueller.com)**Technical data****Dimensions and weights**

Depth	0.08 mm	Depth (inches)	0.003 inch
Height	103 mm	Height (inches)	4.055 inch
Width	22.6 mm	Width (inches)	0.89 inch
Net weight	466 g		

**Temperatures**

Operating temperature range	-50...100 °C
-----------------------------	--------------

**General data**

Application/manufacturer	Siemens	
Approval acc. to UL 969	No	
Colour	Turquoise	
Halogen	No	
Material	Polypropylene	
Number of markers per combination	1 Label reel = Device markers	
Number of markers per packaging unit	Form of supply	Label reel
Number per roll	500	
Operating temperature range	-50...100 °C	
Operating temperature range, max.	100 °C	
Operating temperature range, min.	-50 °C	
Printing method	Thermal transfer	
UL 94 flammability rating	HB	
Version	halogen-free	
Width	22.6 mm	

**Device markers**

Halogen	No
---------	----

**Classifications**

ETIM 6.0	EC001288	ETIM 7.0	EC001288
ETIM 8.0	EC001288	ETIM 9.0	EC001288
ECLASS 9.0	27-40-06-29	ECLASS 9.1	27-40-06-29
ECLASS 10.0	27-40-06-29	ECLASS 11.0	27-28-11-04
ECLASS 12.0	27-28-11-04	ECLASS 13.0	27-28-11-04

**Approvals**

ROHS	Conform
------	---------

**Downloads**

Catalogues	<a href="#">Catalogues in PDF-format</a>
------------	--

**THM ET S7 300-1 TU**

**Weidmüller Interface GmbH & Co. KG**  
Klingenbergstraße 26  
D-32758 Detmold  
Germany

[www.weidmueller.com](http://www.weidmueller.com)

**Drawings**

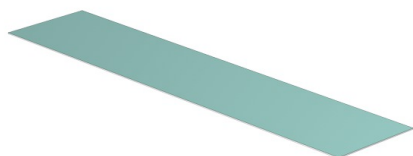

**THM ET S7 300-1 TU****Weidmüller Interface GmbH & Co. KG**

Klingenbergstraße 26

D-32758 Detmold

Germany

[www.weidmueller.com](http://www.weidmueller.com)**Accessories****Ink ribbons**

These printers produce excellent printing results thanks to the thermal transfer technique. Different materials and the user-friendly printing system under Windows optimise marking efforts.

**General ordering data**

Type	RIBBON MM 110/360 SW	Version
Order No.	<a href="#">2005070000</a>	Ink ribbon
GTIN (EAN)	4050118390049	
Qty.	1 pc(s).	