

**IE-C5ES8UG0020P41P41-E****Weidmüller Interface GmbH & Co. KG**

Klingenbergstraße 26

D-32758 Detmold

Germany

[www.weidmueller.com](http://www.weidmueller.com)

Assembled IE cables for EtherNet/IP applications with bayonet connector according to IEC 61076-3-106 var. 1, cat. 5, sheathed

**General ordering data**

Version	System cable, RJ45 IP 67 Baymo V01 plastic, RJ45 IP 67 Baymo V01 plastic, Cat.5 (ISO/IEC 11801) / Cat.5e (TIA T568-B), PUR, 2 m
Order No.	<a href="#">1106020000</a>
Type	IE-C5ES8UG0020P41P41-E
GTIN (EAN)	4032248881291
Qty.	1 pc(s).
Available until	2013-12-06

## IE-C5ES8UG0020P41P41-E

Weidmüller Interface GmbH &amp; Co. KG

Klingenbergstraße 26

D-32758 Detmold

Germany

www.weidmueller.com

## Technical data

## Dimensions and weights

Length	2 m	Length (inches)	78.74 inch
Net weight	144 g		

## Temperatures

Storage temperature	-40 °C...75 °C	Operating temperature	-40 °C...80 °C
Installation temperature	-10 °C...60 °C		

## Cable specific standards

Corrosiveness of fumes	to IEC 60754-2	Generic communication cable facilities	ISO / IEC 11801:2002, EN 50173-1:2007
Standard, assembly	UL-Style 20963 (80°C/30V)		

## General standards

Certificate no. (cULus)	E316369	Connector standard	IEC 61076-3-106 Var. 1, IEC 60603-7-51
-------------------------	---------	--------------------	--

## Standards

Connector standard	IEC 61076-3-106 Var. 1, IEC 60603-7-51	Corrosiveness of fumes	to IEC 60754-2
Generic communication cable facilities	ISO / IEC 11801:2002, EN 50173-1:2007	Standard, assembly	UL-Style 20963 (80°C/30V)

## Cable structure

Arrangement of wire cores	Twisted pair	Colour sequence or wires - wire pairs	white - blue, white - orange, white - green, white - brown
Complete shielding	Aluminium foil, Shielding braid made from copper wiring	Cross-section	4*2*AWG 26/7 - 4*2*0.128 mm <sup>2</sup>
Insulation	PE	Insulation cross-section	1 mm
Material sheath	PUR	Number of wires	8
Sheath diameter, max.	6.3 mm	Sheath diameter, min.	5.7 mm
Sheathing colour	green (RAL 6018)	Shielding	SF/UTP
Shielding braid thickness	0.1 mm	Standard designations	LI02YS(ST)C11Y 4x2x0.15-100 GN NC, SF/UTP
Strands	7	Wire material	Stranded tin-plated copper wire

## Electrical properties of cable

Capacity at 1 kHz	47 nF/km	Category	Cat.5 (ISO/IEC 11801) / Cat.5e (TIA T568-B)
Characteristic impedance	100 ± 5 Ω at 100MHz	Delay skew	25 ns/100m
Loop resistance	290 Ω/km	Signal propagation time	4.85 ns/m
Test voltage: wire-wire-shield	1000 V <sub>rms</sub> , 50 Hz, 1 min		

## IE-C5ES8UG0020P41P41-E

Weidmüller Interface GmbH &amp; Co. KG

Klingenbergstraße 26

D-32758 Detmold

Germany

www.weidmueller.com

## Technical data

## Mechanical and material properties of cable

Abrasion resistance	very good	Corrosiveness of fumes	to IEC 60754-2
Halogen	halogen-free, according to IEC 60754-2	Min. bending radius, once only	4 x cable diameter
Min. bending radius, repetitive	10 x cable diameter	Resistance to oils	in accordance with IEC 60811-2-1
Resistance to spread of flame	in accordance with IEC 60332-1	Silicone-free	Yes
UV-resistant	Yes		

## Plug, left

Plug left	RJ45, IP67, male contact, straight, V01 Baymo, plug, Plastic, shielded
-----------	--

## Plug, right

Plug right	RJ45, IP67, male contact, straight, V01 Baymo, plug, Plastic, shielded
------------	--

## Classifications

ETIM 6.0	EC002599	ETIM 7.0	EC002599
ETIM 8.0	EC002599	ETIM 9.0	EC002599
ECLASS 9.0	27-06-03-08	ECLASS 9.1	27-06-03-08
ECLASS 10.0	27-06-03-08	ECLASS 11.0	27-06-03-08
ECLASS 12.0	27-06-03-08	ECLASS 13.0	27-06-03-08

## Environmental Product Compliance

REACH SVHC	6,6'-di-tert-butyl-2,2'-methylenedi-p-cresol 119-47-1
SCIP	9ba9ceba-e039-40fa-9fdf-90f6be2d56d5

## Approvals

Approvals



ROHS	Conform
UL File Number Search	UL Website
Certificate no. (cULus)	E316369

## Downloads

Engineering Data	<a href="#">CAD data – STEP</a>
User Documentation	<a href="#">MAN IE GUIDE DE</a> <a href="#">MAN IE GUIDE EN</a>
Catalogues	<a href="#">Catalogues in PDF-format</a>
Brochures	<a href="#">FL FIELDWIRING EN</a> <a href="#">PI PROFINET CABLING EN</a> <a href="#">PI PROFINET CABLING EN</a>

## IE-C5ES8UG0020P41P41-E

**Weidmüller Interface GmbH & Co. KG**  
Klingenbergstraße 26  
D-32758 Detmold  
Germany

[www.weidmueller.com](http://www.weidmueller.com)

# Drawings

## Dimensioned drawing

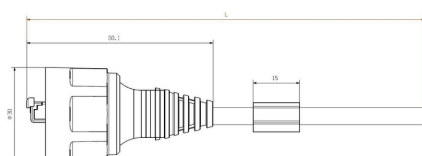

## Wiring

RJ45	1	white, orange	1	RJ45
	2	orange	2	
	3	white, green	3	
	4	blue	4	
	5	white, blue	5	
	6	green	6	
	7	white, brown	7	
	8	brown	8	

**IE-C5ES8UG0020P41P41-E****Weidmüller Interface GmbH & Co. KG**

Klingenbergstraße 26

D-32758 Detmold

Germany

[www.weidmueller.com](http://www.weidmueller.com)**Accessories****Blank**

TM-I is an acknowledged and accredited marker type for traffic engineering applications. There are various different tag lengths available for individual labelling with long character strings. Easy handling of separation and installation thanks to the project marker field. Pre-attachment of sleeves and retrofitting of tags offer excellent versatility

The special contour of TM-I allows easy assembly and secures firm positioning. They are compatible with a number of commercially available sleeves. Thanks to the MultiCard format, the tags can be printed quickly and conveniently with the PrintJet CONNECT, plotter or the STI pen.

- Easy handling of separation and installation thanks to the project marker field.
- Acknowledged and accredited marker for traffic engineering applications
- Pre-attachment of sleeves and retrofitting of tags offer excellent versatility
- Not suited for labelling with P-Ink or STI pen in connection with CLI T sleeves

**For custom printing:** Please send us a file of our labeling software M-Print PRO or M-Print PRO Online (without installation) for your labeling specifications.

**General ordering data**

Type	TM-I 18 MC NE WS	Version
Order No.	<a href="#">1718431044</a>	TM-I, Insert markers, 18 x 4 mm, white
GTIN (EAN)	4008190349011	
Qty.	320 pc(s).	

**IE-C5ES8UG0020P41P41-E****Weidmüller Interface GmbH & Co. KG**

Klingenbergstraße 26

D-32758 Detmold

Germany

[www.weidmueller.com](http://www.weidmueller.com)**Accessories****Blank**

TM-I is an acknowledged and accredited marker type for traffic engineering applications. There are various different tag lengths available for individual labelling with long character strings. Easy handling of separation and installation thanks to the project marker field. Pre-attachment of sleeves and retrofitting of tags offer excellent versatility

The special contour of TM-I allows easy assembly and secures firm positioning. They are compatible with a number of commercially available sleeves. Thanks to the MultiCard format, the tags can be printed quickly and conveniently with the PrintJet CONNECT, plotter or the STI pen.

- Easy handling of separation and installation thanks to the project marker field.
- Acknowledged and accredited marker for traffic engineering applications
- Pre-attachment of sleeves and retrofitting of tags offer excellent versatility
- Not suited for labelling with P-Ink or STI pen in connection with CLI T sleeves

**For custom printing:** Please send us a file of our labeling software M-Print PRO or M-Print PRO Online (without installation) for your labeling specifications.

**General ordering data**

Type	TM-I 12 MC NE WS	Version
Order No.	<a href="#">1718411044</a>	TM-I, Insert markers, 12 x 4 mm, white
GTIN (EAN)	4008190348977	
Qty.	320 pc(s).	