

IE-C5DB4RE0030MCSMCA-E**Weidmüller Interface GmbH & Co. KG**

Klingenbergstraße 26

D-32758 Detmold

Germany

www.weidmueller.com

Assembled IE cables, railway cable, Cat.5, black, M12

General ordering data

| | |
|------------|---|
| Version | System cable, M12 D-code – IP 67 straight pin, M12 D-code – IP 67 angled pin, Cat.5 (ISO/IEC 11801) / Cat.5e (TIA T568-B), Radox GKW S, 3 m |
| Order No. | 1059940030 |
| Type | IE-C5DB4RE0030MCSMCA-E |
| GTIN (EAN) | 4032248808687 |
| Qty. | 1 pc(s). |

Creation date April 29, 2024 9:05:11 PM CEST

Catalogue status 20.04.2024 / We reserve the right to make technical changes.

IE-C5DB4RE0030MCSMCA-E

Weidmüller Interface GmbH & Co. KG

Klingenbergstraße 26

D-32758 Detmold

Germany

www.weidmueller.com

Technical data

Dimensions and weights

| | | | |
|------------|-------|-----------------|-------------|
| Length | 3 m | Length (inches) | 118.11 inch |
| Net weight | 255 g | | |

Temperatures

| | | | |
|--------------------------|----------------|-----------------------|----------------|
| Storage temperature | -40 °C...90 °C | Operating temperature | -40 °C...90 °C |
| Installation temperature | -25 °C...90 °C | | |

Cable specific standards

| | | | |
|----------------------------------|--|---|--|
| Corrosiveness of fumes | to IEC 60754-2 | Fire protection in buses | According to ISO 6722-1 5.22 (UN ECE-R 118.01) |
| Fire safety for railway vehicles | According to DIN 5510-2 fire safety levels 1,2,3,4, According to BS 6853, According to EN50288-2-2, According to EN 45545, HL1 - HL3 | Flames propagate vertically on bundled cables | According to BS4066-3, DIN EN 50266-2-5, According to IEC 60332-3-25 D |
| Fluorine content | According to EN 60684-2 Section 45.2 | Hydrogen halide content | According to EN-50267-2-1, According to IEC 60754-1 |
| Impervious to smoke | According to BS 6853 Appendix D, in accordance with EN 50268-2, According to IEC 61034-2 | Multi-wire metallic data and control cable | According to EN50288-2-2 |
| Poisonous gases | According to BS 6853 Appendix B | | |

General standards

| | |
|--------------------|-----------------|
| Connector standard | IEC 61076-2-101 |
|--------------------|-----------------|

Standards

| | | | |
|----------------------------------|--|---|--|
| Connector standard | IEC 61076-2-101 | Corrosiveness of fumes | to IEC 60754-2 |
| Fire safety for railway vehicles | According to DIN 5510-2 fire safety levels 1,2,3,4, According to BS 6853, According to EN50288-2-2, According to EN 45545, HL1 - HL3 | Flames propagate vertically on bundled cables | According to BS4066-3, DIN EN 50266-2-5, According to IEC 60332-3-25 D |
| Fluorine content | According to EN 60684-2 Section 45.2 | Hydrogen halide content | According to EN-50267-2-1, According to IEC 60754-1 |
| Impervious to smoke | According to BS 6853 Appendix D, in accordance with EN 50268-2, According to IEC 61034-2 | Multi-wire metallic data and control cable | According to EN50288-2-2 |
| Poisonous gases | According to BS 6853 Appendix B | | |

Cable structure

| | | | |
|-----------------------|---|--------------------------|---------------|
| Cross-section | 2*2*AWG 22/7 - 2*2*0.36 mm ² | Insulation cross-section | 1.95 mm |
| Material sheath | Radox GKW S | Sheath diameter, max. | 7.55 mm |
| Sheath diameter, min. | 6.95 mm | Sheathing colour | black, SF/UTP |
| Shielding | SF/UTP | Strands | 7 |

Creation date April 29, 2024 9:05:11 PM CEST

Catalogue status 20.04.2024 / We reserve the right to make technical changes.

IE-C5DB4RE0030MCSMCA-E**Weidmüller Interface GmbH & Co. KG**

Klingenbergstraße 26

D-32758 Detmold

Germany

www.weidmueller.com

Technical data**Electrical properties of cable**

| | |
|----------|--|
| Category | Cat.5 (ISO/IEC 11801) / Cat.5e (TIA T568-B) |
|----------|--|

Mechanical and material properties of cable

| | | | |
|---------------------------------|---|------------------------|---|
| Abrasion resistance | very good | Corrosiveness of fumes | to IEC 60754-2 |
| Halogen | halogen-free, according to IEC 60754-2 | Impervious to smoke | According to BS 6853 Ap- pendix D, in accordance with EN 50268-2, Accord- ing to IEC 61034-2 |
| Min. bending radius, repetitive | 6 *diameter | Resistance to oils | in accordance with EN 50306-3 |
| Resistance to spread of flame | in accordance with IEC 60332-1-2 | | |

Plug, left

| | |
|-----------|---|
| Plug left | M12, D-coded, IP67, male contact, straight, plug, Plastic, shielded |
|-----------|---|

Plug, right

| | |
|------------|---|
| Plug right | M12, D-coded, IP67, male contact, angled 90°, plug, Plastic, shielded |
|------------|---|

Classifications

| | | | |
|-------------|-------------|-------------|-------------|
| ETIM 6.0 | EC002599 | ETIM 7.0 | EC002599 |
| ETIM 8.0 | EC002599 | ETIM 9.0 | EC002599 |
| ECLASS 9.0 | 27-06-03-08 | ECLASS 9.1 | 27-06-03-08 |
| ECLASS 10.0 | 27-06-03-08 | ECLASS 11.0 | 27-06-03-08 |
| ECLASS 12.0 | 27-06-03-08 | ECLASS 13.0 | 27-06-03-08 |

Environmental Product Compliance

| | |
|------------|--------------------------------------|
| REACH SVHC | Lead 7439-92-1 |
| SCIP | 67cf1078-beca-4687-860b-dc475a6ec24a |

Approvals

| | |
|------|---------|
| ROHS | Conform |
|------|---------|

Downloads

| | |
|--------------------|--|
| User Documentation | MAN IE GUIDE DE MAN IE GUIDE EN |
| Catalogues | Catalogues in PDF-format |
| Brochures | FL FIELDWIRING EN PI PROFINET CABLING EN FL FIELDWIRING EN PI PROFINET CABLING EN |

IE-C5DB4RE0030MCSMCA-E

Weidmüller Interface GmbH & Co. KG
Klingenbergstraße 26
D-32758 Detmold
Germany

www.weidmueller.com

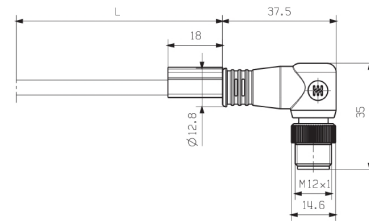
Drawings**Wiring diagram**

| M12 | | M12 |
|-----|--------|-----|
| 1 | yellow | 1 |
| 2 | white | 2 |
| 3 | orange | 3 |
| 4 | blue | 4 |

Detailed drawing

IE-C5DB4RE0030MCSMCA-E

Weidmüller Interface GmbH & Co. KG

Klingenbergstraße 26

D-32758 Detmold

Germany

www.weidmueller.com

Accessories

Screwty® cable gland tool with torque function



The ideal tool for any application

Screwty® is the ideal, all-purpose tool for tightening all common sensor and actuator cables. Even difficult-to-reach round plugs are accessible using the Screwty®. A simple turning movement tightens and loosens the connectors without the need for excessive force. The Screwty® is a unique and global solution since it fits with most cables and plugs from other vendors (over 90 %). The Screwty® consists of a handle with a conventional 1/4" adapter. Thus it can be used for all sizes: for M12 and M8 round plug-in connectors, and for M12F and M8F customisable plugs and sockets, as well as for all M23 plugs and sockets.

General ordering data

| Type | SCREWTY-M12-DM | Version | Packaging |
|------------|----------------------------|---|---------------|
| Order No. | 1900001000 | Cable gland tool for moulded M12 lines | Cardboard box |
| GTIN (EAN) | 4032248436408 | | |
| Qty. | 1 pc(s). | | |
| Type | SCREWTY SET -DM | Version | Packaging |
| Order No. | 1920000000 | Cable gland tool for M8, M12 lines and connectors | Cardboard box |
| GTIN (EAN) | 4032248436859 | | |
| Qty. | 1 pc(s). | | |

Screwty® cable gland tool



The ideal tool for any application

Screwty® is the ideal, all-purpose tool for tightening all common sensor and actuator cables. Even difficult-to-reach round plugs are accessible using the Screwty®. A simple turning movement tightens and loosens the connectors without the need for excessive force. The Screwty® is a unique and global solution since it fits with most cables and plugs from other vendors (over 90 %). The Screwty® consists of a handle with a conventional 1/4" adapter. Thus it can be used for all sizes: for M12 and M8 round plug-in connectors, and for M12F and M8F customisable plugs and sockets, as well as for all M23 plugs and sockets.

General ordering data

| Type | SCREWTY- M12 | Version | Packaging |
|------------|----------------------------|---|---------------|
| Order No. | 1900000000 | Cable gland tool for moulded M12 lines | Cardboard box |
| GTIN (EAN) | 4032248375868 | | |
| Qty. | 1 pc(s). | | |
| Type | SCREWTY SET | Version | Packaging |
| Order No. | 1910000000 | Cable gland tool for M8, M12 lines and connectors | Cardboard box |
| GTIN (EAN) | 4032248436842 | | |
| Qty. | 1 pc(s). | | |

IE-C5DB4RE0030MCSMCA-E**Weidmüller Interface GmbH & Co. KG**

Klingenbergstraße 26

D-32758 Detmold

Germany

www.weidmueller.com**Accessories****Blank**

TM-I is an acknowledged and accredited marker type for traffic engineering applications. There are various different tag lengths available for individual labelling with long character strings. Easy handling of separation and installation thanks to the project marker field. Pre-attachment of sleeves and retrofitting of tags offer excellent versatility

The special contour of TM-I allows easy assembly and secures firm positioning. They are compatible with a number of commercially available sleeves. Thanks to the MultiCard format, the tags can be printed quickly and conveniently with the PrintJet CONNECT, plotter or the STI pen.

- Easy handling of separation and installation thanks to the project marker field.
- Acknowledged and accredited marker for traffic engineering applications
- Pre-attachment of sleeves and retrofitting of tags offer excellent versatility
- Not suited for labelling with P-Ink or STI pen in connection with CLI T sleeves

For custom printing: Please send us a file of our labeling software M-Print PRO or M-Print PRO Online (without installation) for your labeling specifications.

General ordering data

| | | |
|------------|----------------------------|---|
| Type | TM-I 12 MC NE GE | Version |
| Order No. | 1718411687 | TM-I, Insert markers, 12 x 4 mm, yellow |
| GTIN (EAN) | 4008190348984 | |
| Qty. | 320 pc(s). | |

IE-C5DB4RE0030MCSMCA-E**Weidmüller Interface GmbH & Co. KG**

Klingenbergstraße 26

D-32758 Detmold

Germany

www.weidmueller.com**Accessories****Blank**

TM-I is an acknowledged and accredited marker type for traffic engineering applications. There are various different tag lengths available for individual labelling with long character strings. Easy handling of separation and installation thanks to the project marker field. Pre-attachment of sleeves and retrofitting of tags offer excellent versatility

The special contour of TM-I allows easy assembly and secures firm positioning. They are compatible with a number of commercially available sleeves. Thanks to the MultiCard format, the tags can be printed quickly and conveniently with the PrintJet CONNECT, plotter or the STI pen.

- Easy handling of separation and installation thanks to the project marker field.
- Acknowledged and accredited marker for traffic engineering applications
- Pre-attachment of sleeves and retrofitting of tags offer excellent versatility
- Not suited for labelling with P-Ink or STI pen in connection with CLI T sleeves

For custom printing: Please send us a file of our labeling software M-Print PRO or M-Print PRO Online (without installation) for your labeling specifications.

General ordering data

| | | |
|------------|----------------------------|---|
| Type | TM-I 18 MC NE GE | Version |
| Order No. | 1718431687 | TM-I, Insert markers, 18 x 4 mm, yellow |
| GTIN (EAN) | 4008190349028 | |
| Qty. | 320 pc(s). | |