

IE-XM-RJ45/IDC-IP67**Weidmüller Interface GmbH & Co. KG**

Klingenbergstraße 26

D-32758 Detmold

Germany

www.weidmueller.com

SnapIn plug-in connectors according to IEC 61076-3-106
ver.6 in plastic, with RJ45 insert

General ordering data

| | |
|------------|--|
| Version | Mounting flange, RJ45 module flange, straight, Cat.6A / Class EA (ISO/IEC 11801 2010), IP67 |
| Order No. | 8808440000 |
| Type | IE-XM-RJ45/IDC-IP67 |
| GTIN (EAN) | 4032248506026 |
| Qty. | 1 pc(s). |

IE-XM-RJ45/IDC-IP67

Weidmüller Interface GmbH & Co. KG

Klingenbergstraße 26

D-32758 Detmold

Germany

www.weidmueller.com

Technical data

Dimensions and weights

| | |
|------------|------|
| Net weight | 54 g |
|------------|------|

Temperatures

| | |
|-----------------------|----------------|
| Operating temperature | -40 °C...70 °C |
|-----------------------|----------------|

General data

| | | | |
|------------------------|--|-------------------|---|
| Connection 1 | RJ45 | Connection 2 | IDC |
| Description of article | | Configuration | Installation flange with mounting frame and RJ45 module with IDC connection captive lid |
| Wiring | RJ45 module flange, straight Colour-coded pin assignment according to EIA/TIA T568 A., EIA/TIA T568 B | Colour | Light Grey |
| Housing main material | PA 66, UL 94: V-0 | Category | Cat.6A / Class EA (ISO/IEC 11801 2010) |
| Contact surface | Gold over nickel | Type of mounting | Cabinet, Distribution box |
| Shielding | 360°; shield contact | Protection degree | IP67 |
| Plugging cycles | 750 | | |

Electrical properties

| | | | |
|--|----------------|---------------------------------------|----------------|
| Dielectric strength, contact / contact | ≥ 1000 V AC/DC | Dielectric strength, contact / shield | ≥ 1500 V AC/DC |
|--|----------------|---------------------------------------|----------------|

General standards

| | | | |
|-----------------------|------------|--------------------|---------------------------------------|
| Certificate No. (DNV) | TAE00003EW | Connector standard | IEC 61076-3-106 Var. 6, IEC 60603-7-5 |
|-----------------------|------------|--------------------|---------------------------------------|

Classifications

| | | | |
|-------------|-------------|-------------|-------------|
| ETIM 6.0 | EC001121 | ETIM 7.0 | EC001121 |
| ETIM 8.0 | EC001121 | ETIM 9.0 | EC001121 |
| ECLASS 9.0 | 27-44-03-90 | ECLASS 9.1 | 27-44-03-90 |
| ECLASS 10.0 | 27-44-03-90 | ECLASS 11.0 | 27-44-03-90 |
| ECLASS 12.0 | 27-44-03-90 | ECLASS 13.0 | 27-44-03-90 |

Approvals

Approvals



| | |
|------|---------|
| ROHS | Conform |
|------|---------|

IE-XM-RJ45/IDC-IP67

Weidmüller Interface GmbH & Co. KG
Klingenbergstraße 26
D-32758 Detmold
Germany

www.weidmueller.com

Technical data

Downloads

Approval/Certificate/Document of Con-
formity

[GOST Approval](#)

Engineering Data

[CAD data – STEP](#)

User Documentation

[MAN IE GUIDE DE](#)

[MAN IE GUIDE EN](#)

Catalogues

[Catalogues in PDF-format](#)

Brochures

[FL FIELDWIRING EN](#)

[PI PROFINET CABLING EN](#)

[PI PROFINET CABLING EN](#)

IE-XM-RJ45/IDC-IP67

Weidmüller Interface GmbH & Co. KG
Klingenbergstraße 26
D-32758 Detmold
Germany

www.weidmueller.com

Drawings

Dimensioned drawing

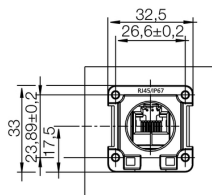

IE-XM-RJ45/IDC-IP67**Weidmüller Interface GmbH & Co. KG**

Klingenbergstraße 26

D-32758 Detmold

Germany

www.weidmueller.com**Accessories****RJ45 coupling / module**

IE plug-in connectors, IP20, for copper and fibre optic cables

General ordering data

| | | |
|------------|----------------------------|---|
| Type | IE-XRJ45/IDC | Version |
| Order No. | 8808330000 | Flange insert, Cat.6A / Class EA (ISO/IEC 11801 2010), IP20 |
| GTIN (EAN) | 4032248505913 | |
| Qty. | 1 pc(s). | |