

**IE-XM-RJ45/IDC****Weidmüller Interface GmbH & Co. KG**

Klingenbergstraße 26

D-32758 Detmold

Germany

[www.weidmueller.com](http://www.weidmueller.com)

Mounting rail outlet, RJ45 module design according to IEC 60603-7-51, for wires with diameters up to 1.6 mm

**General ordering data**

Version	Mounting rail outlet, RJ45, RJ45 module, IP20, Cat.6A / Class EA (ISO/IEC 11801 2010)
Order No.	<a href="#">8808360000</a>
Type	IE-XM-RJ45/IDC
GTIN (EAN)	4032248505944
Qty.	1 pc(s).

## IE-XM-RJ45/IDC

Weidmüller Interface GmbH &amp; Co. KG

Klingenbergstraße 26

D-32758 Detmold

Germany

www.weidmueller.com

## Technical data

## Dimensions and weights

Net weight	53 g
------------	------

## Temperatures

Operating temperature	-25 °C...70 °C
-----------------------	----------------

## General data

Connection 1	RJ45	Connection 2	IDC
Description of article		Configuration	1 TE pitch dimension acc. to DIN 43880. insta-compatible Installation flange with mounting frame
Wiring	RJ45 module EIA/TIA T568 A, EIA/TIA T568 B, PROFINET	Colour	Light Grey
Housing main material	PA 66, UL 94: V-0	Insulation cross-section, min.	0.7 mm
Insulation cross-section, max.	1.6 mm	Category	Cat.6A / Class EA (ISO/IEC 11801 2010)
Connection diameter, solid	0.4...0.64 mm	Conductor connection cross-section, solid (AWG)	AWG 24...AWG 22
Connection diameter, flexible	0.48...0.64 mm	Conductor connection cross-section, flexible (AWG)	AWG 26...AWG 22
Sheath diameter, min.	5.5 mm	Sheath diameter, max.	10 mm
Type of mounting	TS 35	Shielding	Yes
Protection degree	IP20	Plugging cycles	750 (RJ45)

## Electrical properties

Contact resistance	$\leq 20 \text{ m}\Omega$	Current-carrying capacity at 50 °C	1 A
Dielectric strength, contact / contact	$\geq 1000 \text{ V AC/DC}$	Dielectric strength, contact / shield	$\geq 1500 \text{ V AC/DC}$
Insulation strength	500 M $\Omega$	PoE / PoE+	conforming to IEEE 802.3at

## General standards

Certificate No. (DNV)	TAE00003EW	Certificate no. (cULus)	E316369
Connector standard	IEC 60603-7-5		

## Classifications

ETIM 6.0	EC000313	ETIM 7.0	EC000313
ETIM 8.0	EC000313	ETIM 9.0	EC000313
ECLASS 9.0	27-44-03-20	ECLASS 9.1	19-17-01-25
ECLASS 10.0	27-44-03-20	ECLASS 11.0	27-44-03-20
ECLASS 12.0	27-44-03-20	ECLASS 13.0	27-44-03-20

**IE-XM-RJ45/IDC****Weidmüller Interface GmbH & Co. KG**

Klingenbergstraße 26

D-32758 Detmold

Germany

[www.weidmueller.com](http://www.weidmueller.com)**Technical data****Approvals**

Approvals



ROHS	Conform
UL File Number Search	UL Website
Certificate no. (cULus)	E316369

**Downloads**

Approval/Certificate/Document of Conformity	<a href="#">GOST Approval</a> <a href="#">DUXR.E316369</a>
Engineering Data	<a href="#">CAD data – STEP</a>
Engineering Data	<a href="#">Zuken E3.S</a>
User Documentation	<a href="#">MAN IE GUIDE DE</a> <a href="#">MAN IE GUIDE EN</a> <a href="#">Manual</a>
Catalogues	<a href="#">Catalogues in PDF-format</a>
Brochures	<a href="#">FL FIELDWIRING EN</a> <a href="#">PI PROFINET CABLING EN</a> <a href="#">PI PROFINET CABLING EN</a>

## IE-XM-RJ45/IDC

**Weidmüller Interface GmbH & Co. KG**  
Klingenbergstraße 26  
D-32758 Detmold  
Germany

[www.weidmueller.com](http://www.weidmueller.com)

## Drawings

### Dimensioned drawing

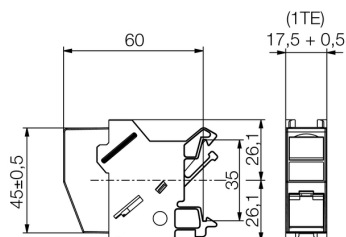

### Product image



## IE-XM-RJ45/IDC

**Weidmüller Interface GmbH & Co. KG**  
Klingenbergstraße 26  
D-32758 Detmold  
Germany

[www.weidmueller.com](http://www.weidmueller.com)

## Accessories

### Outlet marker



Markers for the labelling panel of terminal rail outlets from Weidmüller.

The benefits for you:

- white
- blank
- on labelling sheet

### General ordering data

Type	IE-DM
Order No.	<a href="#">8813500000</a>
GTIN (EAN)	4032248513345
Qty.	50 pc(s).