

IE-XM-ST/ST**Weidmüller Interface GmbH & Co. KG**

Klingenbergstraße 26

D-32758 Detmold

Germany

www.weidmueller.com

Mounting rail outlet, ST junction design according to IEC
61754-2

General ordering data

| | |
|------------|--|
| Version | Mounting rail outlet, fibre-optic, ST-ST coupler, IP20 |
| Order No. | 8808340000 |
| Type | IE-XM-ST/ST |
| GTIN (EAN) | 4032248505920 |
| Qty. | 1 pc(s). |

IE-XM-ST/ST**Weidmüller Interface GmbH & Co. KG**

Klingenbergstraße 26

D-32758 Detmold

Germany

www.weidmueller.com**Technical data****Dimensions and weights**

| | |
|------------|------|
| Net weight | 27 g |
|------------|------|

Temperatures

| | |
|-----------------------|----------------|
| Operating temperature | -25 °C...70 °C |
|-----------------------|----------------|

General data

| | | | |
|------------------------|---------------|-----------------------|--|
| Colour | | Configuration | 1 TE pitch dimension acc. to DIN 43880. insta-compatible |
| | Light Grey | | Installation flange with mounting frame |
| Connection 1 | ST | Connection 2 | ST |
| Description of article | ST-ST coupler | Housing main material | PA 66, UL 94: V-0 |
| Insertion loss | <0.15 dB | Plugging cycles | 750 |
| Protection degree | IP20 | Type of mounting | TS 35 |

General standards

| | |
|--------------------|-------------|
| Connector standard | IEC 61754-2 |
|--------------------|-------------|

Classifications

| | | | |
|-------------|-------------|-------------|-------------|
| ETIM 6.0 | EC000313 | ETIM 7.0 | EC000313 |
| ETIM 8.0 | EC000313 | ETIM 9.0 | EC000313 |
| ECLASS 9.0 | 27-44-03-20 | ECLASS 9.1 | 19-17-01-25 |
| ECLASS 10.0 | 27-44-03-20 | ECLASS 11.0 | 27-44-03-20 |
| ECLASS 12.0 | 27-44-03-20 | ECLASS 13.0 | 27-44-03-20 |

Environmental Product Compliance

| | |
|------------|--------------------------------------|
| REACH SVHC | Lead 7439-92-1 |
| SCIP | 67cf1078-beca-4687-860b-dc475a6ec24a |

Approvals

| | |
|------|---------|
| ROHS | Conform |
|------|---------|

Downloads

| | |
|---|---|
| Approval/Certificate/Document of Conformity | GOST Approval |
| Engineering Data | CAD data – STEP |
| Engineering Data | Zuken E3.S |
| User Documentation | MAN IE GUIDE DE MAN IE GUIDE EN |
| Catalogues | Catalogues in PDF-format |
| Brochures | FL FIELDWIRING EN PI PROFINET CABLING EN PI PROFINET CABLING EN |

IE-XM-ST/ST

Weidmüller Interface GmbH & Co. KG
Klingenbergstraße 26
D-32758 Detmold
Germany

www.weidmueller.com

Drawings

Dimensioned drawing

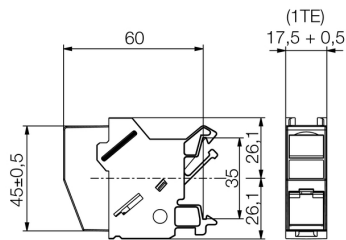

IE-XM-ST/ST

Weidmüller Interface GmbH & Co. KG

Klingenbergstraße 26

D-32758 Detmold

Germany

www.weidmueller.com

Accessories

Outlet marker



Markers for the labelling panel of terminal rail outlets from Weidmüller.

The benefits for you:

- white
- blank
- on labelling sheet

General ordering data

| | |
|------------|----------------------------|
| Type | IE-DM |
| Order No. | 8813500000 |
| GTIN (EAN) | 4032248513345 |
| Qty. | 50 pc(s). |