

## IE-XRJ45/IDC

**Weidmüller Interface GmbH & Co. KG**

Klingenbergstraße 26

D-32758 Detmold

Germany

[www.weidmueller.com](http://www.weidmueller.com)



IE plug-in connectors, IP20, for copper and fibre optic cables

### General ordering data

Version	Flange insert, Cat.6A / Class EA (ISO/IEC 11801 2010), IP20
Order No.	<a href="#">8808330000</a>
Type	IE-XRJ45/IDC
GTIN (EAN)	4032248505913
Qty.	1 pc(s).

## IE-XRJ45/IDC

Weidmüller Interface GmbH &amp; Co. KG

Klingenbergstraße 26

D-32758 Detmold

Germany

www.weidmueller.com

## Technical data

## Dimensions and weights

Height	23.4 mm	Height (inches)	0.921 inch
Width	14.7 mm	Width (inches)	0.579 inch
Length	43.8 mm	Length (inches)	1.724 inch
Wall thickness, min.	1.45 mm	Wall thickness, max.	1.55 mm
Net weight	29 g		

## Temperatures

Operating temperature	-40 °C...70 °C
-----------------------	----------------

## General data

Connection 1	RJ45	Connection 2	IDC
Wiring	TIA-568A, TIA-568B, PROFINET	Housing main material	Zinc diecast
Insulation cross-section, max.	1.8 mm	Category	Cat.6A / Class EA (ISO/IEC 11801 2010)
Contact surface	Gold over nickel	Connection diameter, solid	0.41...0.64 mm
Conductor connection cross-section, solid (AWG)	AWG 26...AWG 22	Conductor connection cross-section, solid	0.13...0.32 mm <sup>2</sup>
Connection diameter, flexible	0.48...0.76 mm	Conductor connection cross-section, flexible (AWG)	AWG 26...AWG 22
Wire connection cross section, finely stranded, min.	0.141 mm <sup>2</sup>	Conductor connection cross-section, flexible	0.14...0.35 mm <sup>2</sup>
Shielding	360°; shield contact	Protection degree	IP20
Insertion force	20 N	Plugging cycles	750

## Electrical properties

Contact resistance	≤ 20 mΩ	Dielectric strength, contact / contact	≥ 1000 V DC
Insulation strength	500 MΩ	PoE / PoE+	conforming to IEEE 802.3at

## General standards

Certificate No. (DNV)	TAE00003EW	Connector standard	IEC 60603-7-51
-----------------------	------------	--------------------	----------------

## Classifications

ETIM 6.0	EC001121	ETIM 7.0	EC001121
ETIM 8.0	EC001121	ETIM 9.0	EC001121
ECLASS 9.0	27-44-03-90	ECLASS 9.1	27-44-03-90
ECLASS 10.0	27-44-03-90	ECLASS 11.0	27-44-03-90
ECLASS 12.0	27-44-03-90	ECLASS 13.0	27-44-03-90

## Environmental Product Compliance

REACH SVHC	/
------------	---

## IE-XRJ45/IDC

Weidmüller Interface GmbH &amp; Co. KG

Klingenbergstraße 26

D-32758 Detmold

Germany

[www.weidmueller.com](http://www.weidmueller.com)

## Technical data

## Approvals

Approvals



ROHS

Conform

## Downloads

Engineering Data	<a href="#">CAD data – STEP</a>
User Documentation	<a href="#">MAN IE GUIDE DE</a> <a href="#">MAN IE GUIDE EN</a>
Catalogues	<a href="#">Catalogues in PDF-format</a>
Brochures	<a href="#">FL FIELDWIRING EN</a> <a href="#">PI PROFINET CABLING EN</a> <a href="#">PI PROFINET CABLING EN</a>

## IE-XRJ45/IDC

**Weidmüller Interface GmbH & Co. KG**  
Klingenbergstraße 26  
D-32758 Detmold  
Germany

[www.weidmueller.com](http://www.weidmueller.com)

## Drawings

### Dimensioned drawing

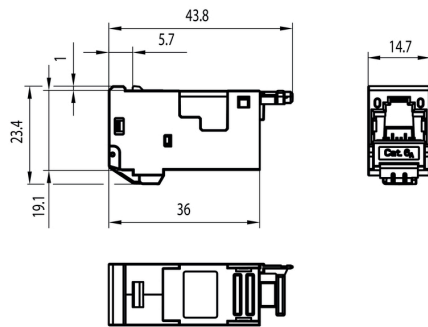

### Installation cut-out

