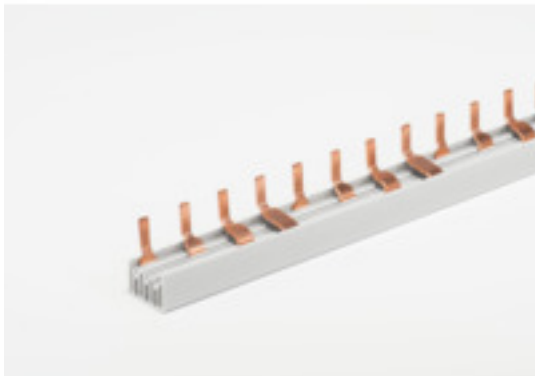

S-4L-140/16**Weidmüller Interface GmbH & Co. KG**

Klingenbergstraße 26

D-32758 Detmold

Germany

www.weidmueller.com**Product image**

4-pole pin-type phase distribution bars are used for potential distribution to other components in the control cabinet such as circuit breakers, residual current circuit breakers and other installation devices.

General ordering data

| | |
|------------|---|
| Version | Cross-connector (terminal), Number of poles: 8, Pitch in mm (P): 17.80, 80 A, grey |
| Order No. | 2658840000 |
| Type | S-4L-140/16 |
| GTIN (EAN) | 4050118671681 |
| Qty. | 20 pc(s). |

S-4L-140/16**Weidmüller Interface GmbH & Co. KG**

Klingenbergstraße 26

D-32758 Detmold

Germany

www.weidmueller.com**Technical data****Dimensions and weights**

| | | | |
|------------|---------|-----------------|------------|
| Depth | 20.2 mm | Depth (inches) | 0.795 inch |
| Height | 27.5 mm | Height (inches) | 1.083 inch |
| Width | 140 mm | Width (inches) | 5.512 inch |
| Net weight | 20.75 g | | |

Material data

| | |
|--------|------|
| Colour | grey |
|--------|------|

Dimensions

| | |
|-----------------|---------|
| Pitch in mm (P) | 17.8 mm |
|-----------------|---------|

General

| | |
|-----------------|---|
| Number of poles | 8 |
|-----------------|---|

Rating data

| | | | |
|---------------------|--------------------|---------------|------|
| Rated cross-section | 16 mm ² | Rated current | 80 A |
|---------------------|--------------------|---------------|------|

Classifications

| | | | |
|-------------|-------------|-------------|-------------|
| ETIM 6.0 | EC000489 | ETIM 7.0 | EC000489 |
| ETIM 8.0 | EC000489 | ETIM 9.0 | EC000489 |
| ECLASS 9.0 | 27-14-11-40 | ECLASS 9.1 | 27-14-11-40 |
| ECLASS 10.0 | 27-14-11-40 | ECLASS 11.0 | 27-14-11-40 |
| ECLASS 12.0 | 27-14-11-40 | ECLASS 13.0 | 27-25-03-03 |

Approvals

Approvals



| | |
|------|---------|
| ROHS | Conform |
|------|---------|

Downloads

| | |
|---|--|
| Approval/Certificate/Document of Conformity | CE Declaration of Conformity |
| Engineering Data | CAD data – STEP |
| Catalogues | Catalogues in PDF-format |

S-4L-140/16

Weidmüller Interface GmbH & Co. KG
Klingenbergstraße 26
D-32758 Detmold
Germany

www.weidmueller.com

Drawings

Drawing

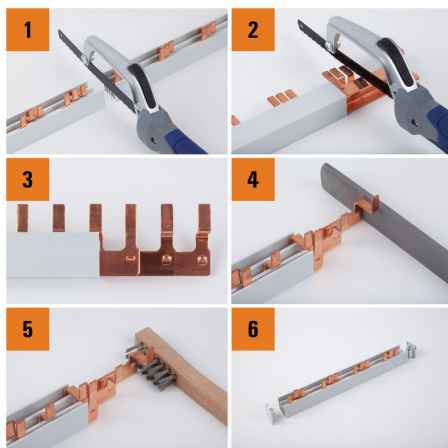
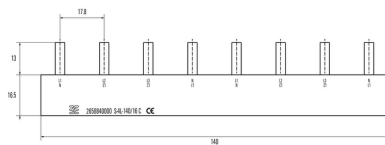

S-4L-140/16

Weidmüller Interface GmbH & Co. KG

Klingenbergstraße 26

D-32758 Detmold

Germany

www.weidmueller.com

Accessories

End caps and covers



End caps and covers ensure the required creepage distances in the system even after the bus bars have been cut to length or in the case of free-standing contacts, and guarantee finger safety in accordance with DIN EN 50274.

General ordering data

| | | |
|------------|----------------------------|------------------------|
| Type | END CAP G+S 4L/16 | Version |
| Order No. | 2659030000 | Terminal cover, grey |
| GTIN (EAN) | 4050118671506 | |
| Qty. | 10 pc(s). | |
| Type | PROTECTION COVER G+S /5 | Version |
| Order No. | 2659040000 | Terminal cover, yellow |
| GTIN (EAN) | 4050118671490 | |
| Qty. | 10 pc(s). | |

Feed in terminals



Our feed-in modules facilitate handling when feeding the system. For example, the bending radius of the cable can be reduced by using a feed-in module with side entry.

General ordering data

| | | |
|------------|----------------------------|---|
| Type | FIT 25 GN | Version |
| Order No. | 2659050000 | Auxiliary connection (terminal), 25 mm ² |
| GTIN (EAN) | 4050118671483 | |
| Qty. | 10 pc(s). | |
| Type | FIT 25 SN | Version |
| Order No. | 2659060000 | Auxiliary connection (terminal), 25 mm ² |
| GTIN (EAN) | 4050118671476 | |
| Qty. | 10 pc(s). | |
| Type | FIT 50 SN | Version |
| Order No. | 2659080000 | Auxiliary connection (terminal), 50 mm ² |
| GTIN (EAN) | 4050118671452 | |
| Qty. | 3 pc(s). | |
| Type | FIT 50 SN/F | Version |
| Order No. | 2659100000 | Auxiliary connection (terminal), 50 mm ² |
| GTIN (EAN) | 4050118671438 | |
| Qty. | 3 pc(s). | |

S-4L-140/16**Weidmüller Interface GmbH & Co. KG**

Klingenbergstraße 26

D-32758 Detmold

Germany

www.weidmueller.com**Accessories**

| | | |
|------------|----------------------------|---|
| Type | FIT 50 GN | Version |
| Order No. | 2659070000 | Auxiliary connection (terminal), 50 mm ² |
| GTIN (EAN) | 4050118671469 | |
| Qty. | 3 pc(s). | |
| Type | FIT 50 GN/F | Version |
| Order No. | 2659090000 | Auxiliary connection (terminal), 50 mm ² |
| GTIN (EAN) | 4050118671445 | |
| Qty. | 3 pc(s). | |