

**SAIL-M12GM12G-CD-2.0TV****Weidmüller Interface GmbH & Co. KG**

Klingenbergstraße 26

D-32758 Detmold

Germany

[www.weidmueller.com](http://www.weidmueller.com)**Similar to illustration**

The most reliable way of achieving connections between two I/O slaves or between the control and one I/O subscriber is by way of pre-assembled cables. The line of cables covers PROFIBUS, CANopen, DeviceNet™, EtherCAT and Ethernet.

**General ordering data**

Version	Bus line, Connecting line, M12 / M12, Number of poles: 5, 2 m, Male pin, straight - Female socket, straight, Shielded: Yes, LED: No, Sheath material: PUR, Halogen: No
Order No.	<a href="#">2493720200</a>
Type	SAIL-M12GM12G-CD-2.0TV
GTIN (EAN)	4050118627923
Qty.	1 pc(s).

**SAIL-M12GM12G-CD-2.0TV****Weidmüller Interface GmbH & Co. KG**

Klingenbergstraße 26

D-32758 Detmold

Germany

www.weidmueller.com

**Technical data****Dimensions and weights**

Net weight	100 g
------------	-------

**Technical specifications for cable**

Cable length	2 m	Colour coding	white, blue, red, black
Configurable cable length	No	Halogen	No
Insulation	TPE	Number of poles	5
Resistance to oils	in accordance with IEC 60811:404	Resistant to welding beads	Yes
Sheath material	PUR	Sheathing colour	violet
Shielded	Yes	Suitable for cable carriers	Yes
Temperature range, moving	-25...80 °C	Temperature range, stationary	-40...80 °C
Torsion resistance	360 °/m	Wire cross section (Print/Online)	2 x 0,67 mm <sup>2</sup> + 2 x 0,38 mm <sup>2</sup>

**General technical data**

Coding	A-coded	Connection thread	M12 / M12
Contact surface	Gold-plated	Housing main material	PUR
LED	No	Pollution severity	3
Protection degree	IP67, when screwed in	Rated voltage	30 V
Temperature range of housing	-25...+80 °C	Threaded ring material	Brass, nickel-plated
Version	Male pin, straight - Female socket, straight	jumpered	No

**Electrical properties**

Rated voltage	30 V
---------------	------

**General standards**

Connector standard	IEC 61076-2-101
--------------------	-----------------

**Plug, left**

Plug left	M12, A-coded, IP67, male contact, straight, Plastic, shielded
-----------	---

**Plug, right**

Plug right	M12, A-coded, IP67, female contact, straight, Plastic, shielded
------------	---

**Classifications**

ETIM 6.0	EC001855	ETIM 7.0	EC001855
ETIM 8.0	EC001855	ETIM 9.0	EC001855
ECLASS 9.0	27-06-03-11	ECLASS 9.1	27-06-03-11
ECLASS 10.0	27-06-03-11	ECLASS 11.0	27-06-03-11
ECLASS 12.0	27-06-03-11	ECLASS 13.0	27-06-03-11

**SAIL-M12GM12G-CD-2.0TV****Weidmüller Interface GmbH & Co. KG**

Klingenbergstraße 26

D-32758 Detmold

Germany

[www.weidmueller.com](http://www.weidmueller.com)**Technical data****Environmental Product Compliance**

REACH SVHC	Lead 7439-92-1
SCIP	1c533b66-fcff-4da5-b89f-fd55fbf5cb55

**Approvals**

Approvals



ROHS	Conform
------	---------

**Downloads**

Catalogues	<a href="#">Catalogues in PDF-format</a>
------------	--

## SAIL-M12GM12G-CD-2.0TV

**Weidmüller Interface GmbH & Co. KG**  
Klingenbergstraße 26  
D-32758 Detmold  
Germany

[www.weidmueller.com](http://www.weidmueller.com)

## Drawings

### Dimensioned drawing

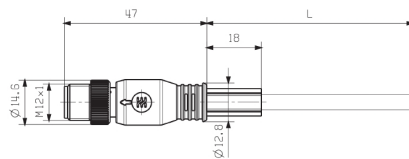

### Dimensioned drawing

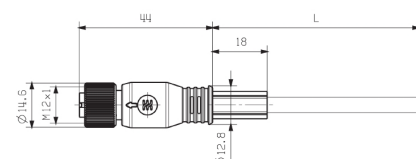

### Pole scheme

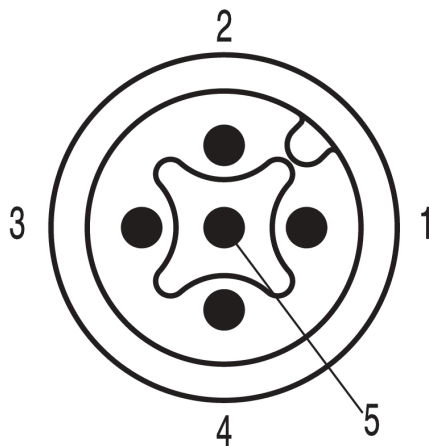

### Pole scheme

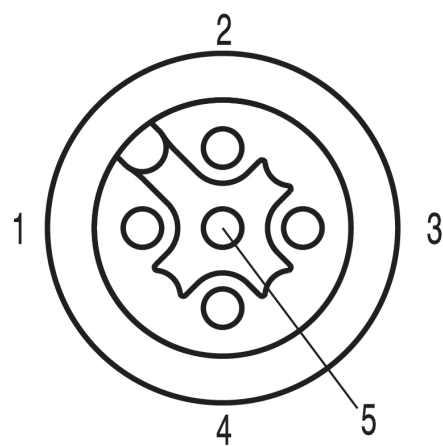

### Wiring diagram

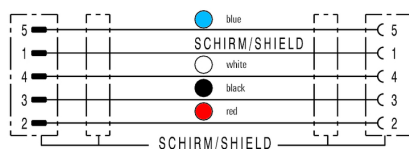

### The ideal tool: Screwty® with torque function

