

CMA-31-200-5A-2,5VA-0,5**Weidmüller Interface GmbH & Co. KG**

Klingenbergstraße 26

D-32758 Detmold

Germany

www.weidmueller.com

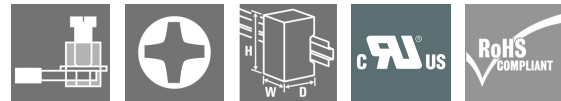
**Plug-on current transformers**

Plug-on current transformers are especially suitable for mounting on the busbar.

The advantages of this type are: Price optimisation, safe connection option, high mechanical holding forces and high current resistance.

General ordering data

Version	Primary current: 200 A, Secondary current max.: 5 A, Load: 2.5 VA, Tolerance class: 0,5, closed current transformer
Order No.	2421020000
Type	CMA-31-200-5A-2,5VA-0,5
GTIN (EAN)	4050118428988
Qty.	1 pc(s).
Manufacturer	MBS AG

CMA-31-200-5A-2,5VA-0,5**Weidmüller Interface GmbH & Co. KG**

Klingenbergstraße 26

D-32758 Detmold

Germany

www.weidmueller.com

Technical data**Dimensions and weights**

Depth	52 mm	Depth (inches)	2.047 inch
Height	80.9 mm	Height (inches)	3.185 inch
Width	60 mm	Width (inches)	2.362 inch
Net weight	307 g		

Temperatures

Storage temperature	-25 °C...70 °C	Operating temperature	-5 °C...50 °C
---------------------	----------------	-----------------------	---------------

Dimensions of live conductors

Type of conductor	Insulated conductor only	Round conductor	25.7 mm
Rail	20 x 20 mm, 25 x 12 mm, 30 x 10 mm	Installation location	Indoor use

Electrical attributes

Load	2.5 VA	Primary current	200 A
Secondary current	0...5 A	Tolerance class	0,5

Technical properties

Insulation class	E	Nominal frequency	50 Hz
Protection degree	IP20	Thermal rated continuous current $I_{\text{thermal}} 1.2 \times I_{\text{rated}}$	

Insulation coordination

Standard	IEC 61869-1: 2007, IEC 61869-2: 2012	Tolerance class	0,5
----------	---	-----------------	-----

Classifications

ETIM 6.0	EC002048	ETIM 7.0	EC002048
ETIM 8.0	EC002048	ETIM 9.0	EC002048
ECLASS 9.0	27-21-09-02	ECLASS 9.1	27-21-09-02
ECLASS 10.0	27-21-09-02	ECLASS 11.0	27-21-09-02
ECLASS 12.0	27-21-09-02	ECLASS 13.0	27-21-09-02
ECLASS 14.0	27-21-09-02		

Environmental Product Compliance

REACH SVHC	/
RoHS Compliance Status	Compliant

Approvals

ROHS	Conform
------	---------

CMA-31-200-5A-2,5VA-0,5**Weidmüller Interface GmbH & Co. KG**

Klingenbergstraße 26

D-32758 Detmold

Germany

www.weidmueller.com

Technical data

Downloads

Approval/Certificate/Document of Conformity	UL- certificate UKCA Declaration of Conformity Declaration of Conformity
User Documentation	Device description – instruction sheet english.pdf Device description – Betriebsanleitung deutsch
Catalogues	Catalogues in PDF-format

CMA-31-200-5A-2,5VA-0,5

Weidmüller Interface GmbH & Co. KG
Klingenbergstraße 26
D-32758 Detmold
Germany

www.weidmueller.com

Drawings

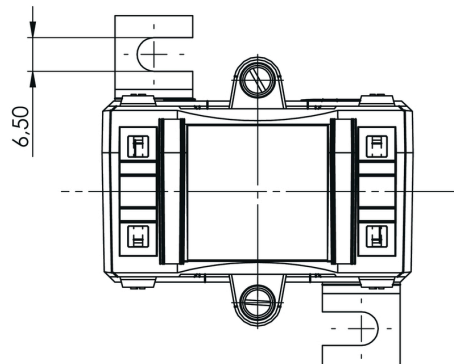
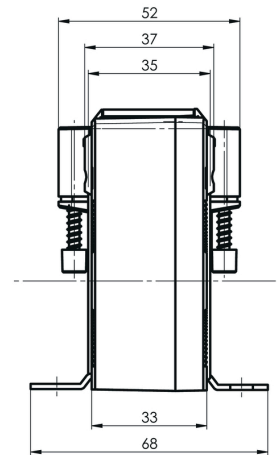
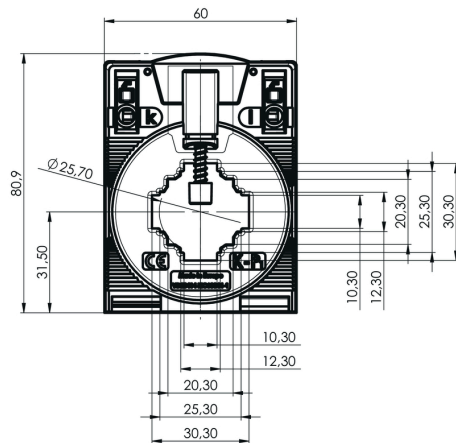

CMA-31-200-5A-2,5VA-0,5

Weidmüller Interface GmbH & Co. KG
Klingenbergstraße 26
D-32758 Detmold
Germany

www.weidmueller.com

Accessories

Plug-on current transformer - ValueLine



Plug-on current transformers

Plug-on current transformers are especially suitable for mounting on the busbar.

The advantages of this type are: Price optimisation, safe connection option, high mechanical holding forces and high current resistance.

General ordering data

Type	CMA-31-41-SNAP-ON
Order No.	2723380000
GTIN (EAN)	4050118810622
Qty.	1 pc(s).