

**CMA-31-150-5A-5VA-1****Weidmüller Interface GmbH & Co. KG**

Klingenbergstraße 26

D-32758 Detmold

Germany

www.weidmueller.com

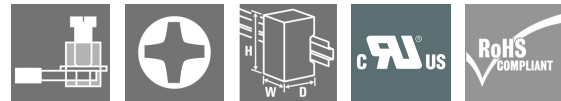
**Plug-on current transformers**

Plug-on current transformers are especially suitable for mounting on the busbar.

The advantages of this type are: Price optimisation, safe connection option, high mechanical holding forces and high current resistance.

**General ordering data**

Version	Primary current: 150 A, Secondary current max.: 5 A, Load: 5 VA, Tolerance class: 1, closed current transformer
Order No.	<a href="#">2420960000</a>
Type	CMA-31-150-5A-5VA-1
GTIN (EAN)	4050118429091
Qty.	1 pc(s).
Manufacturer	MBS AG

## CMA-31-150-5A-5VA-1

Weidmüller Interface GmbH &amp; Co. KG

Klingenbergstraße 26

D-32758 Detmold

Germany

www.weidmueller.com

## Technical data

## Dimensions and weights

Depth	52 mm	Depth (inches)	2.047 inch
Height	80.9 mm	Height (inches)	3.185 inch
Width	60 mm	Width (inches)	2.362 inch
Net weight	275 g		

## Temperatures

Storage temperature	-25 °C...70 °C	Operating temperature	-5 °C...50 °C
---------------------	----------------	-----------------------	---------------

## Dimensions of live conductors

Type of conductor	Insulated conductor only	Round conductor	25.7 mm
Rail	20 x 20 mm, 25 x 12 mm, 30 x 10 mm	Installation location	Indoor use

## Electrical attributes

Load	5 VA	Primary current	150 A
Secondary current	0...5 A	Tolerance class	1

## Technical properties

Insulation class	E	Nominal frequency	50 Hz
Protection degree	IP20	Thermal rated continuous current $I_{\text{thermal}}$	$1.2 \times I_{\text{rated}}$

## Insulation coordination

Standard	IEC 61869-1: 2007, IEC 61869-2: 2012	Tolerance class	1
----------	---	-----------------	---

## Classifications

ETIM 6.0	EC002048	ETIM 7.0	EC002048
ETIM 8.0	EC002048	ETIM 9.0	EC002048
ECLASS 9.0	27-21-09-02	ECLASS 9.1	27-21-09-02
ECLASS 10.0	27-21-09-02	ECLASS 11.0	27-21-09-02
ECLASS 12.0	27-21-09-02	ECLASS 13.0	27-21-09-02
ECLASS 14.0	27-21-09-02		

## Environmental Product Compliance

REACH SVHC	/
RoHS Compliance Status	Compliant

## Approvals

ROHS	Conform
------	---------

### CMA-31-150-5A-5VA-1

**Weidmüller Interface GmbH & Co. KG**

Klingenbergstraße 26

D-32758 Detmold

Germany

[www.weidmueller.com](http://www.weidmueller.com)

## Technical data

### Downloads

Approval/Certificate/Document of Conformity	<a href="#">UL- certificate</a> <a href="#">UKCA Declaration of Conformity</a> <a href="#">Declaration of Conformity</a>
Engineering Data	<a href="#">CAD data – STEP</a>
User Documentation	<a href="#">Device description – instruction sheet english.pdf</a> <a href="#">Device description – Betriebsanleitung deutsch</a>
Catalogues	<a href="#">Catalogues in PDF-format</a>

## CMA-31-150-5A-5VA-1

**Weidmüller Interface GmbH & Co. KG**  
Klingenbergstraße 26  
D-32758 Detmold  
Germany

[www.weidmueller.com](http://www.weidmueller.com)

## Drawings

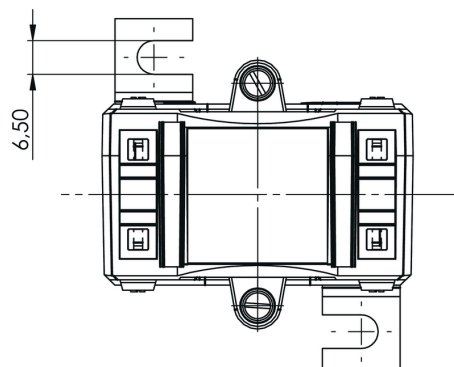
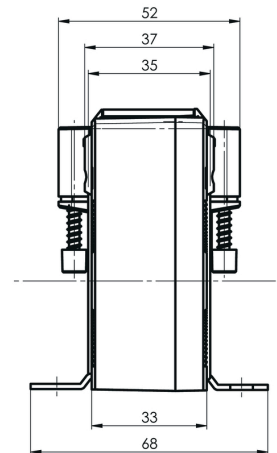
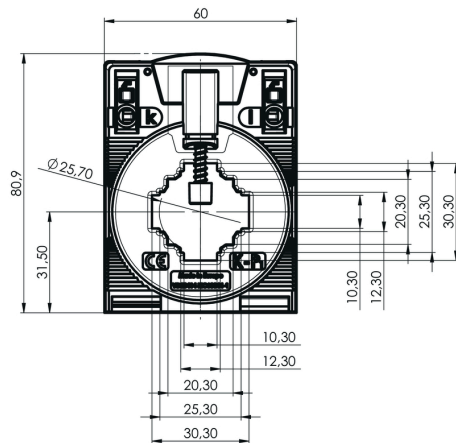

## CMA-31-150-5A-5VA-1

**Weidmüller Interface GmbH & Co. KG**  
Klingenbergstraße 26  
D-32758 Detmold  
Germany

[www.weidmueller.com](http://www.weidmueller.com)

## Accessories

### Plug-on current transformer - ValueLine



#### Plug-on current transformers

Plug-on current transformers are especially suitable for mounting on the busbar.  
The advantages of this type are: Price optimisation, safe connection option, high mechanical holding forces and high current resistance.

### General ordering data

Type	CMA-31-41-SNAP-ON
Order No.	<a href="#">2723380000</a>
GTIN (EAN)	4050118810622
Qty.	1 pc(s).