

**IE-BS-V01M-RJ45-C****Weidmüller Interface GmbH & Co. KG**

Klingenbergstraße 26

D-32758 Detmold

Germany

[www.weidmueller.com](http://www.weidmueller.com)

Bayonet plug-in connector sets according to IEC  
61076-3-106 ver.1 (Ethernet/IP), RJ45 metal insert incl.  
RJ45 insert

**General ordering data**

|            |  |
|------------|--|
| Version    | Flange RJ45, IP67, Variant 1 metal, RJ45 / RJ45 coupling, Cat.6 <sub>A</sub> / Class E <sub>A</sub> (ISO/IEC 11801 2010) |
| Order No.  | <a href="#">1963470000</a>   |
| Type       | IE-BS-V01M-RJ45-C  |
| GTIN (EAN) | 4032248645565  |
| Qty.       | 10 pc(s).  |

## IE-BS-V01M-RJ45-C

Weidmüller Interface GmbH &amp; Co. KG

Klingenbergstraße 26

D-32758 Detmold

Germany

www.weidmueller.com

## Technical data

## Dimensions and weights

|            |        |                 |           |
|------------|--------|-----------------|-----------|
| Height     | 32 mm  | Height (inches) | 1.26 inch |
| Width      | 32 mm  | Width (inches)  | 1.26 inch |
| Net weight | 72.8 g |                 |           |

## Temperatures

|                       |                |
|-----------------------|----------------|
| Operating temperature | -40 °C...70 °C |
|-----------------------|----------------|

## General data

|                        |  |                       |                  |
|------------------------|--|-----------------------|------------------|
| Connection 1           | RJ45                                   | Connection 2          | RJ45             |
| Description of article | Variant 1 metal, RJ45 / RJ45 coupling  | Seal material         | EPDM             |
| Colour                 | Miscellaneous                          | Housing main material | Zinc diecast     |
| Category               | Cat.6A / Class EA (ISO/IEC 11801 2010) | Contact surface       | Gold over nickel |
| Shielding              | 360°; all-round enclosure              | Protection degree     | IP67             |
| Plugging cycles        | 750                                    |                       |                  |

## Electrical properties

|  |                |                                       |                |
|--|----------------|---------------------------------------|----------------|
| Dielectric strength, contact / contact | ≥ 1000 V AC/DC | Dielectric strength, contact / shield | ≥ 1500 V AC/DC |
|--|----------------|---------------------------------------|----------------|

## General standards

|                         |         |                    |  |
|-------------------------|---------|--------------------|--|
| Certificate no. (cULus) | E316369 | Connector standard | IEC 61076-3-106 Var. 1, IEC 60603-7-51 |
|-------------------------|---------|--------------------|--|

## Classifications

|             |             |             |             |
|-------------|-------------|-------------|-------------|
| ETIM 6.0    | EC001121    | ETIM 7.0    | EC001121    |
| ETIM 8.0    | EC001121    | ETIM 9.0    | EC001121    |
| ECLASS 9.0  | 27-44-03-90 | ECLASS 9.1  | 27-44-03-90 |
| ECLASS 10.0 | 27-44-03-90 | ECLASS 11.0 | 27-44-03-90 |
| ECLASS 12.0 | 27-44-03-90 | ECLASS 13.0 | 27-44-03-90 |

## Environmental Product Compliance

|            |  |
|------------|--|
| REACH SVHC | Lead 7439-92-1 6,6'-di-tert-butyl-2,2'-methylenedi-p-cresol 119-47-1 |
| SCIP       | c1a8d9e9-fd0c-4258-8c31-7317a7b4ce18                                 |

## Approvals

Approvals



|                         |            |
|-------------------------|------------|
| ROHS                    | Conform    |
| UL File Number Search   | UL Website |
| Certificate no. (cULus) | E316369    |

**IE-BS-V01M-RJ45-C****Weidmüller Interface GmbH & Co. KG**

Klingenbergstraße 26

D-32758 Detmold

Germany

[www.weidmueller.com](http://www.weidmueller.com)**Technical data****Downloads**

|   |   |
|---|---|
| Approval/Certificate/Document of Conformity | <a href="#">GOST Approval</a><br><a href="#">ISO/IEC and TIA/EIA DE</a><br><a href="#">ISO/IEC EN and TIA/EIA Screened Class E Category 6, 3 connector permanent link</a><br><a href="#">ISO/IEC EN and TIA/EIA Screened Class E Category 6, 4 connector channel</a><br><a href="#">ISO/IEC EN and TIA/EIA Screened Class EA Category 6A, 2 connector channel</a><br><a href="#">DUXR.E316369</a> |
| Engineering Data                            | <a href="#">CAD data – STEP</a>   |
| Product Change Notification                 | <a href="#">Technical change to Bulkhead Variant 1 (Metal) - EN</a><br><a href="#">Technical change to Bulkhead Variant 1 (Metal) - DE</a><br><a href="#">20190724 Technische Änderung zu Flansch Variante 1 (Metall)</a><br><a href="#">20190724 Technische Änderung zu Flansch Variante 1 (Metall)</a><br><a href="#">20190724 Technical change to Bulkhead Variant 1 (Metal)</a>               |
| User Documentation                          | <a href="#">MAN IE GUIDE DE</a><br><a href="#">MAN IE GUIDE EN</a><br><a href="#">Designation key / Type key</a><br><a href="#">Manual</a>  |
| Catalogues                                  | <a href="#">Catalogues in PDF-format</a>  |
| Brochures                                   | <a href="#">MB FREECONTACT EN</a><br><a href="#">FL FIELDWIRING EN</a><br><a href="#">PI PROFINET CABLING EN</a><br><a href="#">PI PROFINET CABLING EN</a>  |

## IE-BS-V01M-RJ45-C

**Weidmüller Interface GmbH & Co. KG**  
Klingenbergstraße 26  
D-32758 Detmold  
Germany

[www.weidmueller.com](http://www.weidmueller.com)

## Drawings

### Installation cut-out

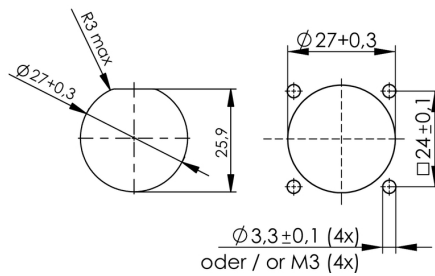

Mounting cut-out: 1. With central screw connection / 2. For mounting with four M3 screws

**IE-BS-V01M-RJ45-C****Weidmüller Interface GmbH & Co. KG**

Klingenbergstraße 26

D-32758 Detmold

Germany

[www.weidmueller.com](http://www.weidmueller.com)**Accessories****Dust caps**

For protecting your devices against dust and dirt.

**General ordering data**

|            |                            |  |
|------------|----------------------------|--|
| Type       | IE-BP-V01P                 | Version                                |
| Order No.  | <a href="#">1965700000</a> | Flange-mounted housing, protective cap |
| GTIN (EAN) | 4032248653928              |  |
| Qty.       | 10 pc(s).                  |  |