

KLIPPON K2 VMQ RAL7001**Weidmüller Interface GmbH & Co. KG**

Klingenbergstraße 26

D-32758 Detmold

Germany

www.weidmueller.com**Similar to illustration**

The aluminium Klippon® K enclosures are suitable for use in an extremely wide range of different areas. Various components can be installed inside the enclosures, and will benefit in particular from the high temperature resistance, the excellent IP protection and the good impact resistance.

No matter what kind of application the customer is planning, Weidmüller is able to provide a wide range of aluminium enclosures precisely fitting the customer's requirements.

Klippon® K enclosures for hazardous areas are available on request.

Our extensive product range offers the following advantages:

- Available in two surface finishes: natural and powder-coated (RAL 7001)
- With chloroprene moulded seal as standard (silicone moulded seal optionally available)
- Standardised closure system with Torx slotted screw head for 19 enclosure sizes
- Mounting holes outside of the gasket area
- High IP protection classes: IP66, IP67 and IP68 according to DIN EN 60529
- Impact resistance of up to 7 (10) Joules
- The enclosures are approved according ATEX, IECEx, cULus, and DNV GL as well as the empty enclosure standard.

- Suitable for railway applications according to EN 45545-2:2013
- Alloy is resistant to salt water
- Standardised distributor enclosures with threaded holes and a variety of terminal configurations

General ordering data

| | |
|-------------------------|---|
| Version | Klippon K (aluminium empty enclosure), Empty enclosure, Aluminium enclosure, Height: 70 mm, Width: 100 mm, Depth: 45 mm, Material: Aluminium AISi12, Powder-coated, textured, Silver grey |
| Order No. | 1937930000 |
| Type | KLIPPON K2 VMQ RAL7001 |
| GTIN (EAN) | 4032248610150 |
| Qty. | 10 pc(s). |
| Unassembled to fit rail | 1910010000 |

KLIPPON K2 VMQ RAL7001

Weidmüller Interface GmbH & Co. KG

Klingenbergstraße 26

D-32758 Detmold

Germany

www.weidmueller.com

Technical data

Dimensions and weights

| | | | |
|-----------------------------|--------|----------------------------|------------|
| Depth | 45 mm | Depth (inches) | 1.772 inch |
| Height | 70 mm | Height (inches) | 2.756 inch |
| Width | 100 mm | Width (inches) | 3.937 inch |
| Mounting dimension - height | 42 mm | Mounting dimension - width | 88 mm |
| Net weight | 316 g | | |

Temperatures

| | |
|-----------------------|-----------------|
| Operating temperature | -60 °C...135 °C |
|-----------------------|-----------------|

Cable glands, left

| | | | |
|-----|---|-----|---|
| M12 | 1 | M16 | 1 |
|-----|---|-----|---|

Cable glands, right

| | | | |
|-----|---|-----|---|
| M12 | 1 | M16 | 1 |
|-----|---|-----|---|

Cable glands, top/bottom

| | | | |
|-----|---|-----|---|
| M12 | 3 | M16 | 3 |
| M20 | 2 | | |

Certificate numbers enclosure

| | | | |
|-------------------------|------------------|---|---------------------------|
| Approval conditions | cULus, RMRS, DNV | Certificate No. (DNV) | TAE00002SM |
| Certificate no. (cULus) | E197061 | Declaration of Conformity No. (DoC LVD) | DE_PS2410_160412_001ISS01 |

General information

| | | | |
|-----------------------------|--|---------------------------------|-------------------------|
| Access opening: height | 63 mm | Access opening: width | 93 mm |
| Areas of use | Process industry, Transportation, Marine engineering, Packaging industry, Harbour facilities, Machine construction | Enclosure attachment | |
| Flange plate | No | | Holes 4 mm |
| Integral fixing | Threaded holes M4 | Impact resistance | 10 J version standard |
| Lid attachment | M4 torx stainless steel screws with slot | Lid | Yes |
| Material thickness of cover | 3 mm | Material | Aluminium AlSi12 |
| Max. payload | 0.7 kg | Material thickness of enclosure | 3.5 mm |
| Number of lid screws | 4 | Note: protection class | IP68 (t=72h, h=1m) |
| Operating temperature, min. | -60 °C | Operating temperature, max. | 135 °C |
| Protection degree | IP66, IP67, IP68 | Protection class (UL) | Type 4, Type 4X |
| Standards | EN 45545-2:2013 | Seal material | Silicone |
| Torque for lid screws | 2.5 Nm | Surface finish | Powder-coated, textured |

horizontal assembly

| | |
|-----------------------------|------|
| WDU 2,5 / ZDU 2,5 / IDU 2,5 | 1x10 |
|-----------------------------|------|

KLIPPON K2 VMQ RAL7001

Weidmüller Interface GmbH & Co. KG

Klingenbergstraße 26

D-32758 Detmold

Germany

www.weidmueller.com

Technical data

vertical assembly

WDU 2,5 / ZDU 2,5 / IDU 2,5

*

WDU 4 / ZDU 4

*

Classifications

| | | | |
|-------------|-------------|-------------|-------------|
| ETIM 6.0 | EC000261 | ETIM 7.0 | EC000261 |
| ETIM 8.0 | EC000261 | ETIM 9.0 | EC000261 |
| ECLASS 9.0 | 27-18-01-01 | ECLASS 9.1 | 27-18-92-90 |
| ECLASS 10.0 | 27-18-01-01 | ECLASS 11.0 | 27-18-01-01 |
| ECLASS 12.0 | 27-18-01-01 | ECLASS 13.0 | 27-18-01-01 |

Environmental Product Compliance

REACH SVHC

Lead 7439-92-1

SCIP

9e4cab4e-239c-4e14-b9df-a0fee300d28a

Approvals

Approvals



ROHS

Conform

UL File Number Search

UL Website

Certificate no. (cULus)

E197061

Downloads

| | |
|---|---|
| Approval/Certificate/Document of Conformity | TAE00002SM EU Declaration of Conformity - Klippon K Empty Enclosures - DoC DE PS2410 160412 001ISS02 DoM Klippon K salt water resistance DoM Klippon K EN 45545-2 2013 Railway |
| Engineering Data | CAD data – STEP |
| Product Change Notification | Technical change to Klippon K® enclosure series Technische Änderung für Klippon® K Gehäuse 20240315-PCN-Klippon K Enclosure Instruction |
| Tender specification | Klippon K2 VMQ RAL7001_1937930000_DE Klippon K2 VMQ RAL7001_1937930000_EN |
| User Documentation | Assembly guidelines - empty enclosures |
| Catalogues | Catalogues in PDF-format |
| Brochures | MB KLIPPON ENCL.TECN EN FL RAILWAY 2014 EN FL RAILWAY 2014 EN |

KLIPPON K2 VMQ RAL7001

Weidmüller Interface GmbH & Co. KG
Klingenbergstraße 26
D-32758 Detmold
Germany

www.weidmueller.com

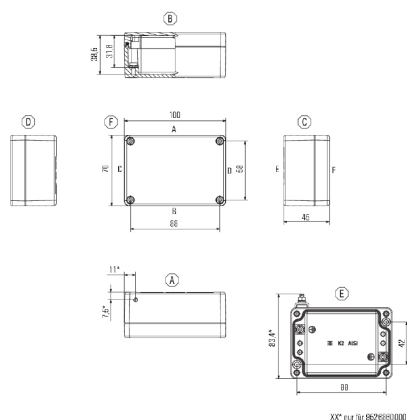
Drawings**Dimensioned drawing**

KLIPPON K2 VMQ RAL7001

Weidmüller Interface GmbH & Co. KG

Klingenbergstraße 26

D-32758 Detmold

Germany

www.weidmueller.com

Accessories

TS 15



The system accessories for the Klippon® K enclosure series allows you to easily adapt the enclosures to meet the specific requirements of every application.

- DIN Rails TS 35 and TS 15
- Mounting plates
- Hinges
- Wall-mounted holder

General ordering data

| | | |
|------------|----------------------------|---|
| Type | TS15X5 ST K2 | Version |
| Order No. | 8000003884 | Rail, TS 15, Width: 90 mm, without slot, Steel, galvanic zinc plated |
| GTIN (EAN) | 4050118652505 | and passivated |
| Qty. | 20 pc(s). | |
| Type | TS15 90 KLIPPON K2 CSS | Version |
| Order No. | 1910010000 | Rail, TS 15, Width: 90 mm, without slot, Steel, galvanized, chromium-plated |
| GTIN (EAN) | 4032248536924 | |
| Qty. | 1 pc(s). | |

Screws



Depending on the terminal block or also accessories, we offer different types of screws as additional items or also spare parts.

General ordering data

| | | |
|------------|----------------------------|---|
| Type | FKSC M4X6 D8/SW2 | Version |
| Order No. | 1567480000 | SAK Series, Allen hex screw, Screws, Number of poles: 1 |
| GTIN (EAN) | 4008190033491 | |
| Qty. | 100 pc(s). | |

KLIPPON K2 VMQ RAL7001

Weidmüller Interface GmbH & Co. KG

Klingenbergstraße 26

D-32758 Detmold

Germany

www.weidmueller.com

Accessories

Klippon® K - Mounting plates



The system accessories for the Klippon® K enclosure series allows you to easily adapt the enclosures to meet the specific requirements of every application.

- DIN Rails TS 35 and TS15
- Mounting plates
- Hinges
- Wall-mounted holder

General ordering data

| Type | MOPL K2 N FE | Version |
|------------|----------------------------|--|
| Order No. | 1905270000 | Klippon K (aluminium empty enclosure), Mounting plate, Mounting |
| GTIN (EAN) | 4032248524433 | plate, Height: 52 mm, Width: 91 mm, Depth: 3 mm, Material: Sheet |
| Qty. | 1 pc(s). | steel, galvanized, galvanized, silver |