

KLIPPON K21 VMQ RAL7001**Weidmüller Interface GmbH & Co. KG**

Klingenbergstraße 26

D-32758 Detmold

Germany

www.weidmueller.com**Similar to illustration**

The aluminium Klippon® K enclosures are suitable for use in an extremely wide range of different areas. Various components can be installed inside the enclosures, and will benefit in particular from the high temperature resistance, the excellent IP protection and the good impact resistance.

No matter what kind of application the customer is planning, Weidmüller is able to provide a wide range of aluminium enclosures precisely fitting the customer's requirements.

Klippon® K enclosures for hazardous areas are available on request.

Our extensive product range offers the following advantages:

- Available in two surface finishes: natural and powder-coated (RAL 7001)
- With chloroprene moulded seal as standard (silicone moulded seal optionally available)
- Standardised closure system with Torx slotted screw head for 19 enclosure sizes
- Mounting holes outside of the gasket area
- High IP protection classes: IP66, IP67 and IP68 according to DIN EN 60529
- Impact resistance of up to 7 (10) Joules
- The enclosures are approved according ATEX, IECEx, cULus, and DNV GL as well as the empty enclosure standard.

- Suitable for railway applications according to EN 45545-2:2013
- Alloy is resistant to salt water
- Standardised distributor enclosures with threaded holes and a variety of terminal configurations

General ordering data

| | |
|-------------------------|---|
| Version | Klippon K (aluminium empty enclosure), Empty enclosure, Aluminium enclosure, Height: 80 mm, Width: 125 mm, Depth: 57 mm, Material: Aluminium AISi12, Powder-coated, textured, Silver grey |
| Order No. | 1937830000 |
| Type | KLIPPON K21 VMQ RAL7001 |
| GTIN (EAN) | 4032248609970 |
| Qty. | 5 pc(s). |
| Unassembled to fit rail | 1910020000 |

KLIPPON K21 VMQ RAL7001

Weidmüller Interface GmbH & Co. KG

Klingenbergstraße 26

D-32758 Detmold

Germany

www.weidmueller.com

Technical data

Dimensions and weights

| | | | |
|-----------------------------|---------|----------------------------|------------|
| Depth | 57 mm | Depth (inches) | 2.244 inch |
| Height | 80 mm | Height (inches) | 3.15 inch |
| Width | 125 mm | Width (inches) | 4.921 inch |
| Mounting dimension - height | 52 mm | Mounting dimension - width | 113 mm |
| Net weight | 444.2 g | | |

Temperatures

| | |
|-----------------------|-----------------|
| Operating temperature | -60 °C...135 °C |
|-----------------------|-----------------|

Cable glands, left

| | | | |
|-----|---|-----|---|
| M12 | 2 | M16 | 2 |
| M20 | 1 | | |

Cable glands, right

| | | | |
|-----|---|-----|---|
| M12 | 2 | M16 | 2 |
| M20 | 1 | | |

Cable glands, top/bottom

| | | | |
|-----|---|-----|---|
| M12 | 6 | M16 | 4 |
| M20 | 3 | M25 | 2 |

Certificate numbers enclosure

| | | | |
|-------------------------|------------------|---|---------------------------|
| Approval conditions | cULus, RMRS, DNV | Certificate No. (DNV) | TAE00002SM |
| Certificate no. (cULus) | E197061 | Declaration of Conformity No. (DoC LVD) | DE_PS2410_160412_001ISS01 |

General information

| | | | |
|-----------------------------|--|---------------------------------|-------------------------------------|
| Access opening: height | 72 mm | Access opening: width | 117 mm |
| Areas of use | Process industry, Transportation, Marine engineering, Packaging industry, Harbour facilities, Machine construction | Enclosure attachment | |
| Flange plate | No | Impact resistance | Holes 4 mm 10 J version standard |
| Integral fixing | Threaded holes M4 | Lid | Yes |
| Lid attachment | M4 torx stainless steel screws with slot | Material | Aluminium AlSi12 |
| Material thickness of cover | 2.5 mm | Material thickness of enclosure | 4 mm |
| Max. payload | 1 kg | Note: protection class | IP68 (t=72h, h=1m) |
| Number of lid screws | 4 | Operating temperature, max. | 135 °C |
| Operating temperature, min. | -60 °C | Protection class (UL) | Type 4, Type 4X |
| Protection degree | IP66, IP67, IP68 | Seal material | Silicone |
| Standards | EN 45545-2:2013 | Surface finish | Powder-coated, textured |
| Torque for lid screws | 2.5 Nm | | |

horizontal assembly

| | | | |
|-----------------------------|------|---------------|------|
| WDU 2,5 / ZDU 2,5 / IDU 2,5 | 1x15 | WDU 4 / ZDU 4 | 1x12 |
|-----------------------------|------|---------------|------|

KLIPPON K21 VMQ RAL7001

Weidmüller Interface GmbH & Co. KG

Klingenbergstraße 26

D-32758 Detmold

Germany

www.weidmueller.com

Technical data

vertical assembly

WDU 2,5 / ZDU 2,5 / IDU 2,5

*

WDU 4 / ZDU 4

*

Classifications

| | | | |
|-------------|-------------|-------------|-------------|
| ETIM 6.0 | EC000261 | ETIM 7.0 | EC000261 |
| ETIM 8.0 | EC000261 | ETIM 9.0 | EC000261 |
| ECLASS 9.0 | 27-18-01-01 | ECLASS 9.1 | 27-18-92-90 |
| ECLASS 10.0 | 27-18-01-01 | ECLASS 11.0 | 27-18-01-01 |
| ECLASS 12.0 | 27-18-01-01 | ECLASS 13.0 | 27-18-01-01 |

Environmental Product Compliance

| | |
|------------|--------------------------------------|
| REACH SVHC | Lead 7439-92-1 |
| SCIP | 9e4cab4e-239c-4e14-b9df-a0fee300d28a |

Approvals

Approvals



| | |
|-------------------------|------------|
| ROHS | Conform |
| UL File Number Search | UL Website |
| Certificate no. (cULus) | E197061 |

Downloads

| | |
|---|---|
| Approval/Certificate/Document of Conformity | TAE00002SM EU Declaration of Conformity - Klippon K Empty Enclosures - DoC DE PS2410 160412 001ISS02 DoM Klippon K salt water resistance DoM Klippon K EN 45545-2 2013 Railway |
| Engineering Data | CAD data – STEP |
| Product Change Notification | Technical change to Klippon K® enclosure series Technische Änderung für Klippon® K Gehäuse 20240315-PCN-Klippon K Enclosure Instruction |
| Tender specification | Klippon K21 VMQ RAL7001_1937830000_DE Klippon K21 VMQ RAL7001_1937830000_EN |
| User Documentation | Assembly guidelines - empty enclosures |
| Catalogues | Catalogues in PDF-format |
| Brochures | MB KLIPPON ENCL.TECN EN FL RAILWAY 2014 EN FL RAILWAY 2014 EN |

KLIPPON K21 VMQ RAL7001

Weidmüller Interface GmbH & Co. KG
Klingenbergstraße 26
D-32758 Detmold
Germany

www.weidmueller.com

Drawings

Dimensioned drawing

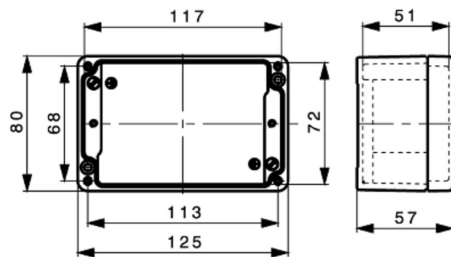

KLIPPON K21 VMQ RAL7001

Weidmüller Interface GmbH & Co. KG

Klingenbergstraße 26

D-32758 Detmold

Germany

www.weidmueller.com

Accessories

TS 15



The system accessories for the Klippon® K enclosure series allows you to easily adapt the enclosures to meet the specific requirements of every application.

- DIN Rails TS 35 and TS 15
- Mounting plates
- Hinges
- Wall-mounted holder

General ordering data

| | | |
|------------|----------------------------|---|
| Type | TS15 114 KLIPPON K21 CSS | Version |
| Order No. | 1910020000 | Rail, TS 15, Width: 114 mm, with slot, Steel, galvanized, chromium-plated |
| GTIN (EAN) | 4032248536931 | |
| Qty. | 1 pc(s). | |
| Type | TS15X5 ST K21 | Version |
| Order No. | 8000003886 | Rail, TS 15, Width: 114 mm, with slot, Steel, galvanic zinc plated and passivated |
| GTIN (EAN) | 4050118627930 | |
| Qty. | 20 pc(s). | |

Klippon® K - Mounting plates



The system accessories for the Klippon® K enclosure series allows you to easily adapt the enclosures to meet the specific requirements of every application.

- DIN Rails TS 35 and TS 15
- Mounting plates
- Hinges
- Wall-mounted holder

General ordering data

| | | |
|------------|----------------------------|---|
| Type | MOPL K21 STAHL | Version |
| Order No. | 3073020000 | Klippon K (aluminium empty enclosure), Mounting plate, Mounting plate, Height: 67 mm, Width: 114 mm, Depth: 2 mm, Material: Sheet steel, galvanized, galvanized, silver |
| GTIN (EAN) | 4008190857950 | |
| Qty. | 1 pc(s). | |

KLIPPON K21 VMQ RAL7001**Weidmüller Interface GmbH & Co. KG**

Klingenbergstraße 26

D-32758 Detmold

Germany

www.weidmueller.com**Accessories****Depth 7.5 mm**

The system accessories for the Klippon® K enclosure series allows you to easily adapt the enclosures to meet the specific requirements of every application.

- DIN Rails TS 35 and TS 15
- Mounting plates
- Hinges
- Wall-mounted holder

General ordering data

| | | |
|------------|----------------------------|--|
| Type | TS35X7.5 ST K21 | Version |
| Order No. | 8000003897 | Rail, TS 35, TS 35 x 7.5, Width: 114 mm, without slot, Steel, galvanic |
| GTIN (EAN) | 4050118652598 | zinc plated and passivated |
| Qty. | 20 pc(s). | |

Depth 15 mm

The system accessories for the Klippon® K enclosure series allows you to easily adapt the enclosures to meet the specific requirements of every application.

- DIN Rails TS 35 and TS 15
- Mounting plates
- Hinges
- Wall-mounted holder

General ordering data

| | | |
|------------|----------------------------|---|
| Type | TS35X15 ST K21 | Version |
| Order No. | 8000073088 | Rail, TS 35, TS 35 x 15, Width: 114 mm, with slot, Steel, galvanic zinc |
| GTIN (EAN) | 4064675336990 | plated and passivated |
| Qty. | 20 pc(s). | |

KLIPPON K21 VMQ RAL7001

Weidmüller Interface GmbH & Co. KG

Klingenbergstraße 26

D-32758 Detmold

Germany

www.weidmueller.com

Accessories

Spacer



Stainless steel spacers in three lengths to increase the distance between the mounting rails or DIN rails and the rear wall of the enclosure.

General ordering data

| | | |
|------------|----------------------------|--|
| Type | SP M6 20 MSZN | Version |
| Order No. | 3896200000 | Klippon EB (Essential Box), Spacer, Height: 11.2 mm, Width: 10 mm, |
| GTIN (EAN) | 4008190850234 | Depth: 20 mm, Material: Steel, silver |
| Qty. | 2 pc(s). | |
| Type | SP M6 30 MSZN | Version |
| Order No. | 3896300000 | Klippon EB (Essential Box), Spacer, Height: 11.2 mm, Width: 10 mm, |
| GTIN (EAN) | 4008190850241 | Depth: 30 mm, Material: Steel, silver |
| Qty. | 2 pc(s). | |
| Type | SP M6 15 MSZN | Version |
| Order No. | 3896100000 | Klippon EB (Essential Box), Spacer, Height: 11.2 mm, Width: 10 mm, |
| GTIN (EAN) | 4008190857851 | Depth: 15 mm, Material: Steel, silver |
| Qty. | 2 pc(s). | |

Screws



Depending on the terminal block or also accessories, we offer different types of screws as additional items or also spare parts.

General ordering data

| | | |
|------------|----------------------------|---|
| Type | FKSC M4X6 D8/SW2 | Version |
| Order No. | 1567480000 | SAK Series, Allen hex screw, Screws, Number of poles: 1 |
| GTIN (EAN) | 4008190033491 | |
| Qty. | 100 pc(s). | |

KLIPPON K21 VMQ RAL7001**Weidmüller Interface GmbH & Co. KG**

Klingenbergstraße 26

D-32758 Detmold

Germany

www.weidmueller.com**Accessories****Klippon® K - Hinge**

The system accessories for the Klippon® K enclosure series allows you to easily adapt the enclosures to meet the specific requirements of every application.

- DIN Rails TS 35 and TS15
- Mounting plates
- Hinges
- Wall-mounted holder

General ordering data

| | | |
|------------|----------------------------|---|
| Type | HG K+POK | Version |
| Order No. | 1580360000 | Klippon POK (polyester empty enclosure), External joint, Hinge, |
| GTIN (EAN) | 4008190203542 | Material: Aluminium AlSi12, silver |
| Qty. | 1 pc(s). | |