

HDC 10A KLU 2PG09G**Weidmüller Interface GmbH & Co. KG**

Klingenbergstraße 26

D-32758 Detmold

Germany

www.weidmueller.com**IP65**

The special die-cast alloy and the multi-layered surface sealing provide complete protection for the HDC housings.

The cleverly designed interlock system is manufactured from stainless steel. This guarantees a long lifespan with high resistance to corrosion and impact.

The housing interlock system provides integrated safety. Our unique, patented spring system provides the housing interlock with a secure grip and prevents accidental opening.

The laser marking allows for easy and quick identification. Each housing is permanently labelled with a laser marking so that each product can be quickly designated and positioned.

Weidmüller RockStar® IP 65 / NEMA Type 4X housings - your first choice for industrial housings with IP 65 protection.

General ordering data

Version	HDC enclosures, Size: 2, Protection degree: IP65 (in plugged condition), Coupling housing, End-locking clamp, lower side, Standard, Size of cable entries: PG 9
Order No.	1783250000
Type	HDC 10A KLU 2PG09G
GTIN (EAN)	4032248181650
Qty.	1 pc(s).

HDC 10A KLU 2PG09G

Weidmüller Interface GmbH & Co. KG

Klingenbergstraße 26

D-32758 Detmold

Germany

www.weidmueller.com

Technical data

Dimensions and weights

Height	48 mm	Height (inches)	1.89 inch
Width	53.5 mm	Width (inches)	2.106 inch
Net weight	131 g		

Temperatures

Limit temperature	-40 °C ... 125 °C
-------------------	-------------------

Dimensions

Cable entry	w. thread	Height of housing B	48 mm
Total length housing	63 mm	Width housing C	29.5 mm

General data

EMC housings	No	Housing main material	diecast aluminium
Material of locking element		Protection degree	IP65 (in plugged condition)
Surface finish	Stainless steel, rust-proof	Tightening torque	0.5 Nm
	Powder coating		

Version

BG	2	Cable entry	w. thread
Clamp version	End-locking clamp	Colour (RAL)	RAL 7035
Design	Standard	Design of housing	Coupling housing
Design of locking system	End-locking clamp, lower side	Internal thread	PG 9
Number of cable entry on top	2	Number of cable entry sideways	0
Size	2	Size of cable entries	PG 9
Suitable for ModuPlug®	No	Tightening torque	0.5 Nm
Top part/bottom part/lid	lower part	Type	coupling extension

Classifications

ETIM 6.0	EC000437	ETIM 7.0	EC000437
ETIM 8.0	EC000437	ETIM 9.0	EC000437
ECLASS 9.0	27-44-02-02	ECLASS 9.1	27-44-02-02
ECLASS 10.0	27-44-02-02	ECLASS 11.0	27-44-02-02
ECLASS 12.0	27-44-02-02	ECLASS 13.0	27-44-02-02

Substance	Acetone
Chemical resistance	Conditionally resistant
Substance	Drilling oil
Chemical resistance	Resistant
Substance	Diesel
Chemical resistance	Resistant
Substance	Ethyl alcohol
Chemical resistance	Resistant
Substance	Transmission oil
Chemical resistance	Resistant

HDC 10A KLU 2PG09G

Weidmüller Interface GmbH & Co. KG

Klingenbergstraße 26

D-32758 Detmold

Germany

www.weidmueller.com

Technical data

Substance	Hydraulic oil
Chemical resistance	Resistant
Substance	Coolant
Chemical resistance	Resistant
Substance	Petroleum benzine
Chemical resistance	Resistant
Substance	Sweat
Chemical resistance	Resistant
Substance	Premium gasoline
Chemical resistance	Conditionally resistant
Substance	Water
Chemical resistance	Resistant
Substance	UV
Chemical resistance	Unstable
Substance	Ozone
Chemical resistance	Unstable

Environmental Product Compliance

REACH SVHC	Lead 7439-92-1 Potassium perfluorobutane sulfonate 29420-49-3
SCIP	e98b2b24-ba23-41bf-8d19-Odda3647412f
Chemical resistance	de.myview.objectmodel.impl.BlockImpl@2338cd4b de.myview.objectmodel.impl.BlockImpl@290e1cd3 de.myview.objectmodel.impl.BlockImpl@425e9774 de.myview.objectmodel.impl.BlockImpl@70adc51f de.myview.objectmodel.impl.BlockImpl@159a0cd4 de.myview.objectmodel.impl.BlockImpl@4cab6230 de.myview.objectmodel.impl.BlockImpl@7a78a9e6 de.myview.objectmodel.impl.BlockImpl@64e30e8b de.myview.objectmodel.impl.BlockImpl@21da426f de.myview.objectmodel.impl.BlockImpl@36f71e86 de.myview.objectmodel.impl.BlockImpl@9ffa627 de.myview.objectmodel.impl.BlockImpl@759476c5 de.myview.objectmodel.impl.BlockImpl@6ae8b22
RoHS Compliance Status	Compliant with exemption
RoHS Exemption (if applicable/known)	6bl

Approvals

Approvals



ROHS	Conform
UL File Number Search	UL Website
Certificate No. (cURus)	E92202

Downloads

Approval/Certificate/Document of Conformity	Manufacturer's declaration
Engineering Data	CAD data – STEP
Product Change Notification	20220214 Technical change to HDC housings 20220214 Technische Änderung bei HDC-Gehäusen
Catalogues	Catalogues in PDF-format
Brochures	FL FIELDWIRING EN FL FIELDWIRING EN

Creation date July 24, 2024 10:53:46 PM CEST

Catalogue status 13.07.2024 / We reserve the right to make technical changes.

HDC 10A KLU 2PG09G

Weidmüller Interface GmbH & Co. KG
Klingenbergstraße 26
D-32758 Detmold
Germany

www.weidmueller.com

Drawings

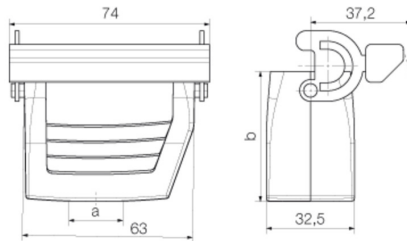

HDC 10A KLU 2PG09G**Weidmüller Interface GmbH & Co. KG**

Klingenbergstraße 26

D-32758 Detmold

Germany

www.weidmueller.com**Accessories****Cover**

The special die-cast alloy and the multi-layered surface sealing provide complete protection for the HDC housings.

The cleverly designed interlock system is manufactured from stainless steel. This guarantees a long lifespan with high resistance to corrosion and impact.

The housing interlock system provides integrated safety. Our unique, patented spring system provides the housing interlock with a secure grip and prevents accidental opening.

The laser marking allows for easy and quick identification. Each housing is permanently labelled with a laser marking so that each product can be quickly designated and positioned.

Weidmüller RockStar® IP 65 / NEMA Type 4X housings - your first choice for industrial housings with IP 65 protection.

General ordering data

Type	HDC 10A DMDL 2BO	Version
Order No.	1665880000	HDC enclosures, Size: 2, Protection degree: IP65 (in plugged condition), Cover for lower part of housing, End-locking clamp, lower side, Standard
GTIN (EAN)	4008190422912	
Qty.	1 pc(s).	