

**HDC 10A KLU 1PG16G****Weidmüller Interface GmbH & Co. KG**

Klingenbergstraße 26

D-32758 Detmold

Germany

[www.weidmueller.com](http://www.weidmueller.com)**IP65**

The special die-cast alloy and the multi-layered surface sealing provide complete protection for the HDC housings.

The cleverly designed interlock system is manufactured from stainless steel. This guarantees a long lifespan with high resistance to corrosion and impact.

The housing interlock system provides integrated safety. Our unique, patented spring system provides the housing interlock with a secure grip and prevents accidental opening.

The laser marking allows for easy and quick identification. Each housing is permanently labelled with a laser marking so that each product can be quickly designated and positioned.

Weidmüller RockStar® IP 65 / NEMA Type 4X housings - your first choice for industrial housings with IP 65 protection.

**General ordering data**

Version	HDC enclosures, Size: 2, Protection degree: IP65 (in plugged condition), Coupling housing, End-locking clamp, lower side, Standard, Size of cable entries: PG 16
Order No.	<a href="#">1664560000</a>
Type	HDC 10A KLU 1PG16G
GTIN (EAN)	4008190421250
Qty.	1 pc(s).

## HDC 10A KLU 1PG16G

Weidmüller Interface GmbH &amp; Co. KG

Klingenbergstraße 26

D-32758 Detmold

Germany

www.weidmueller.com

## Technical data

## Dimensions and weights

Height	48 mm	Height (inches)	1.89 inch
Width	53.5 mm	Width (inches)	2.106 inch
Net weight	129 g		

## Temperatures

Limit temperature	-40 °C ... 125 °C
-------------------	-------------------

## Dimensions

Cable entry	w. thread	Height of housing B	48 mm
Total length housing	63 mm	Width housing C	29.5 mm

## General data

EMC housings	No	Housing main material	diecast aluminium
Material of locking element		Protection degree	IP65 (in plugged condition)
Surface finish	Stainless steel, rust-proof	Tightening torque	0.5 Nm
	Powder coating		

## Version

BG	2	Cable entry	w. thread
Clamp version	End-locking clamp	Colour (RAL)	RAL 7035
Design	Standard	Design of housing	Coupling housing
Design of locking system	End-locking clamp, lower side	Internal thread	PG 16
Number of cable entry on top	1	Number of cable entry sideways	0
Size	2	Size of cable entries	PG 16
Suitable for ModuPlug®	No	Tightening torque	0.5 Nm
Top part/bottom part/lid	lower part	Type	coupling extension

## Classifications

ETIM 6.0	EC000437	ETIM 7.0	EC000437
ETIM 8.0	EC000437	ETIM 9.0	EC000437
ECLASS 9.0	27-44-02-02	ECLASS 9.1	27-44-02-02
ECLASS 10.0	27-44-02-02	ECLASS 11.0	27-44-02-02
ECLASS 12.0	27-44-02-02	ECLASS 13.0	27-44-02-02
ECLASS 14.0	27-44-02-02		

Substance	Acetone
Chemical resistance	Conditionally resistant
Substance	Drilling oil
Chemical resistance	Resistant
Substance	Diesel
Chemical resistance	Resistant
Substance	Ethyl alcohol
Chemical resistance	Resistant
Substance	Transmission oil
Chemical resistance	Resistant

Creation date August 28, 2024 12:55:27 PM CEST

**HDC 10A KLU 1PG16G****Weidmüller Interface GmbH & Co. KG**

Klingenbergstraße 26

D-32758 Detmold

Germany

[www.weidmueller.com](http://www.weidmueller.com)**Technical data**

Substance	Hydraulic oil
Chemical resistance	Resistant
Substance	Coolant
Chemical resistance	Resistant
Substance	Petroleum benzine
Chemical resistance	Resistant
Substance	Sweat
Chemical resistance	Resistant
Substance	Premium gasoline
Chemical resistance	Conditionally resistant
Substance	Water
Chemical resistance	Resistant
Substance	UV
Chemical resistance	Unstable
Substance	Ozone
Chemical resistance	Unstable

**Environmental Product Compliance**

REACH SVHC	Lead 7439-92-1 Potassium perfluorobutane sulfonate 29420-49-3
SCIP	e98b2b24-ba23-41bf-8d19-Odda3647412f
Chemical resistance	de.myview.objectmodel.impl.BlockImpl@323f39ba de.myview.objectmodel.impl.BlockImpl@5dea8710 de.myview.objectmodel.impl.BlockImpl@1cb77357 de.myview.objectmodel.impl.BlockImpl@18bcf568 de.myview.objectmodel.impl.BlockImpl@5305fd2c de.myview.objectmodel.impl.BlockImpl@5a5e325b de.myview.objectmodel.impl.BlockImpl@7dd4df8c de.myview.objectmodel.impl.BlockImpl@2bc62eb de.myview.objectmodel.impl.BlockImpl@7eac030d de.myview.objectmodel.impl.BlockImpl@55cb2a69 de.myview.objectmodel.impl.BlockImpl@eb8a7e3 de.myview.objectmodel.impl.BlockImpl@6f7227e5 de.myview.objectmodel.impl.BlockImpl@71d8e56d
RoHS Compliance Status	Compliant with exemption
RoHS Exemption (if applicable/known)	6bl

**Approvals**

Approvals



ROHS	Conform
UL File Number Search	UL Website
Certificate No. (cURus)	E92202

## HDC 10A KLU 1PG16G

**Weidmüller Interface GmbH & Co. KG**

Klingenbergstraße 26

D-32758 Detmold

Germany

[www.weidmueller.com](http://www.weidmueller.com)

## Technical data

### Downloads

Approval/Certificate/Document of Conformity

[Manufacturer's declaration](#)

Engineering Data

[CAD data – STEP](#)

Product Change Notification

[20220214 Technical change to HDC housings](#)

[20220214 Technische Änderung bei HDC-Gehäusen](#)

Technical Documentation

[1664560000 HDC 10A KLU 1PG16G STP Blatt 1.pdf](#)

Catalogues

[Catalogues in PDF-format](#)

Brochures

[FL FIELDWIRING EN](#)

[FL FIELDWIRING EN](#)

## HDC 10A KLU 1PG16G

**Weidmüller Interface GmbH & Co. KG**  
Klingenbergstraße 26  
D-32758 Detmold  
Germany

[www.weidmueller.com](http://www.weidmueller.com)

## Drawings

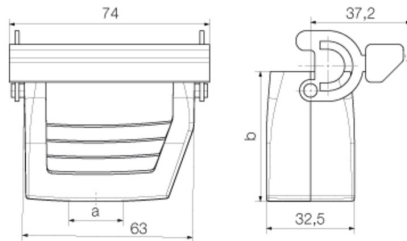

**HDC 10A KLU 1PG16G****Weidmüller Interface GmbH & Co. KG**

Klingenbergstraße 26

D-32758 Detmold

Germany

[www.weidmueller.com](http://www.weidmueller.com)**Accessories****Cover**

The special die-cast alloy and the multi-layered surface sealing provide complete protection for the HDC housings.

The cleverly designed interlock system is manufactured from stainless steel. This guarantees a long lifespan with high resistance to corrosion and impact.

The housing interlock system provides integrated safety. Our unique, patented spring system provides the housing interlock with a secure grip and prevents accidental opening.

The laser marking allows for easy and quick identification. Each housing is permanently labelled with a laser marking so that each product can be quickly designated and positioned.

Weidmüller RockStar® IP 65 / NEMA Type 4X housings - your first choice for industrial housings with IP 65 protection.

**General ordering data**

Type	HDC 10A DMDL 2BO	Version
Order No.	<a href="#">1665880000</a>	HDC enclosures, Size: 2, Protection degree: IP65 (in plugged condition), Cover for lower part of housing, End-locking clamp, lower side, Standard
GTIN (EAN)	4008190422912	
Qty.	1 pc(s).	