

HDC 40D SBU 2PG21G**Weidmüller Interface GmbH & Co. KG**

Klingenbergstraße 26

D-32758 Detmold

Germany

www.weidmueller.com**IP65**

The special die-cast alloy and the multi-layered surface sealing provide complete protection for the HDC housings.

The cleverly designed interlock system is manufactured from stainless steel. This guarantees a long lifespan with high resistance to corrosion and impact.

The housing interlock system provides integrated safety. Our unique, patented spring system provides the housing interlock with a secure grip and prevents accidental opening.

The laser marking allows for easy and quick identification. Each housing is permanently labelled with a laser marking so that each product can be quickly designated and positioned.

Weidmüller RockStar® IP 65 / NEMA Type 4X housings - your first choice for industrial housings with IP 65 protection.

General ordering data

| | |
|------------|---|
| Version | HDC enclosures, Size: 6, Protection degree: IP65 (in plugged condition), Base housing, Side-locking clamp on lower side, high, Size of cable entries: PG 21 |
| Order No. | 1656810000 |
| Type | HDC 40D SBU 2PG21G |
| GTIN (EAN) | 4008190409821 |
| Qty. | 1 pc(s). |

HDC 40D SBU 2PG21G

Weidmüller Interface GmbH & Co. KG

Klingenbergstraße 26

D-32758 Detmold

Germany

www.weidmueller.com

Technical data

Dimensions and weights

| | | | |
|-----------------------------|---------|----------------------------|------------|
| Height | 84 mm | Height (inches) | 3.307 inch |
| Width | 56.5 mm | Width (inches) | 2.224 inch |
| Mounting dimension - height | 45 mm | Mounting dimension - width | 105 mm |
| Net weight | 459 g | | |

Temperatures

| | |
|-------------------|-------------------|
| Limit temperature | -40 °C ... 125 °C |
|-------------------|-------------------|

Dimensions

| | | | |
|----------------------|-----------|----------------------|---------|
| Cable entry | w. thread | Height of base B1 | 5 mm |
| Height of housing B | 84 mm | Hole pitch length A2 | 105 mm |
| Total length housing | 93.3 mm | Width base C1 | 56.5 mm |
| Width housing C | 43 mm | | |

General data

| | | | |
|-----------------------------|-----------------------------|-----------------------|-----------------------------|
| EMC housings | No | Housing main material | diecast aluminium |
| Material of locking element | Stainless steel, rust-proof | Protection degree | IP65 (in plugged condition) |
| Surface finish | Powder coating | | |

Version

| | | | |
|------------------------------|----------------------------------|--------------------------------|--------------|
| BG | 6 | Cable entry | w. thread |
| Clamp version | Side-locking clamp | Colour (RAL) | RAL 7035 |
| Design | high | Design of housing | Base housing |
| Design of locking system | Side-locking clamp on lower side | Internal thread | PG 21 |
| Number of cable entry on top | 0 | Number of cable entry sideways | 2 |
| Sealing | NBR | Size | 6 |
| Size of cable entries | PG 21 | Suitable for ModuPlug® | Yes |
| Top part/bottom part/lid | lower part | Type | Base housing |

Classifications

| | | | |
|-------------|-------------|-------------|-------------|
| ETIM 6.0 | EC000437 | ETIM 7.0 | EC000437 |
| ETIM 8.0 | EC000437 | ETIM 9.0 | EC000437 |
| ECLASS 9.0 | 27-44-02-02 | ECLASS 9.1 | 27-44-02-02 |
| ECLASS 10.0 | 27-44-02-02 | ECLASS 11.0 | 27-44-02-02 |
| ECLASS 12.0 | 27-44-02-02 | ECLASS 13.0 | 27-44-02-02 |
| ECLASS 14.0 | 27-44-02-02 | | |

| | |
|---------------------|-------------------------|
| Substance | Acetone |
| Chemical resistance | Conditionally resistant |
| Substance | Drilling oil |
| Chemical resistance | Resistant |
| Substance | Diesel |
| Chemical resistance | Resistant |
| Substance | Ethyl alcohol |
| Chemical resistance | Resistant |

Creation date November 6, 2024 12:32:27 PM CET

HDC 40D SBU 2PG21G**Weidmüller Interface GmbH & Co. KG**

Klingenbergstraße 26

D-32758 Detmold

Germany

www.weidmueller.com**Technical data**

| | |
|---------------------|-------------------------|
| Substance | Transmission oil |
| Chemical resistance | Resistant |
| Substance | Hydraulic oil |
| Chemical resistance | Resistant |
| Substance | Coolant |
| Chemical resistance | Resistant |
| Substance | Petroleum benzine |
| Chemical resistance | Resistant |
| Substance | Sweat |
| Chemical resistance | Resistant |
| Substance | Premium gasoline |
| Chemical resistance | Conditionally resistant |
| Substance | Water |
| Chemical resistance | Resistant |
| Substance | UV |
| Chemical resistance | Unstable |
| Substance | Ozone |
| Chemical resistance | Unstable |

Environmental Product Compliance

| | |
|--------------------------------------|---|
| RoHS Compliance Status | Compliant with exemption |
| RoHS Exemption (if applicable/known) | 6bl |
| REACH SVHC | Lead 7439-92-1 Potassium perfluorobutane sulfonate 29420-49-3 |
| SCIP | e98b2b24-ba23-41bf-8d19-0dda3647412f |
| Chemical resistance | de.myview.objectmodel.impl.BlockImpl@47d7dd54 de.myview.objectmodel.impl.BlockImpl@2d571d86 de.myview.objectmodel.impl.BlockImpl@35d74438 de.myview.objectmodel.impl.BlockImpl@138e2817 de.myview.objectmodel.impl.BlockImpl@6a4a6a4f de.myview.objectmodel.impl.BlockImpl@7fe4e1ad de.myview.objectmodel.impl.BlockImpl@709d8ced de.myview.objectmodel.impl.BlockImpl@1231dc79 de.myview.objectmodel.impl.BlockImpl@2b90d462 de.myview.objectmodel.impl.BlockImpl@73a1a134 de.myview.objectmodel.impl.BlockImpl@6fc7b149 de.myview.objectmodel.impl.BlockImpl@73896adc de.myview.objectmodel.impl.BlockImpl@5e97930b |

Approvals

Approvals



| | |
|-------------------------|------------|
| ROHS | Conform |
| UL File Number Search | UL Website |
| Certificate No. (cURus) | E92202 |

HDC 40D SBU 2PG21G

Weidmüller Interface GmbH & Co. KG

Klingenbergstraße 26

D-32758 Detmold

Germany

www.weidmueller.com

Technical data

Downloads

Approval/Certificate/Document of Conformity

[Manufacturer's declaration](#)

Engineering Data

[CAD data – STEP](#)

Product Change Notification

[20220214 Technical change to HDC housings](#)

[20220214 Technische Änderung bei HDC-Gehäusen](#)

Technical Documentation

[1656810000 HDC_40D_SBU_2PG21G_STP_Blatt_1.pdf](#)

Catalogues

[Catalogues in PDF-format](#)

Brochures

[FL FIELDWIRING EN](#)

[FL FIELDWIRING EN](#)

www.weidmueller.com

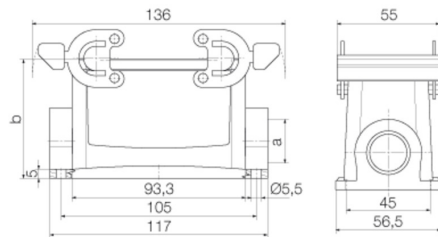

HDC 40D SBU 2PG21G

Weidmüller Interface GmbH & Co. KG

Klingenbergstraße 26

D-32758 Detmold

Germany

www.weidmueller.com

Accessories

Hood, Cable Entry at top



The special die-cast alloy and the multi-layered surface sealing provide complete protection for the HDC housings.

The cleverly designed interlock system is manufactured from stainless steel. This guarantees a long lifespan with high resistance to corrosion and impact.

The housing interlock system provides integrated safety. Our unique, patented spring system provides the housing interlock with a secure grip and prevents accidental opening.

The laser marking allows for easy and quick identification. Each housing is permanently labelled with a laser marking so that each product can be quickly designated and positioned.

Weidmüller RockStar® IP 65 / NEMA Type 4X housings - your first choice for industrial housings with IP 65 protection.

General ordering data

| | | |
|------------|----------------------------|--|
| Type | HDC 40D TOBU 1PG21G | Version |
| Order No. | 1656630000 | HDC enclosures, Size: 6, Protection degree: IP65 (in plugged condition), Cable entry from top, Plug housing, Side-locking clamp on lower side, high, Size of cable entries: PG 21 |
| GTIN (EAN) | 4008190409647 | |
| Qty. | 1 pc(s). | |
| Type | HDC 16B TOBU 1M25G | Version |
| Order No. | 1788210000 | HDC enclosures, Size: 6, Protection degree: IP65 (in plugged condition), Cable entry from top, Plug housing, Side-locking clamp on lower side, Standard, Size of cable entries: M 25 |
| GTIN (EAN) | 4032248205745 | |
| Qty. | 1 pc(s). | |
| Type | HDC 40D TOBU 1PG29G | Version |
| Order No. | 1656650000 | HDC enclosures, Size: 6, Protection degree: IP65 (in plugged condition), Cable entry from top, Plug housing, Side-locking clamp on lower side, high, Size of cable entries: PG 29 |
| GTIN (EAN) | 4008190409661 | |
| Qty. | 1 pc(s). | |
| Type | HDC 40D TOBU 2M25 | Version |
| Order No. | 1208380000 | HDC enclosures, Size: 6, Protection degree: IP65, IP65 (in plugged condition), Cable entry from top, Plug housing, Side-locking clamp on lower side, high, Size of cable entries: M 25 |
| GTIN (EAN) | 4032248100248 | |
| Qty. | 1 pc(s). | |
| Type | HDC 40D TOBU 1M25G | Version |
| Order No. | 1787070000 | HDC enclosures, Size: 6, Protection degree: IP65 (in plugged condition), Cable entry from top, Plug housing, Side-locking clamp on lower side, high, Size of cable entries: M 25 |
| GTIN (EAN) | 4032248204410 | |
| Qty. | 1 pc(s). | |
| Type | HDC 16B TOBU 1PG21G | Version |
| Order No. | 1656590000 | HDC enclosures, Size: 6, Protection degree: IP65 (in plugged condition), Cable entry from top, Plug housing, Side-locking clamp on lower side, Standard, Size of cable entries: PG 21 |
| GTIN (EAN) | 4008190409609 | |
| Qty. | 1 pc(s). | |
| Type | HDC 40D TOBU 1M32G | Version |
| Order No. | 1787060000 | HDC enclosures, Size: 6, Protection degree: IP65 (in plugged condition), Cable entry from top, Plug housing, Side-locking clamp on lower side, high, Size of cable entries: M 32 |
| GTIN (EAN) | 4032248204304 | |
| Qty. | 1 pc(s). | |

HDC 40D SBU 2PG21G**Weidmüller Interface GmbH & Co. KG**

Klingenbergstraße 26

D-32758 Detmold

Germany

www.weidmueller.com

Accessories**Cover**

The special die-cast alloy and the multi-layered surface sealing provide complete protection for the HDC housings.

The cleverly designed interlock system is manufactured from stainless steel. This guarantees a long lifespan with high resistance to corrosion and impact.

The housing interlock system provides integrated safety. Our unique, patented spring system provides the housing interlock with a secure grip and prevents accidental opening.

The laser marking allows for easy and quick identification. Each housing is permanently labelled with a laser marking so that each product can be quickly designated and positioned.

Weidmüller RockStar® IP 65 / NEMA Type 4X housings - your first choice for industrial housings with IP 65 protection.

General ordering data

| Type | HDC 16B DODQ 4B0 | Version |
|------------|----------------------------|--|
| Order No. | 1665260000 | HDC enclosures, Size: 6, Protection degree: IP65 (in plugged condition), Cover for lower part of housing, Side-locking clamp on lower side, Standard |
| GTIN (EAN) | 4008190421960 | |
| Qty. | 1 pc(s). | |

Hood, Cable Entry sideways

The special die-cast alloy and the multi-layered surface sealing provide complete protection for the HDC housings.

The cleverly designed interlock system is manufactured from stainless steel. This guarantees a long lifespan with high resistance to corrosion and impact.

The housing interlock system provides integrated safety. Our unique, patented spring system provides the housing interlock with a secure grip and prevents accidental opening.

The laser marking allows for easy and quick identification. Each housing is permanently labelled with a laser marking so that each product can be quickly designated and positioned.

Weidmüller RockStar® IP 65 / NEMA Type 4X housings - your first choice for industrial housings with IP 65 protection.

General ordering data

| Type | HDC 40D TSBU 1PG21G | Version |
|------------|----------------------------|--|
| Order No. | 1656520000 | HDC enclosures, Size: 6, Protection degree: IP65 (in plugged condition), Cable entry from side, Plug housing, Side-locking clamp on lower side, high, Size of cable entries: PG 21 |
| GTIN (EAN) | 4008190409531 | |
| Qty. | 1 pc(s). | |
| Type | HDC 40D TSBU 1M40G | Version |
| Order No. | 1904800000 | HDC enclosures, Size: 6, Protection degree: IP65 (in plugged condition), Cable entry from side, Plug housing, Side-locking clamp on lower side, high, Size of cable entries: M 40 |
| GTIN (EAN) | 4032248521852 | |
| Qty. | 1 pc(s). | |

HDC 40D SBU 2PG21G

Weidmüller Interface GmbH & Co. KG

Klingenbergstraße 26

D-32758 Detmold

Germany

www.weidmueller.com

Accessories

| | | |
|------------|----------------------------|--|
| Type | HDC 40D TSBU 1M25G | Version |
| Order No. | 1787010000 | HDC enclosures, Size: 6, Protection degree: IP65 (in plugged condition), Cable entry from side, Plug housing, Side-locking clamp on lower side, high, Size of cable entries: M 25 |
| GTIN (EAN) | 4032248204250 | |
| Qty. | 1 pc(s). | |
| Type | HDC 40D TSBU 1M32G | Version |
| Order No. | 1787000000 | HDC enclosures, Size: 6, Protection degree: IP65 (in plugged condition), Cable entry from side, Plug housing, Side-locking clamp on lower side, high, Size of cable entries: M 32 |
| GTIN (EAN) | 4032248204243 | |
| Qty. | 1 pc(s). | |
| Type | HDC 16B TSBU 1M40G | Version |
| Order No. | 1809620000 | HDC enclosures, Size: 6, Protection degree: IP65 (in plugged condition), Cable entry from side, Plug housing, Side-locking clamp on lower side, Standard, Size of cable entries: M 40 |
| GTIN (EAN) | 4032248284979 | |
| Qty. | 1 pc(s). | |
| Type | HDC 16B TSBU 1PG21G | Version |
| Order No. | 1656480000 | HDC enclosures, Size: 6, Protection degree: IP65 (in plugged condition), Cable entry from side, Plug housing, Side-locking clamp on lower side, Standard, Size of cable entries: PG 21 |
| GTIN (EAN) | 4008190409494 | |
| Qty. | 1 pc(s). | |
| Type | HDC 40D TSBU 1PG29G | Version |
| Order No. | 1656540000 | HDC enclosures, Size: 6, Protection degree: IP65 (in plugged condition), Cable entry from side, Plug housing, Side-locking clamp on lower side, high, Size of cable entries: PG 29 |
| GTIN (EAN) | 4008190409555 | |
| Qty. | 1 pc(s). | |
| Type | HDC 16B TSBU 1M25G | Version |
| Order No. | 1788180000 | HDC enclosures, Size: 6, Protection degree: IP65 (in plugged condition), Cable entry from side, Plug housing, Side-locking clamp on lower side, Standard, Size of cable entries: M 25 |
| GTIN (EAN) | 4032248205714 | |
| Qty. | 1 pc(s). | |