

**HDC 16B SBU 2PG21G****Weidmüller Interface GmbH & Co. KG**

Klingenbergstraße 26

D-32758 Detmold

Germany

[www.weidmueller.com](http://www.weidmueller.com)

The special die-cast alloy and the multi-layered surface sealing provide complete protection for the HDC housings.

The cleverly designed interlock system is manufactured from stainless steel. This guarantees a long lifespan with high resistance to corrosion and impact.

The housing interlock system provides integrated safety. Our unique, patented spring system provides the housing interlock with a secure grip and prevents accidental opening.

The laser marking allows for easy and quick identification. Each housing is permanently labelled with a laser marking so that each product can be quickly designated and positioned.

Weidmüller RockStar® IP 65 / NEMA Type 4X housings - your first choice for industrial housings with IP 65 protection.

**General ordering data**

Version	HDC enclosures, Size: 6, Protection degree: IP65 (in plugged condition), Base housing, Side-locking clamp on lower side, Standard, Size of cable entries: PG 21
Order No.	<a href="#">1656730000</a>
Type	HDC 16B SBU 2PG21G
GTIN (EAN)	4008190409746
Qty.	1 pc(s).

**HDC 16B SBU 2PG21G****Weidmüller Interface GmbH & Co. KG**

Klingenbergstraße 26

D-32758 Detmold

Germany

www.weidmueller.com

**Technical data****Dimensions and weights**

Height	64 mm	Height (inches)	2.52 inch
Width	56.5 mm	Width (inches)	2.224 inch
Mounting dimension - height	45 mm	Mounting dimension - width	105 mm
Net weight	352 g		

**Temperatures**

Limit temperature	-40 °C ... 125 °C
-------------------	-------------------

**Dimensions**

Cable entry	w. thread	Height of base B1	5 mm
Height of housing B	64 mm	Hole pitch length A2	105 mm
Total length housing	93.3 mm	Width base C1	56.5 mm
Width housing C	43 mm		

**General data**

EMC housings	No	Housing main material	diecast aluminium
Material of locking element	Stainless steel, rust-proof	Protection degree	IP65 (in plugged condition)
Surface finish	Powder coating		

**Version**

BG	6	Cable entry	w. thread
Clamp version	Side-locking clamp	Colour (RAL)	RAL 7035
Design	Standard	Design of housing	Base housing
Design of locking system	Side-locking clamp on lower side	Internal thread	PG 21
Number of cable entry on top	0	Number of cable entry sideways	2
Sealing	NBR	Size	6
Size of cable entries	PG 21	Suitable for ModuPlug®	No
Top part/bottom part/lid	lower part	Type	Base housing

**Classifications**

ETIM 6.0	EC000437	ETIM 7.0	EC000437
ETIM 8.0	EC000437	ETIM 9.0	EC000437
ECLASS 9.0	27-44-02-02	ECLASS 9.1	27-44-02-02
ECLASS 10.0	27-44-02-02	ECLASS 11.0	27-44-02-02
ECLASS 12.0	27-44-02-02	ECLASS 13.0	27-44-02-02

Substance	Acetone
Chemical resistance	Conditionally resistant
Substance	Drilling oil
Chemical resistance	Resistant
Substance	Diesel
Chemical resistance	Resistant
Substance	Ethyl alcohol
Chemical resistance	Resistant

**HDC 16B SBU 2PG21G****Weidmüller Interface GmbH & Co. KG**

Klingenbergstraße 26

D-32758 Detmold

Germany

[www.weidmueller.com](http://www.weidmueller.com)**Technical data**

Substance	Transmission oil
Chemical resistance	Resistant
Substance	Hydraulic oil
Chemical resistance	Resistant
Substance	Coolant
Chemical resistance	Resistant
Substance	Petroleum benzine
Chemical resistance	Resistant
Substance	Sweat
Chemical resistance	Resistant
Substance	Premium gasoline
Chemical resistance	Conditionally resistant
Substance	Water
Chemical resistance	Resistant
Substance	UV
Chemical resistance	Unstable
Substance	Ozone
Chemical resistance	Unstable

**Environmental Product Compliance**

REACH SVHC	Lead 7439-92-1 Potassium perfluorobutane sulfonate 29420-49-3
SCIP	e98b2b24-ba23-41bf-8d19-Odda3647412f
Chemical resistance	de.myview.objectmodel.impl.BlockImpl@7c69a68b de.myview.objectmodel.impl.BlockImpl@5f9fc206 de.myview.objectmodel.impl.BlockImpl@2d2b0af3 de.myview.objectmodel.impl.BlockImpl@4570a8b7 de.myview.objectmodel.impl.BlockImpl@741c136c de.myview.objectmodel.impl.BlockImpl@5532701b de.myview.objectmodel.impl.BlockImpl@20bb94dc de.myview.objectmodel.impl.BlockImpl@60cea56c de.myview.objectmodel.impl.BlockImpl@745d4d6a de.myview.objectmodel.impl.BlockImpl@32294952 de.myview.objectmodel.impl.BlockImpl@4e4826bf de.myview.objectmodel.impl.BlockImpl@5b380fdf de.myview.objectmodel.impl.BlockImpl@45103fcf

**Approvals**

Approvals



ROHS	Conform
UL File Number Search	UL Website
Certificate No. (cULus)	E92202

## HDC 16B SBU 2PG21G

**Weidmüller Interface GmbH & Co. KG**

Klingenbergstraße 26

D-32758 Detmold

Germany

[www.weidmueller.com](http://www.weidmueller.com)

## Technical data

### Downloads

Approval/Certificate/Document of Conformity

[Manufacturer's declaration](#)

Engineering Data

[CAD data – STEP](#)

Product Change Notification

[20220214 Technical change to HDC housings](#)

[20220214 Technische Änderung bei HDC-Gehäusen](#)

Technical Documentation

[1656730000 HDC\\_16B\\_SBU\\_2PG21G\\_STP\\_Blatt\\_1.pdf](#)

Catalogues

[Catalogues in PDF-format](#)

Brochures

[FL FIELDWIRING EN](#)

[FL FIELDWIRING EN](#)

## HDC 16B SBU 2PG21G

**Weidmüller Interface GmbH & Co. KG**  
Klingenbergstraße 26  
D-32758 Detmold  
Germany

[www.weidmueller.com](http://www.weidmueller.com)

## Drawings

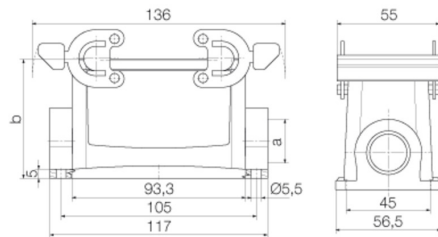

## HDC 16B SBU 2PG21G

Weidmüller Interface GmbH &amp; Co. KG

Klingenbergstraße 26

D-32758 Detmold

Germany

www.weidmueller.com

## Accessories

## Cover



The special die-cast alloy and the multi-layered surface sealing provide complete protection for the HDC housings.

The cleverly designed interlock system is manufactured from stainless steel. This guarantees a long lifespan with high resistance to corrosion and impact.

The housing interlock system provides integrated safety. Our unique, patented spring system provides the housing interlock with a secure grip and prevents accidental opening.

The laser marking allows for easy and quick identification. Each housing is permanently labelled with a laser marking so that each product can be quickly designated and positioned.

Weidmüller RockStar® IP 65 / NEMA Type 4X housings - your first choice for industrial housings with IP 65 protection.

## General ordering data

Type	HDC 16B DODQ 4B0	Version
Order No.	<a href="#">1665260000</a>	HDC enclosures, Size: 6, Protection degree: IP65 (in plugged condition), Cover for lower part of housing, Side-locking clamp on lower side, Standard
GTIN (EAN)	4008190421960	
Qty.	1 pc(s).	

## Hood, Cable Entry sideways



The special die-cast alloy and the multi-layered surface sealing provide complete protection for the HDC housings.

The cleverly designed interlock system is manufactured from stainless steel. This guarantees a long lifespan with high resistance to corrosion and impact.

The housing interlock system provides integrated safety. Our unique, patented spring system provides the housing interlock with a secure grip and prevents accidental opening.

The laser marking allows for easy and quick identification. Each housing is permanently labelled with a laser marking so that each product can be quickly designated and positioned.

Weidmüller RockStar® IP 65 / NEMA Type 4X housings - your first choice for industrial housings with IP 65 protection.

## General ordering data

Type	HDC 40D TSB 1M40G	Version
Order No.	<a href="#">1904800000</a>	HDC enclosures, Size: 6, Protection degree: IP65 (in plugged condition), Cable entry from side, Plug housing, Side-locking clamp on lower side, high, Size of cable entries: M 40
GTIN (EAN)	4032248521852	
Qty.	1 pc(s).	
Type	HDC 40D TSB 1M32G	Version
Order No.	<a href="#">1787000000</a>	HDC enclosures, Size: 6, Protection degree: IP65 (in plugged condition), Cable entry from side, Plug housing, Side-locking clamp on lower side, high, Size of cable entries: M 32
GTIN (EAN)	4032248204243	
Qty.	1 pc(s).	

## HDC 16B SBU 2PG21G

Weidmüller Interface GmbH &amp; Co. KG

Klingenbergstraße 26

D-32758 Detmold

Germany

www.weidmueller.com

## Accessories

Type	HDC 16B TSBU 1M25G	Version
Order No.	<a href="#">1788180000</a>	HDC enclosures, Size: 6, Protection degree: IP65 (in plugged condition), Cable entry from side, Plug housing, Side-locking clamp on lower side, Standard, Size of cable entries: M 25
GTIN (EAN)	4032248205714	
Qty.	1 pc(s).	
Type	HDC 16B TSBU 1M40G	Version
Order No.	<a href="#">1809620000</a>	HDC enclosures, Size: 6, Protection degree: IP65 (in plugged condition), Cable entry from side, Plug housing, Side-locking clamp on lower side, Standard, Size of cable entries: M 40
GTIN (EAN)	4032248284979	
Qty.	1 pc(s).	
Type	HDC 40D TSBU 1PG21G	Version
Order No.	<a href="#">1656520000</a>	HDC enclosures, Size: 6, Protection degree: IP65 (in plugged condition), Cable entry from side, Plug housing, Side-locking clamp on lower side, high, Size of cable entries: PG 21
GTIN (EAN)	4008190409531	
Qty.	1 pc(s).	
Type	HDC 16B TSBU 1PG21G	Version
Order No.	<a href="#">1656480000</a>	HDC enclosures, Size: 6, Protection degree: IP65 (in plugged condition), Cable entry from side, Plug housing, Side-locking clamp on lower side, Standard, Size of cable entries: PG 21
GTIN (EAN)	4008190409494	
Qty.	1 pc(s).	
Type	HDC 40D TSBU 1M25G	Version
Order No.	<a href="#">1787010000</a>	HDC enclosures, Size: 6, Protection degree: IP65 (in plugged condition), Cable entry from side, Plug housing, Side-locking clamp on lower side, high, Size of cable entries: M 25
GTIN (EAN)	4032248204250	
Qty.	1 pc(s).	
Type	HDC 40D TSBU 1PG29G	Version
Order No.	<a href="#">1656540000</a>	HDC enclosures, Size: 6, Protection degree: IP65 (in plugged condition), Cable entry from side, Plug housing, Side-locking clamp on lower side, high, Size of cable entries: PG 29
GTIN (EAN)	4008190409555	
Qty.	1 pc(s).	

## Hood, Cable Entry at top



The special die-cast alloy and the multi-layered surface sealing provide complete protection for the HDC housings.

The cleverly designed interlock system is manufactured from stainless steel. This guarantees a long lifespan with high resistance to corrosion and impact.

The housing interlock system provides integrated safety. Our unique, patented spring system provides the housing interlock with a secure grip and prevents accidental opening.

The laser marking allows for easy and quick identification. Each housing is permanently labelled with a laser marking so that each product can be quickly designated and positioned.

Weidmüller RockStar® IP 65 / NEMA Type 4X housings - your first choice for industrial housings with IP 65 protection.

## General ordering data

Type	HDC 40D TOBU 1M32G	Version
Order No.	<a href="#">1787060000</a>	HDC enclosures, Size: 6, Protection degree: IP65 (in plugged condition), Cable entry from top, Plug housing, Side-locking clamp on lower side, high, Size of cable entries: M 32
GTIN (EAN)	4032248204304	
Qty.	1 pc(s).	
Type	HDC 16B TOBU 1M25G	Version
Order No.	<a href="#">1788210000</a>	HDC enclosures, Size: 6, Protection degree: IP65 (in plugged condition), Cable entry from top, Plug housing, Side-locking clamp on lower side, Standard, Size of cable entries: M 25
GTIN (EAN)	4032248205745	
Qty.	1 pc(s).	

Creation date May 29, 2024 12:17:05 PM CEST

## HDC 16B SBU 2PG21G

Weidmüller Interface GmbH &amp; Co. KG

Klingenbergstraße 26

D-32758 Detmold

Germany

www.weidmueller.com

## Accessories

Type	HDC 40D TOBU 2M25	Version
Order No.	<a href="#">1208380000</a>	HDC enclosures, Size: 6, Protection degree: IP65, IP65 (in plugged condition), Cable entry from top, Plug housing, Side-locking clamp on lower side, high, Size of cable entries: M 25
GTIN (EAN)	4032248100248	
Qty.	1 pc(s).	
Type	HDC 40D TOBU 1PG29G	Version
Order No.	<a href="#">1656650000</a>	HDC enclosures, Size: 6, Protection degree: IP65 (in plugged condition), Cable entry from top, Plug housing, Side-locking clamp on lower side, high, Size of cable entries: PG 29
GTIN (EAN)	4008190409661	
Qty.	1 pc(s).	
Type	HDC 16B TOBU 1PG21G	Version
Order No.	<a href="#">1656590000</a>	HDC enclosures, Size: 6, Protection degree: IP65 (in plugged condition), Cable entry from top, Plug housing, Side-locking clamp on lower side, Standard, Size of cable entries: PG 21
GTIN (EAN)	4008190409609	
Qty.	1 pc(s).	
Type	HDC 40D TOBU 1PG21G	Version
Order No.	<a href="#">1656630000</a>	HDC enclosures, Size: 6, Protection degree: IP65 (in plugged condition), Cable entry from top, Plug housing, Side-locking clamp on lower side, high, Size of cable entries: PG 21
GTIN (EAN)	4008190409647	
Qty.	1 pc(s).	
Type	HDC 40D TOBU 1M25G	Version
Order No.	<a href="#">1787070000</a>	HDC enclosures, Size: 6, Protection degree: IP65 (in plugged condition), Cable entry from top, Plug housing, Side-locking clamp on lower side, high, Size of cable entries: M 25
GTIN (EAN)	4032248204410	
Qty.	1 pc(s).	