

**KSI/-16****Weidmüller Interface GmbH & Co. KG**

Klingenbergstraße 26

D-32758 Detmold

Germany

www.weidmueller.com

**Insulated pin-cable connector made from PVC or PC/PA**

- Conventional designs
- Not soldered
- With conical entry funnel

**General ordering data**

Version	cable lug, terminal end, Insulated cable connector, 16 mm <sup>2</sup> , 16 mm <sup>2</sup>
Order No.	<a href="#">1491440000</a>
Type	KSI/-16
GTIN (EAN)	4050118301427
Qty.	50 pc(s).

**KSI/-16****Weidmüller Interface GmbH & Co. KG**

Klingenbergstraße 26

D-32758 Detmold

Germany

[www.weidmueller.com](http://www.weidmueller.com)**Technical data****Dimensions and weights**

Net weight	4.86 g
------------	--------

**Connectors**

Conductor cross-section	16 mm <sup>2</sup>	Conductor cross-section, max.	16 mm <sup>2</sup>
Identification colour	blue	Inside diameter of collar (d4)	9.1 mm
Inside diameter of shaft (d1)	5.8 mm	Insulation	Available
Length 1 (l1)	40.7 mm	Length 2 (l2)	13.5 mm
Material/plastic	PA	Outside diameter of shaft (d3)	2.5 mm

**Classifications**

ETIM 6.0	EC001059	ETIM 7.0	EC001059
ETIM 8.0	EC001059	ETIM 9.0	EC001059
ECLASS 9.0	27-40-02-92	ECLASS 9.1	27-40-02-12
ECLASS 10.0	27-40-02-92	ECLASS 11.0	27-40-02-92
ECLASS 12.0	27-40-02-92	ECLASS 13.0	27-40-02-92

**Approvals**

ROHS	Conform
------	---------

**Downloads**

Catalogues	<a href="#">Catalogues in PDF-format</a>
Brochures	

## KSI/-16

**Weidmüller Interface GmbH & Co. KG**  
Klingenbergstraße 26  
D-32758 Detmold  
Germany

[www.weidmueller.com](http://www.weidmueller.com)

## Drawings

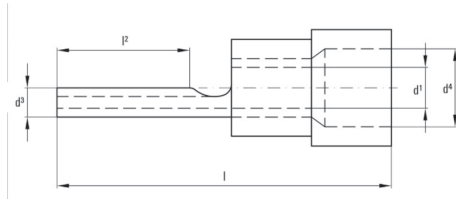

## KSI/-16

Weidmüller Interface GmbH &amp; Co. KG

Klingenbergstraße 26

D-32758 Detmold

Germany

www.weidmueller.com

## Accessories

## Tools

**Crimping tools for cable lugs, connectors and wire-end ferrules with interchangeable inserts**

- extremely fast processing thanks to hydraulic support
- large processing range up to 300 mm<sup>2</sup>
- 270° revolving quick-action crimping head
- automatic pressure limitation and monitoring via pressure sensor
- electronic control and monitoring of the crimping process
- Saving of all crimping cycles and error messages to internal memory
- Reading of all cycles and error messages via USB
- Li-ion rechargeable battery with charge status indicator: 18 V, 2 Ah

## General ordering data

Type	EPG 60	Version
Order No.	<a href="#">2453810000</a>	Pressing tools, Tools, Pressing tool, 6mm <sup>2</sup> , 300mm <sup>2</sup> , Hexagonal crimp,
GTIN (EAN)	4050118468434	WM crimp, Indent crimp, Trapezoidal crimp, Oval crimping
Qty.	1 pc(s).	

## Tools

**Crimping tools for cable lugs, connectors and wire-end ferrules with interchangeable inserts**

- extremely fast processing thanks to hydraulic support
- large processing range up to 400 mm<sup>2</sup>
- 360° revolving quick action crimping head
- automatic pressure limitation and monitoring via pressure sensor
- Additional features for APG series:
- electronic control and monitoring of the crimping process
- Saving of all crimping cycles and error messages to internal memory
- Reading of all cycles and error messages via USB

## General ordering data

Type	HPG 60	Version
Order No.	<a href="#">2453820000</a>	6mm <sup>2</sup> , 300mm <sup>2</sup> , Hexagonal crimp, WM crimp, Indent crimp,
GTIN (EAN)	4050118468427	Trapezoidal crimp, Oval crimping
Qty.	1 pc(s).	