

KSI/1,5-2,5**Weidmüller Interface GmbH & Co. KG**

Klingenbergstraße 26

D-32758 Detmold

Germany

www.weidmueller.com

**Insulated pin-cable connector made from PVC or PC/PA**

- Conventional designs
- Not soldered
- With conical entry funnel

General ordering data

Version	cable lug, terminal end, Insulated cable connector, 2.5 mm ² , 1.5 mm ² - 2.5 mm ²
Order No.	1491390000
Type	KSI/1,5-2,5
GTIN (EAN)	4050118301458
Qty.	100 pc(s).

KSI/1,5-2,5**Weidmüller Interface GmbH & Co. KG**

Klingenbergstraße 26

D-32758 Detmold

Germany

www.weidmueller.com**Technical data****Dimensions and weights**

Net weight	0.89 g
------------	--------

Connectors

Conductor cross-section	2.5 mm ²	Conductor cross-section, max.	2.5 mm ²
Conductor cross-section, min.	1.5 mm ²	Identification colour	blue
Inside diameter of collar (d4)	4.5 mm	Inside diameter of shaft (d1)	2.3 mm
Insulation	Available	Length 1 (l1)	22.8 mm
Length 2 (l2)	11 mm	Material/plastic	PC
Outside diameter of shaft (d3)	1.9 mm		

Classifications

ETIM 6.0	EC001059	ETIM 7.0	EC001059
ETIM 8.0	EC001059	ETIM 9.0	EC001059
ECLASS 9.0	27-40-02-92	ECLASS 9.1	27-40-02-12
ECLASS 10.0	27-40-02-92	ECLASS 11.0	27-40-02-92
ECLASS 12.0	27-40-02-92	ECLASS 13.0	27-40-02-92

Approvals

ROHS	Conform
------	---------

Downloads

Catalogues	Catalogues in PDF-format
------------	--

KSI/1,5-2,5

Weidmüller Interface GmbH & Co. KG
Klingenbergstraße 26
D-32758 Detmold
Germany

www.weidmueller.com

Drawings

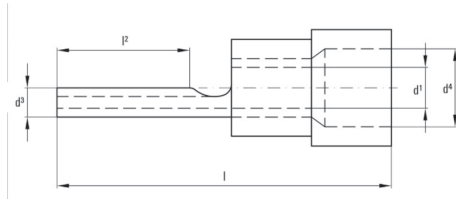

KSI/1,5-2,5**Weidmüller Interface GmbH & Co. KG**

Klingenbergstraße 26

D-32758 Detmold

Germany

www.weidmueller.com**Accessories****Crimping tools****Crimping tools for insulated connectors**

cable lugs, terminal pins, parallel and serial connectors, plug-in connectors

- Ratchet guarantees precise crimping
- Release option in the event of incorrect operation
- With stop for exact positioning of the contacts.
- Tested to DIN EN 60352 part 2

General ordering data

Type	CTI 6	Version
Order No.	9006120000	Pressing tool, Crimping tool for contacts, 0.5mm ² , 6mm ² , Oval
GTIN (EAN)	4008190044527	crimping, Double crimp
Qty.	1 pc(s).	
Type	CTI 6 G	Version
Order No.	9202850000	Pressing tool, Tool for insulated cable connectors, 0.5mm ² , 6mm ² ,
GTIN (EAN)	4032248517855	Oval crimping, Parallel crimp
Qty.	1 pc(s).	
Type	HTI 15	Version
Order No.	9014400000	Pressing tool, Tool for insulated cable connectors, 0.5mm ² , 2.5mm ² ,
GTIN (EAN)	4008190159412	Double crimp
Qty.	1 pc(s).	