

IE-FCI-PWB-CH**Weidmüller Interface GmbH & Co. KG**

Klingenbergstraße 26

D-32758 Detmold

Germany

www.weidmueller.com

FrontCom® Vario integrates multiple functions in only one single frame. The system is easy to install and you can select from a wide range of data, signal and power modules. In addition to being extremely compact, FrontCom® Vario offers a number of unique product features that will make your project planning and work activities secure, fast and future-proof. Furthermore, the FrontCom® Vario system has an attractive housing design that, by the way, offers highest impact-resistance and fully meets the requirements of IP 65 protection class.

General ordering data

Version	FrontCom, Insert Power large, Type J, Socket connector, CH
Order No.	1450780000
Type	IE-FCI-PWB-CH
GTIN (EAN)	4050118255553
Qty.	1 pc(s).

IE-FCI-PWB-CH

Weidmüller Interface GmbH & Co. KG

Klingenbergstraße 26

D-32758 Detmold

Germany

www.weidmueller.com

Technical data

Dimensions and weights

Net weight	25 g
------------	------

Temperatures

Storage temperature	-10 °C...70 °C	Operating temperature	-5 °C...40 °C
---------------------	----------------	-----------------------	---------------

General data

Connector face	Type J	Fire load	770 kJ
Insert type	Insert Power large	Protection degree	IP20

Clampable conductors

Conductor connection cross-section, extremely flexible with wire end ferrule 1.5 ... 1.5 mm²

Conductor connection cross-section, extremely flexible with wire end ferrule	min.	1.5 mm ²
	max.	1.5 mm ²

Conductor connection cross-section, extremely flexible without wire end ferrule	max.	2.5 mm ²
	min.	1.5 mm ²

Conductor connection cross-section, extremely flexible without wire end ferrule 1.5 ... 2.5 mm²

Conductor connection cross-section, flexible with wire end ferrule 1.5 ... 1.5 mm²

Conductor connection cross-section, flexible with wire end ferrule	min.	1.5 mm ²
	max.	1.5 mm ²

Conductor connection cross-section, flexible without wire end ferrule 1.5 ... 2.5 mm²

Conductor connection cross-section, flexible without wire end ferrule	max.	2.5 mm ²
	min.	1.5 mm ²

Conductor connection cross-section, rigid 1.5 ... 2.5 mm²

Conductor connection cross-section, rigid	min.	1.5 mm ²
	max.	2.5 mm ²

Stripping length 10 mm

Type of connection PUSH IN

Technical data

Housing main material	Polycarbonate PC	Rated current	10 A
Rated voltage (AC)	250 V		

General standards

Certificate No. (DNV)	TAA000022B
-----------------------	------------

Classifications

ETIM 6.0	EC001121	ETIM 7.0	EC001121
ETIM 8.0	EC001121	ETIM 9.0	EC001121
ECLASS 9.0	27-44-03-90	ECLASS 9.1	27-18-90-90
ECLASS 10.0	27-44-03-90	ECLASS 11.0	27-44-03-90
ECLASS 12.0	27-18-28-92	ECLASS 13.0	27-18-28-92

IE-FCI-PWB-CH**Weidmüller Interface GmbH & Co. KG**

Klingenbergstraße 26

D-32758 Detmold

Germany

www.weidmueller.com**Technical data****Approvals**

Approvals



ROHS

Conform

DownloadsApproval/Certificate/Document of Con-
formity[GL FrontCom](#)

Engineering Data

[CAD data – STEP](#)

User Documentation

[MAN IE GUIDE DE](#)[MAN IE GUIDE EN](#)[Socket Insert Overview EN](#)[Socket Insert Overview DE](#)[Designation key / Type key](#)

Catalogues

[Catalogues in PDF-format](#)

Brochures

[MB FREECONCONTACT EN](#)[FL FIELDWIRING EN](#)[PI PROFINET CABLING EN](#)[PI PROFINET CABLING EN](#)

IE-FCI-PWB-CH

Weidmüller Interface GmbH & Co. KG
Klingenbergstraße 26
D-32758 Detmold
Germany

www.weidmueller.com

Drawings

Dimensioned drawing

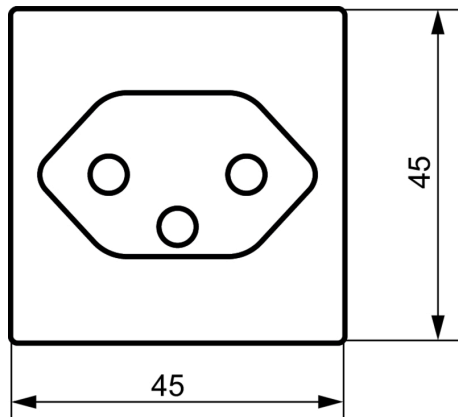

Dimensioned drawing

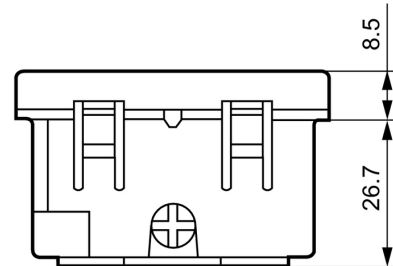

IE-FCI-PWB-CH

Weidmüller Interface GmbH & Co. KG
Klingenbergstraße 26
D-32758 Detmold
Germany

www.weidmueller.com

Accessories

Rail adaptor for socket inserts



At Weidmüller you can get everything you need from one source - including accessories for Industrial Ethernet.

The benefits for you:

- tools
- testing instruments
- cable bushings
- cabinet connections
- markers
- dust protection
- power packs
- overvoltage protection

General ordering data

Type	IE-DINRAIL-AD-PWB
Order No.	2534680000
GTIN (EAN)	4050118546354
Qty.	1 pc(s).