

**IE-PS-V05M-RJ45-FH-B****Weidmüller Interface GmbH & Co. KG**

Klingenbergstraße 26

D-32758 Detmold

Germany

[www.weidmueller.com](http://www.weidmueller.com)

HDC plug-in connector set according to IEC 61076-3-106  
ver.5 in metal, with RJ45 insert

**General ordering data**

Version	RJ45 plug, no tools required, Cat.6 <sub>A</sub> / Class E <sub>A</sub> (ISO/IEC 11801 2010)
Order No.	<a href="#">1271250000</a>
Type	IE-PS-V05M-RJ45-FH-B
GTIN (EAN)	4050118060034
Qty.	10 pc(s).

**IE-PS-V05M-RJ45-FH-B****Weidmüller Interface GmbH & Co. KG**

Klingenbergstraße 26

D-32758 Detmold

Germany

www.weidmueller.com

**Technical data****Dimensions and weights**

Net weight	93.3 g
------------	--------

**General data**

Connection 1	RJ45	Connection 2	IDC
Colour	black	Housing main material	diecast aluminium
Insulation cross-section, min.	0.85 mm	Insulation cross-section, max.	1.6 mm
Category	Cat.6A / Class E <sub>A</sub> (ISO/IEC 11801 2010)	Contact surface	Gold over nickel
Connection diameter, solid	0.4...0.64 mm	Conductor connection cross-section, solid (AWG)	AWG 24...AWG 22
Connection diameter, flexible	0.48...0.76 mm	Conductor connection cross-section, flexible (AWG)	AWG 26...AWG 22
MICE classification M	M <sub>3</sub>	MICE classification I	I <sub>3</sub>
MICE classification C	C <sub>1</sub>	MICE classification E	E <sub>3</sub>
Sheath diameter, min.	5 mm	Sheath diameter, max.	12 mm
Shielding	360°; shield contact	Protection degree	IP67
Plugging cycles	750	Ability to reconnect	≥ 10 cycles (for the same or larger cross-section)

**Electrical properties**

Dielectric strength, contact / contact	≥ 1000 V AC/DC	Dielectric strength, contact / shield	≥ 1500 V AC/DC
--	----------------	---------------------------------------	----------------

**General standards**

Application-specific communication cable facilities	PROFINET installation instructions
---	------------------------------------

**Classifications**

ETIM 6.0	EC001121	ETIM 7.0	EC001121
ETIM 8.0	EC001121	ETIM 9.0	EC001121
ECLASS 9.0	27-44-03-90	ECLASS 9.1	27-44-03-90
ECLASS 10.0	27-44-03-90	ECLASS 11.0	27-44-03-90
ECLASS 12.0	27-44-03-90	ECLASS 13.0	27-44-03-90
ECLASS 14.0	27-44-03-90		

**Environmental Product Compliance**

REACH SVHC	Lead 7439-92-1
SCIP	4f3aae94-c2bc-4010-b63b-5b114ba6bd55
RoHS Compliance Status	Compliant with exemption
RoHS Exemption (if applicable/known)	6bl, 6c

**Approvals**

ROHS	Conform
------	---------

## IE-PS-V05M-RJ45-FH-B

**Weidmüller Interface GmbH & Co. KG**

Klingenbergstraße 26

D-32758 Detmold

Germany

[www.weidmueller.com](http://www.weidmueller.com)

## Technical data

### Downloads

Engineering Data	<a href="#">CAD data – STEP</a>
User Documentation	<a href="#">MAN IE GUIDE DE</a> <a href="#">MAN IE GUIDE EN</a> <a href="#">Designation key / Type key</a> <a href="#">Manual</a>
Catalogues	<a href="#">Catalogues in PDF-format</a>
Brochures	<a href="#">MB FREECONCONTACT EN</a> <a href="#">FL FIELDWIRING EN</a> <a href="#">PI PROFINET CABLING EN</a> <a href="#">FL FIELDWIRING EN</a> <a href="#">PI PROFINET CABLING EN</a>

## IE-PS-V05M-RJ45-FH-B

**Weidmüller Interface GmbH & Co. KG**  
Klingenbergstraße 26  
D-32758 Detmold  
Germany

[www.weidmueller.com](http://www.weidmueller.com)

# Drawings

## Dimensioned drawing

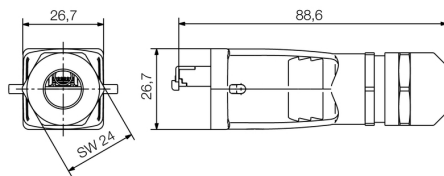

**IE-PS-V05M-RJ45-FH-B****Weidmüller Interface GmbH & Co. KG**

Klingenbergstraße 26

D-32758 Detmold

Germany

[www.weidmueller.com](http://www.weidmueller.com)**Accessories****Dust caps**

For protecting your devices against dust and dirt.

**General ordering data**

Type	IE-PP-V05M	Version
Order No.	<a href="#">1968920000</a>	Flange-mounted housing, protective cap
GTIN (EAN)	4032248692668	
Qty.	1 pc(s).	