

IE-C5ES8UG0005M40M40-G**Weidmüller Interface GmbH & Co. KG**

Klingenbergstraße 26

D-32758 Detmold

Germany

www.weidmueller.com

Assembled cables, patch cable Cabinet Line, Cat. 5, PUR, green

General ordering data

| | |
|------------|---|
| Version | System cable, RJ45 IP 20, RJ45 IP 20, Cat.5 (ISO/IEC 11801), PUR, 0.5 m |
| Order No. | 1166000005 |
| Type | IE-C5ES8UG0005M40M40-G |
| GTIN (EAN) | 4032248956524 |
| Qty. | 1 pc(s). |

IE-C5ES8UG0005M40M40-G

Weidmüller Interface GmbH & Co. KG

Klingenbergstraße 26

D-32758 Detmold

Germany

www.weidmueller.com

Technical data

Dimensions and weights

| | | | |
|------------|-------|-----------------|-------------|
| Length | 0.5 m | Length (inches) | 19.685 inch |
| Net weight | 36 g | | |

Temperatures

| | | | |
|-----------------------|----------------|--------------------------|----------------|
| Operating temperature | -40 °C...85 °C | Installation temperature | -10 °C...60 °C |
|-----------------------|----------------|--------------------------|----------------|

Electrical properties

| | |
|------------|----------------------------|
| PoE / PoE+ | conforming to IEEE 802.3at |
|------------|----------------------------|

General standards

| | | | |
|-------------------------|---------|--------------------|----------------|
| Certificate no. (cULus) | E316369 | Connector standard | IEC 60603-7-51 |
|-------------------------|---------|--------------------|----------------|

Standards

| | |
|--------------------|----------------|
| Connector standard | IEC 60603-7-51 |
|--------------------|----------------|

Cable structure

| | | | |
|---------------------------|---|---------------------------------------|--|
| Arrangement of wire cores | | Colour sequence or wires - wire pairs | white/blue - blue, white/ orange - orange, white/ green - green, white/ brown - brown |
| | Twisted pair | | |
| Complete shielding | Shielding braid made from copper wiring | Cross-section | 4*2*AWG 26/7 - 4*2*0.128 mm ² |
| Insulation | PE | Insulation cross-section | 0.98 mm |
| Material sheath | PUR | Number of wires | 8 |
| Sheath diameter, max. | 6 mm | Sheath diameter, min. | 5.6 mm |
| Sheathing colour | green | Shielding | SF/UTP |
| Strands | 7 | Wire material | Stranded tin-plated copper wire |
| Wire pair shielding | Aluminium foil | | |

Electrical properties of cable

| | | | |
|-------------------|----------------------------|--------------------------------|-----------------|
| Category | Cat.5 (ISO/IEC 11801) | Test voltage: wire-wire-shield | 750 V DC, 1 min |
| Transmission rate | 10/100 MBit/s, 1000 MBit/s | | |

Mechanical and material properties of cable

| | | | |
|--------------------------------|--------------------|---------------------------------|--|
| Abrasion resistance | very good | Halogen | halogen-free, according to IEC 60754-2 |
| Min. bending radius, once only | 5 x cable diameter | Min. bending radius, repetitive | 10 x cable diameter |
| Resistance to oils | EN 50305 | Resistance to spread of flame | in accordance with IEC 60332-1 |
| Silicone-free | Yes | UV-resistant | Yes |

Plug

| | | | |
|-----------|---|------------|---|
| Plug left | RJ45, IP20, male contact, straight, plug, Plastic, shielded | Plug right | RJ45, IP20, male contact, straight, plug, Plastic, shielded |
|-----------|---|------------|---|

Creation date November 3, 2024 11:33:19 PM CET

Catalogue status 26.10.2024 / We reserve the right to make technical changes.

IE-C5ES8UG0005M40M40-G**Weidmüller Interface GmbH & Co. KG**

Klingenbergstraße 26

D-32758 Detmold

Germany

www.weidmueller.com**Technical data****Plug, left**

| | |
|-----------|---|
| Plug left | RJ45, IP20, male contact, straight, plug, Plastic, shielded |
|-----------|---|

Plug, right

| | |
|------------|---|
| Plug right | RJ45, IP20, male contact, straight, plug, Plastic, shielded |
|------------|---|

Classifications

| | | | |
|-------------|-------------|-------------|-------------|
| ETIM 6.0 | EC002599 | ETIM 7.0 | EC002599 |
| ETIM 8.0 | EC002599 | ETIM 9.0 | EC002599 |
| ECLASS 9.0 | 27-06-03-08 | ECLASS 9.1 | 27-06-03-08 |
| ECLASS 10.0 | 27-06-03-08 | ECLASS 11.0 | 27-06-03-08 |
| ECLASS 12.0 | 27-06-03-08 | ECLASS 13.0 | 27-06-03-08 |
| ECLASS 14.0 | 27-06-03-08 | | |

Environmental Product Compliance

| | |
|------------------------|-----------------------------|
| RoHS Compliance Status | Compliant without exemption |
| REACH SVHC | No SVHC above 0.1 wt% |

Approvals

Approvals



| | |
|-------------------------|------------|
| ROHS | Conform |
| UL File Number Search | UL Website |
| Certificate no. (cULus) | E316369 |

Downloads

| | |
|-----------------------------|---|
| Engineering Data | CAD data – STEP |
| Product Change Notification | PCN-PB47-20180213-00-A_EN PCN-PB47-20180213-00-A_DE |
| User Documentation | MAN IE GUIDE DE MAN IE GUIDE EN |
| Catalogues | Catalogues in PDF-format |
| Brochures | FL FIELDWIRING EN PI PROFINET CABLING EN PI PROFINET CABLING EN |

IE-C5ES8UG0005M40M40-G

Weidmüller Interface GmbH & Co. KG
Klingenbergstraße 26
D-32758 Detmold
Germany

www.weidmueller.com

Drawings**Wiring**

| | | | | |
|------|---|---------------|---|------|
| RJ45 | 1 | white, orange | 1 | RJ45 |
| | 2 | orange | 2 | |
| | 3 | white, green | 3 | |
| | 4 | blue | 4 | |
| | 5 | white, blue | 5 | |
| | 6 | green | 6 | |
| | 7 | white, brown | 7 | |
| | 8 | brown | 8 | |

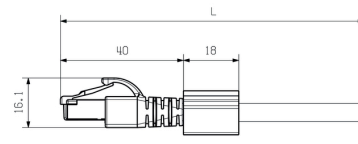
Dimensioned drawing

IE-C5ES8UG0005M40M40-G**Weidmüller Interface GmbH & Co. KG**

Klingenbergstraße 26

D-32758 Detmold

Germany

www.weidmueller.com**Accessories****Blank**

TM-I is an acknowledged and accredited marker type for traffic engineering applications. There are various different tag lengths available for individual labelling with long character strings. Easy handling of separation and installation thanks to the project marker field. Pre-attachment of sleeves and retrofitting of tags offer excellent versatility

The special contour of TM-I allows easy assembly and secures firm positioning. They are compatible with a number of commercially available sleeves. Thanks to the MultiCard format, the tags can be printed quickly and conveniently with the PrintJet CONNECT, plotter or the STI pen.

- Easy handling of separation and installation thanks to the project marker field.
- Acknowledged and accredited marker for traffic engineering applications
- Pre-attachment of sleeves and retrofitting of tags offer excellent versatility
- Not suited for labelling with P-Ink or STI pen in connection with CLI T sleeves

For custom printing: Please send us a file of our labeling software M-Print PRO or M-Print PRO Online (without installation) for your labeling specifications.

General ordering data

| | | |
|------------|----------------------------|--|
| Type | TM-I 12 MC NE WS | Version |
| Order No. | 1718411044 | TM-I, Insert markers, 12 x 4 mm, white |
| GTIN (EAN) | 4008190348977 | |
| Qty. | 320 pc(s). | |

IE-C5ES8UG0005M40M40-G**Weidmüller Interface GmbH & Co. KG**

Klingenbergstraße 26

D-32758 Detmold

Germany

www.weidmueller.com**Accessories****Blank**

TM-I is an acknowledged and accredited marker type for traffic engineering applications. There are various different tag lengths available for individual labelling with long character strings. Easy handling of separation and installation thanks to the project marker field. Pre-attachment of sleeves and retrofitting of tags offer excellent versatility

The special contour of TM-I allows easy assembly and secures firm positioning. They are compatible with a number of commercially available sleeves. Thanks to the MultiCard format, the tags can be printed quickly and conveniently with the PrintJet CONNECT, plotter or the STI pen.

- Easy handling of separation and installation thanks to the project marker field.
- Acknowledged and accredited marker for traffic engineering applications
- Pre-attachment of sleeves and retrofitting of tags offer excellent versatility
- Not suited for labelling with P-Ink or STI pen in connection with CLI T sleeves

For custom printing: Please send us a file of our labeling software M-Print PRO or M-Print PRO Online (without installation) for your labeling specifications.

General ordering data

| | | |
|------------|----------------------------|--|
| Type | TM-I 18 MC NE WS | Version |
| Order No. | 1718431044 | TM-I, Insert markers, 18 x 4 mm, white |
| GTIN (EAN) | 4008190349011 | |
| Qty. | 320 pc(s). | |