

**HDC IP68 06B TOS 1M40****Weidmüller Interface GmbH & Co. KG**

Klingenbergstraße 26

D-32758 Detmold

Germany

[www.weidmueller.com](http://www.weidmueller.com)**IP68**

The new RockStar® enclosures are resistant to seawater and offer a high degree of shock resistance, meet IP 68 and IP 69K, and have been developed for use under extreme environmental conditions and designed for the high vibration requirements acc. to DIN EN 61373 cat. 2 (bogie). As such, this housing family is ideally suited for fault- and maintenance-free operation of heavy-duty connectors in transport and traffic engineering as well as in power engineering and in applications with extreme requirements. During development, measures were also implemented to make the enclosures extremely EMC-resistant.

**General ordering data**

|            |   |
|------------|---|
| Version    | HDC enclosures, Size: 3, Protection degree: IP66 (in plugged condition), IP68 (in plugged condition), Plug housing, Clamping yoke connection, Standard, Size of cable entries: M 40 |
| Order No.  | <a href="#">1082450000</a>  |
| Type       | HDC IP68 06B TOS 1M40   |
| GTIN (EAN) | 4032248845378   |
| Qty.       | 1 pc(s).  |

Creation date June 15, 2024 11:46:44 AM CEST

Catalogue status 01.06.2024 / We reserve the right to make technical changes.

## HDC IP68 06B TOS 1M40

Weidmüller Interface GmbH &amp; Co. KG

Klingenbergstraße 26

D-32758 Detmold

Germany

www.weidmueller.com

## Technical data

## Dimensions and weights

|            |        |                 |            |
|------------|--------|-----------------|------------|
| Height     | 100 mm | Height (inches) | 3.937 inch |
| Width      | 58 mm  | Width (inches)  | 2.283 inch |
| Net weight | 438 g  |                 |            |

## Temperatures

|                   |                   |
|-------------------|-------------------|
| Limit temperature | -50 °C ... 125 °C |
|-------------------|-------------------|

## Dimensions

|                      |           |                     |        |
|----------------------|-----------|---------------------|--------|
| Cable entry          | w. thread | Height of housing B | 100 mm |
| Total length housing | 132 mm    |                     |        |

## General data

|                             |                             |                       |  |
|-----------------------------|-----------------------------|-----------------------|--|
| EMC housings                | Yes                         | Housing main material | diecast aluminium  |
| Material of locking element |                             | Protection degree     | IP66 (in plugged condition), IP68 (in plugged condition) |
|                             | Stainless steel, rust-proof |                       |  |
| Surface finish              | Powder coating              | Tightening torque     | 6.5 Nm   |

## Version

|                              |                          |                                |                    |
|------------------------------|--------------------------|--------------------------------|--------------------|
| BG                           | 3                        | Cable entry                    | w. thread          |
| Clamp version                | Clamping yoke connection | Colour (RAL)                   | RAL 9011, RAL 9005 |
| Design                       | Standard                 | Design of housing              | Plug housing       |
| Design of locking system     | Clamping yoke connection | Internal thread                | M 40               |
| Number of cable entry on top | 1                        | Number of cable entry sideways | 0                  |
| Size                         | 3                        | Size of cable entries          | M 40               |
| Suitable for ModuPlug®       | Yes                      | Tightening torque              | 6.5 Nm             |
| Top part/bottom part/lid     | upper part               | Type                           | Plug               |

## Classifications

|             |             |             |             |
|-------------|-------------|-------------|-------------|
| ETIM 6.0    | EC000437    | ETIM 7.0    | EC000437    |
| ETIM 8.0    | EC000437    | ETIM 9.0    | EC000437    |
| ECLASS 9.0  | 27-44-02-02 | ECLASS 9.1  | 27-44-02-02 |
| ECLASS 10.0 | 27-44-02-02 | ECLASS 11.0 | 27-44-02-02 |
| ECLASS 12.0 | 27-44-02-02 | ECLASS 13.0 | 27-44-02-02 |

|                     |                         |
|---------------------|-------------------------|
| Substance           | Acetone                 |
| Chemical resistance | Resistant               |
| Substance           | Diesel oil              |
| Chemical resistance | Unstable                |
| Substance           | Ethyl alcohol           |
| Chemical resistance | Resistant               |
| Substance           | Transmission oil        |
| Chemical resistance | Conditionally resistant |
| Substance           | Hydraulic oil           |
| Chemical resistance | Conditionally resistant |

## HDC IP68 06B TOS 1M40

Weidmüller Interface GmbH &amp; Co. KG

Klingenbergstraße 26

D-32758 Detmold

Germany

www.weidmueller.com

## Technical data

|                     |                         |
|---------------------|-------------------------|
| Substance           | Petroleum benzine       |
| Chemical resistance | Unstable                |
| Substance           | Sweat                   |
| Chemical resistance | Conditionally resistant |
| Substance           | Premium gasoline        |
| Chemical resistance | Unstable                |
| Substance           | Water                   |
| Chemical resistance | Resistant               |
| Substance           | UV                      |
| Chemical resistance | Resistant               |
| Substance           | Ozone                   |
| Chemical resistance | Resistant               |

## Approvals

Approvals



ROHS

Conform

## Downloads

Approval/Certificate/Document of Conformity

[Manufacturer's declaration](#)

Engineering Data

[CAD data – STEP](#)

Product Change Notification

[20220214 Technical change to HDC housings](#)[20220214 Technische Änderung bei HDC-Gehäusen](#)

Catalogues

[Catalogues in PDF-format](#)

Brochures

[FL FIELDWIRING EN](#)[FL FIELDWIRING EN](#)

### HDC IP68 06B TOS 1M40

**Weidmüller Interface GmbH & Co. KG**

Klingenbergstraße 26

D-32758 Detmold

Germany

[www.weidmueller.com](http://www.weidmueller.com)

## Drawings

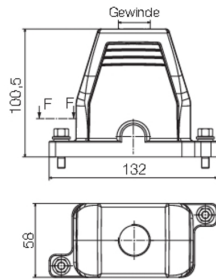

**HDC IP68 06B TOS 1M40****Weidmüller Interface GmbH & Co. KG**

Klingenbergstraße 26

D-32758 Detmold

Germany

[www.weidmueller.com](http://www.weidmueller.com)**Accessories****Screws**

We offer a variety of accessories, including screws, that fit to the heavy-duty connectors.

**General ordering data**

|            |                            |  |
|------------|----------------------------|--|
| Type       | HDC IP68 SCREW SET         | Version  |
| Order No.  | <a href="#">2555340000</a> | Heavy-duty connectors, Accessories, Set of fixings |
| GTIN (EAN) | 4050118571332              |  |
| Qty.       | 10 pc(s).                  |  |

**Socket wrench sets**

Allen key made from fully hardened, high-alloy chromium-vanadium- steel, acc. to DIN ISO 2936 L (DIN 911), high-quality refined surface.

**General ordering data**

|            |                            |               |
|------------|----------------------------|---------------|
| Type       | SK WSD-S 1,5-10,0          | Version       |
| Order No.  | <a href="#">9008850000</a> | Mounting tool |
| GTIN (EAN) | 4032248266609              |               |
| Qty.       | 1 pc(s).                   |               |