

**HDC 10A ALU SL****Weidmüller Interface GmbH & Co. KG**

Klingenbergstraße 26

D-32758 Detmold

Germany

[www.weidmueller.com](http://www.weidmueller.com)**IP65**

The special die-cast alloy and the multi-layered surface sealing provide complete protection for the HDC housings.

The cleverly designed interlock system is manufactured from stainless steel. This guarantees a long lifespan with high resistance to corrosion and impact.

The housing interlock system provides integrated safety. Our unique, patented spring system provides the housing interlock with a secure grip and prevents accidental opening.

The laser marking allows for easy and quick identification. Each housing is permanently labelled with a laser marking so that each product can be quickly designated and positioned.

Weidmüller RockStar® IP 65 / NEMA Type 4X housings - your first choice for industrial housings with IP 65 protection.

**General ordering data**

Version	HDC enclosures, Size: 2, Protection degree: IP65 (in plugged condition), Bulkhead housing, End-locking clamp, lower side, Standard
Order No.	<a href="#">1021450000</a>
Type	HDC 10A ALU SL
GTIN (EAN)	4032248734962
Qty.	1 pc(s).

## HDC 10A ALU SL

Weidmüller Interface GmbH &amp; Co. KG

Klingenbergstraße 26

D-32758 Detmold

Germany

www.weidmueller.com

## Technical data

## Dimensions and weights

Depth	84 mm	Depth (inches)	3.307 inch
Height	26 mm	Height (inches)	1.024 inch
Width	52.5 mm	Width (inches)	2.067 inch
Mounting dimension - height	17.5 mm	Mounting dimension - width	70 mm
Net weight	69 g		

## Temperatures

Limit temperature	-40 °C ... 125 °C
-------------------	-------------------

## Dimensions

Height of base B1	5 mm	Height of housing B	26 mm
Hole pitch length A2	70 mm	Total length housing	63 mm
Width base C1	33 mm	Width housing C	29.5 mm

## General data

EMC housings	No	Housing main material	diecast aluminium
Material of locking element	Stainless steel, rust-proof	Protection degree	IP65 (in plugged condition)
Surface finish	Powder coating	Tightening torque	0.5 Nm

## Version

BG	2	Clamp version	End-locking clamp
Colour (RAL)	RAL 7035	Design	Standard
Design of housing	Bulkhead housing	Design of locking system	End-locking clamp, lower side
Sealing	NBR	Size	2
Suitable for ModuPlug®	No	Tightening torque	0.5 Nm
Top part/bottom part/lid	lower part	Type	Bulkhead (feed-through)

## Classifications

ETIM 6.0	EC000437	ETIM 7.0	EC000437
ETIM 8.0	EC000437	ETIM 9.0	EC000437
ECLASS 9.0	27-44-02-02	ECLASS 9.1	27-44-02-02
ECLASS 10.0	27-44-02-02	ECLASS 11.0	27-44-02-02
ECLASS 12.0	27-44-02-02	ECLASS 13.0	27-44-02-02
ECLASS 14.0	27-44-02-02		

Substance	Acetone
Chemical resistance	Conditionally resistant
Substance	Drilling oil
Chemical resistance	Resistant
Substance	Diesel
Chemical resistance	Resistant
Substance	Ethyl alcohol
Chemical resistance	Resistant
Substance	Transmission oil

## HDC 10A ALU SL

Weidmüller Interface GmbH &amp; Co. KG

Klingenbergstraße 26

D-32758 Detmold

Germany

www.weidmueller.com

## Technical data

Chemical resistance	Resistant
Substance	Hydraulic oil
Chemical resistance	Resistant
Substance	Coolant
Chemical resistance	Resistant
Substance	Petroleum benzine
Chemical resistance	Resistant
Substance	Sweat
Chemical resistance	Resistant
Substance	Premium gasoline
Chemical resistance	Conditionally resistant
Substance	Water
Chemical resistance	Resistant
Substance	UV
Chemical resistance	Unstable
Substance	Ozone
Chemical resistance	Unstable

## Environmental Product Compliance

REACH SVHC	Lead 7439-92-1
SCIP	d447edfa-0214-4f34-b5ba-82eae491b46a
Chemical resistance	de.myview.objectmodel.impl.BlockImpl@6fdf4249 de.myview.objectmodel.impl.BlockImpl@61f32b25 de.myview.objectmodel.impl.BlockImpl@3f859d7c de.myview.objectmodel.impl.BlockImpl@369773c0 de.myview.objectmodel.impl.BlockImpl@23cfa251 de.myview.objectmodel.impl.BlockImpl@5b1d0f0e de.myview.objectmodel.impl.BlockImpl@48e0176c de.myview.objectmodel.impl.BlockImpl@45e474c3 de.myview.objectmodel.impl.BlockImpl@1b679b04 de.myview.objectmodel.impl.BlockImpl@28b19219 de.myview.objectmodel.impl.BlockImpl@6022bb14 de.myview.objectmodel.impl.BlockImpl@68689bf de.myview.objectmodel.impl.BlockImpl@219e8dd0
RoHS Compliance Status	Compliant with exemption
RoHS Exemption (if applicable/known)	6bl

## Important note

Product information	When mounting the housings, make sure that the flat gasket is correctly seated.
---------------------	---

## Approvals

Approvals



ROHS	Conform
------	---------

## HDC 10A ALU SL

**Weidmüller Interface GmbH & Co. KG**

Klingenbergstraße 26

D-32758 Detmold

Germany

[www.weidmueller.com](http://www.weidmueller.com)

## Technical data

### Downloads

Approval/Certificate/Document of Con-  
formity

[Manufacturer's declaration](#)

Engineering Data

[CAD data – STEP](#)

Product Change Notification

[20220214 Technical change to HDC housings](#)

[20220214 Technische Änderung bei HDC-Gehäusen](#)

Catalogues

[Catalogues in PDF-format](#)

Brochures

[FL FIELDWIRING EN](#)

[FL FIELDWIRING EN](#)

## HDC 10A ALU SL

**Weidmüller Interface GmbH & Co. KG**  
Klingenbergstraße 26  
D-32758 Detmold  
Germany

[www.weidmueller.com](http://www.weidmueller.com)

## Drawings

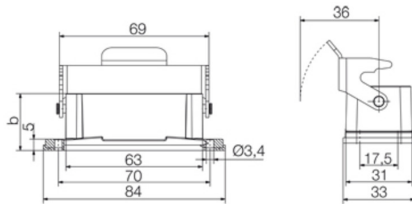

**HDC 10A ALU SL****Weidmüller Interface GmbH & Co. KG**

Klingenbergstraße 26

D-32758 Detmold

Germany

[www.weidmueller.com](http://www.weidmueller.com)**Accessories****Cover**

The special die-cast alloy and the multi-layered surface sealing provide complete protection for the HDC housings.

The cleverly designed interlock system is manufactured from stainless steel. This guarantees a long lifespan with high resistance to corrosion and impact.

The housing interlock system provides integrated safety. Our unique, patented spring system provides the housing interlock with a secure grip and prevents accidental opening.

The laser marking allows for easy and quick identification. Each housing is permanently labelled with a laser marking so that each product can be quickly designated and positioned.

Weidmüller RockStar® IP 65 / NEMA Type 4X housings - your first choice for industrial housings with IP 65 protection.

**General ordering data**

Type	HDC 10A DMDL 2BO	Version
Order No.	<a href="#">1665880000</a>	HDC enclosures, Size: 2, Protection degree: IP65 (in plugged condition), Cover for lower part of housing, End-locking clamp, lower side, Standard
GTIN (EAN)	4008190422912	
Qty.	1 pc(s).	