

WEITERGABE SOWIE VERVIELFÄLTIGUNG DIESES DOKUMENTS, VERWERTUNG UND MITTEILUNG SEINES INHALTS SIND VERBOTEN. SOWEIT NICHT AUSDRUECKLICH GESTATTET.
ZUWIDERHANDLUNGEN VERPFLICHTEN ZU SCHADENERSATZ. ALLE RECHTE FUER DEN FALL DER PATENT-, GEBRAUCHSMUSTER- ODER GESCHMACKSMUSTEREINTRAGUNG VORBEHALTEN.
THE REPRODUCTION, DISTRIBUTION AND UTILIZATION OF THIS DOCUMENT AS WELL AS THE COMMUNICATION OF ITS CONTENTS TO OTHERS WITHOUT EXPLICIT AUTHORIZATION IS PROHIBITED.
OFFENDERS WILL BE HELD LIABLE FOR THE PAYMENT OF DAMAGES. WEIDMUELLER EXCLUSIVELY RESERVES THE RIGHT TO FILE FOR PATENTS, UTILITY MODELS OR DESIGNS.

© WEIDMUELLER INTERFACE GmbH & Co.KG

LP-NUTZEN
PCB PANEL CH20M 2.3 3...

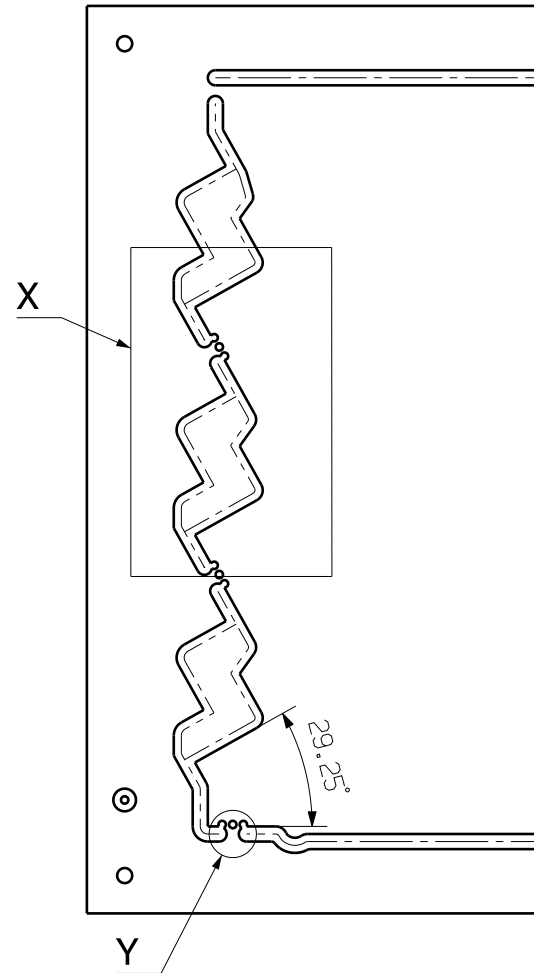

LP-NUTZEN
PCB PANEL CH20M 2.3 1...

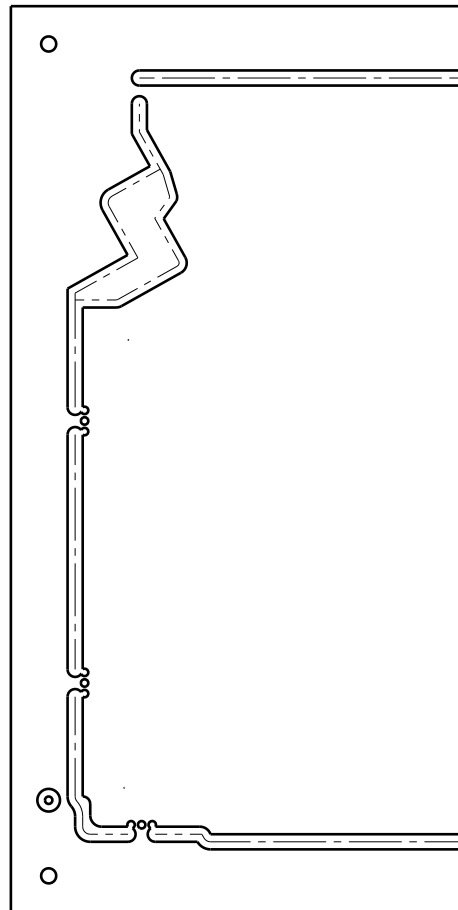

LP-NUTZEN
PCB PANEL CH20M 2.3 2...

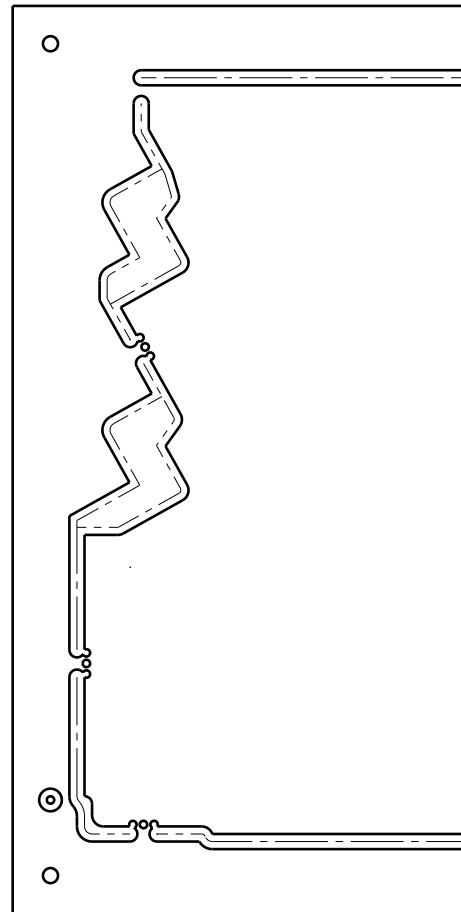

LP-NUTZEN
PCB PANEL CH20M 2.3 RPP...

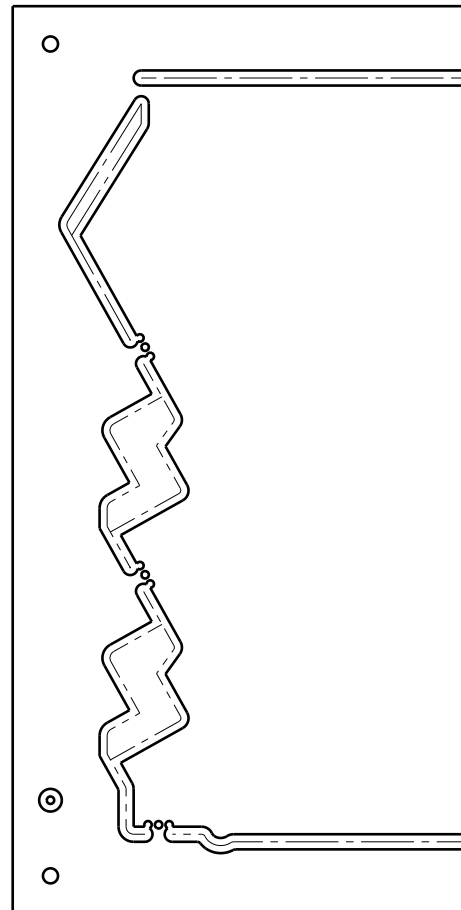

LP-NUTZEN
PCB PANEL CH20M 2.3...

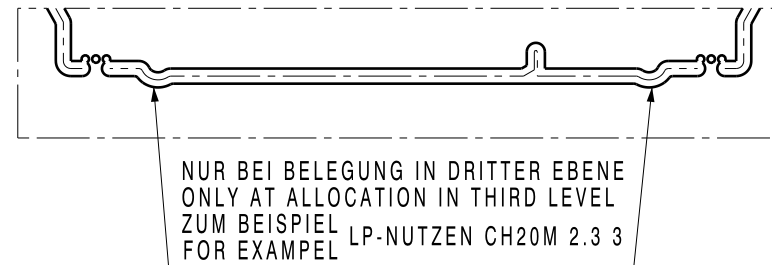

LP-NUTZEN
PCB PANEL CH20M 2.3...BUS

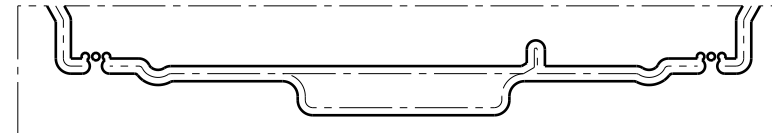

LP-NUTZEN
PCB PANEL CH20M 2.3...FE

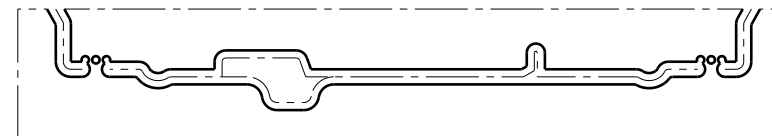

LP-NUTZEN
PCB PANEL CH20M 2.3...BUS FE

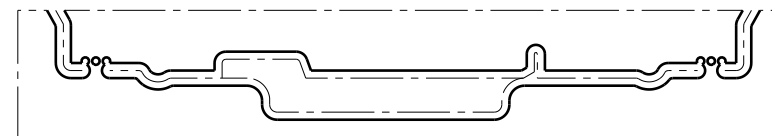

X 2/1

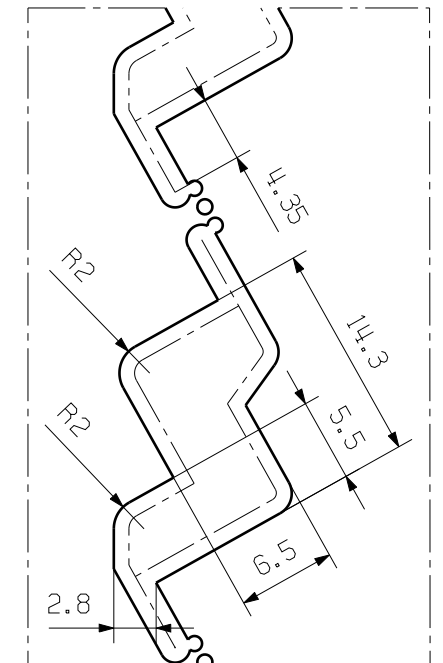

6x
Y 5/1

Ø1.0 IM BOHRPROGRAMM ENTHALTEN
INCLUDED IN THE DRILLING PROGRAM

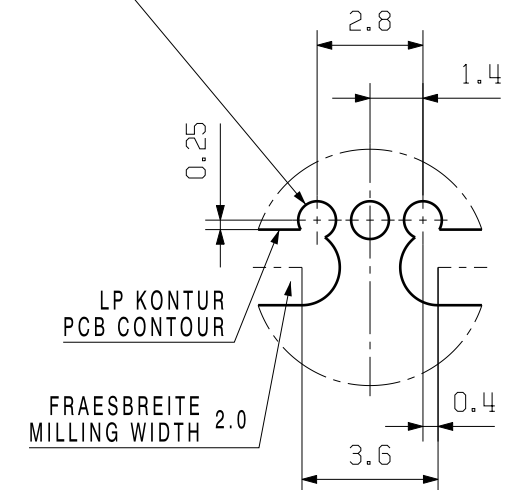

MATERIAL: .	MAX. NRN./NOS.	PART NO.: .	MAT.NO.: .	CAT.NO.: .
		FINISH TO .	SURFACE AREA: . mm ²	
		FINISH: .	GENERAL TOLERANCES: TOLERANCES TO ISO 8015	
		<input checked="" type="checkbox"/> ±0.15	<input type="checkbox"/> WN 212010	<input type="checkbox"/> ISO 2768-m
	72825/5 16.10.13	02		
MODIFICATION		Weidmüller		C 48760 09
	DATE	NAME	DRAWING NO. SHEET 05 OF 05 SHEETS	
	DRAWN	13.10.2009	VAN_GIESEN_B	
R.PART NO.: .	RESPONSIBLE		VAN_GIESEN_B	
SCALE: 1/1	CHECKED	25.10.2013	WEIDMUELLER_B	
SUPERSEDES: .	APPROVED		HANKE_D	
		PRODUCT FILE: CH20M...		5670

LP CH20M 2.3
09 LP-NUTZEN
09 PCB-PANELS