

WEITERGABE SOWIE Vervielfältigung dieses Dokuments, Verwertung und Mitteilung seines Inhalts sind verboten, soweit nicht ausdrücklich gestattet.
ZUÄNDERUNGEN VERPFLICHTEN ZU SCHADENSATZ. ALLE RECHTE FÜR DEN FALL DER PATENT-, GEBÄUCHSMUSTER-, ODER GESCHÄFTSMUSTERENTRAGUNG VORBEHALTEN.
THE REPRODUCTION AND THE REUSE OF THIS DOCUMENT, THE REUSE OF ITS CONTENTS AND THE DISSEMINATION OF ITS CONTENTS ARE PROHIBITED.
OFFENDERS WILL BE HELD LIABLE FOR THE PAYMENT OF DAMAGES. WEIDMÜLLER EXCLUSIVELY RESERVES THE RIGHT TO FILE FOR PATENTS, UTILITY MODELS OR DESIGNS.
© WEIDMÜLLER INTERFACE GmbH & Co. KG

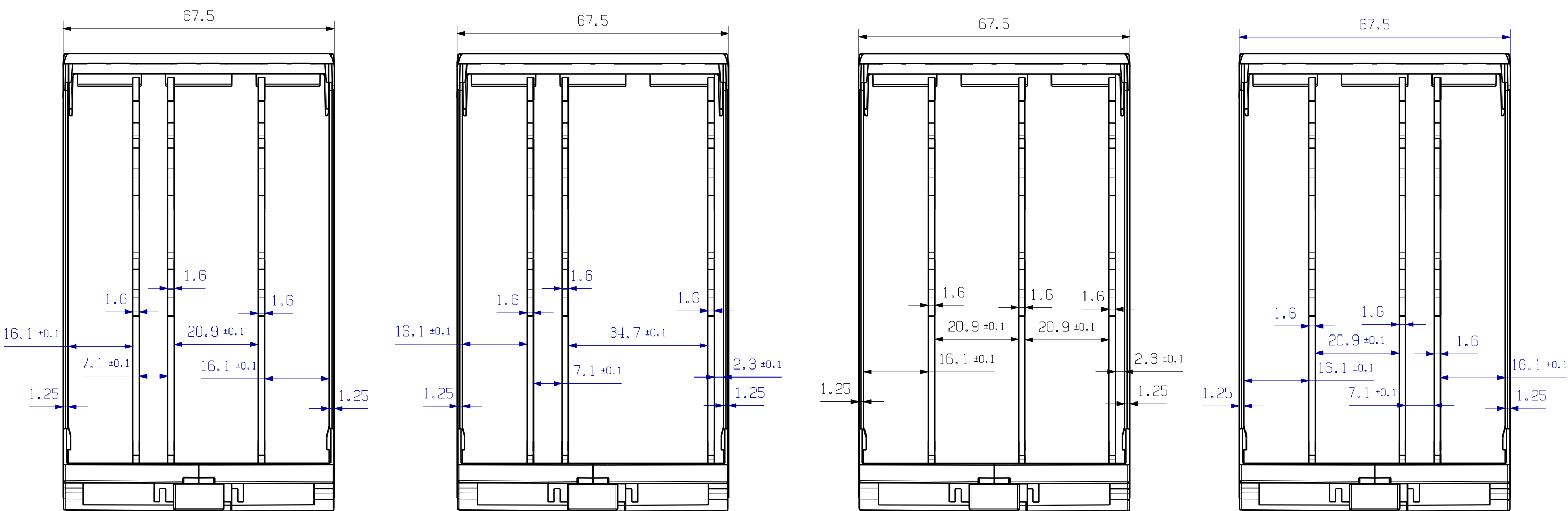
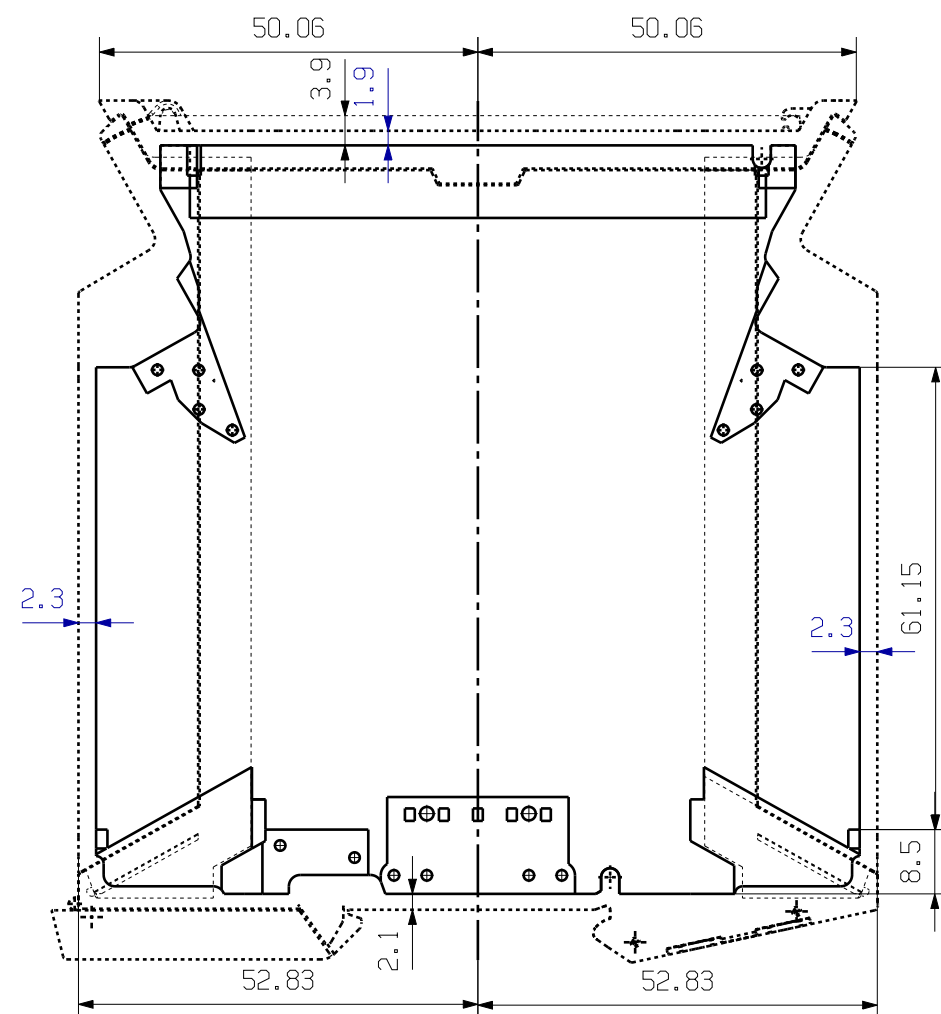
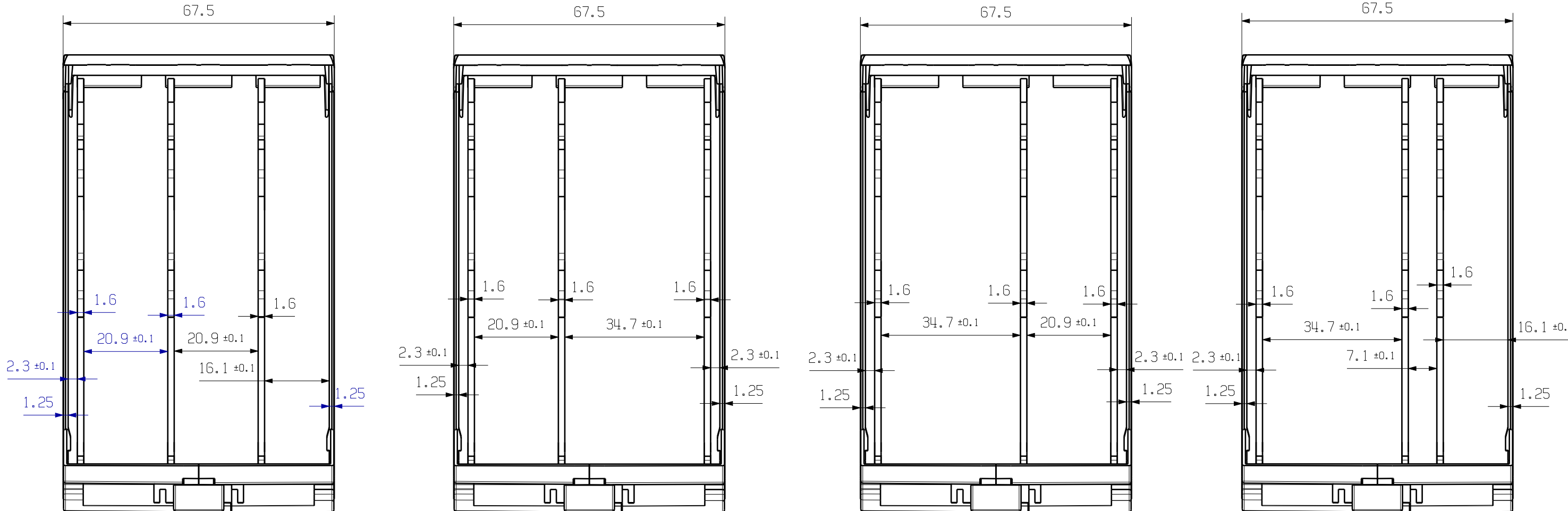
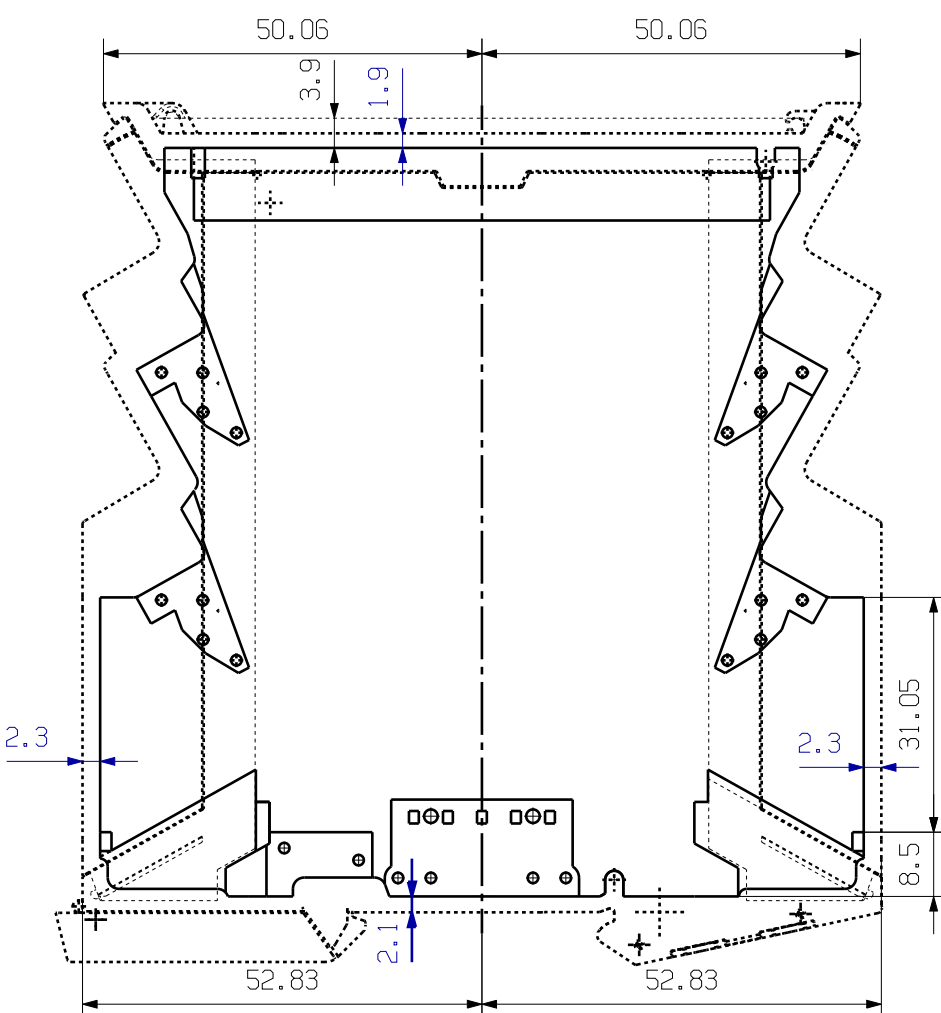
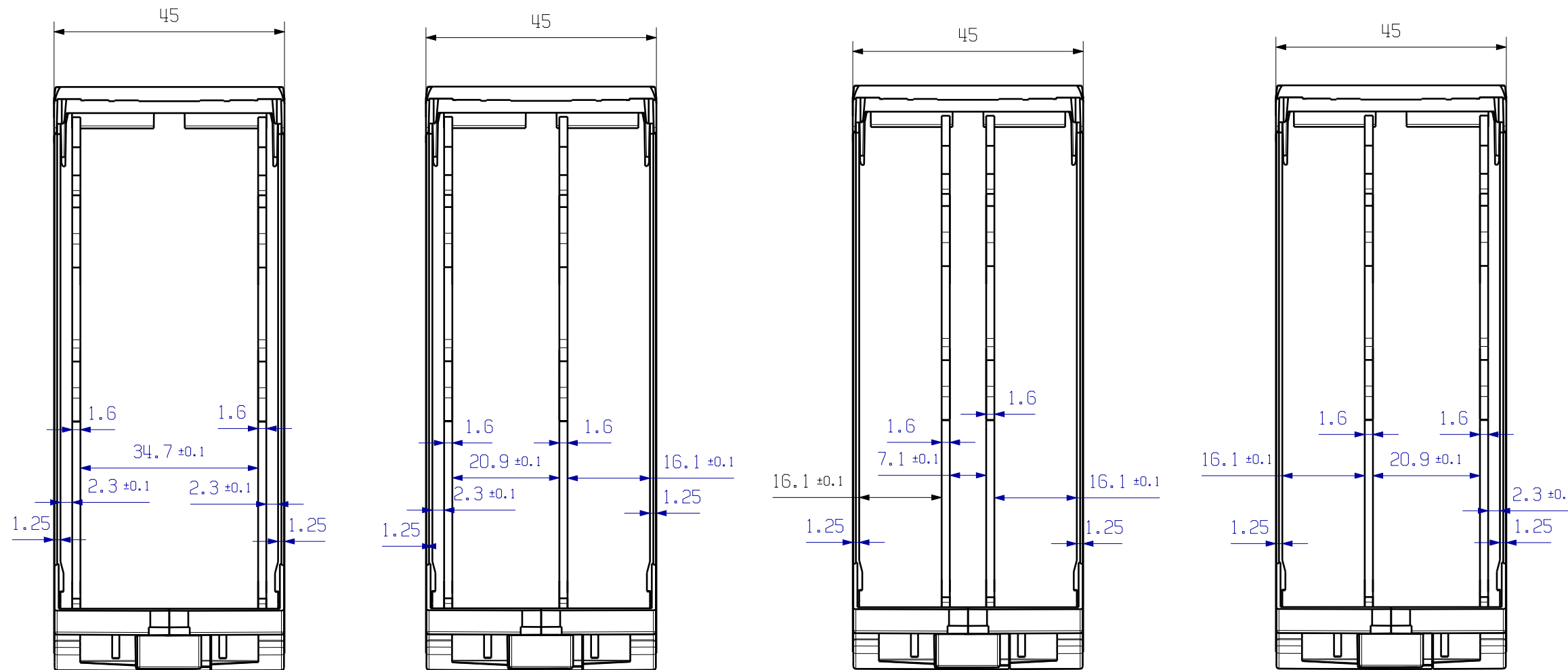
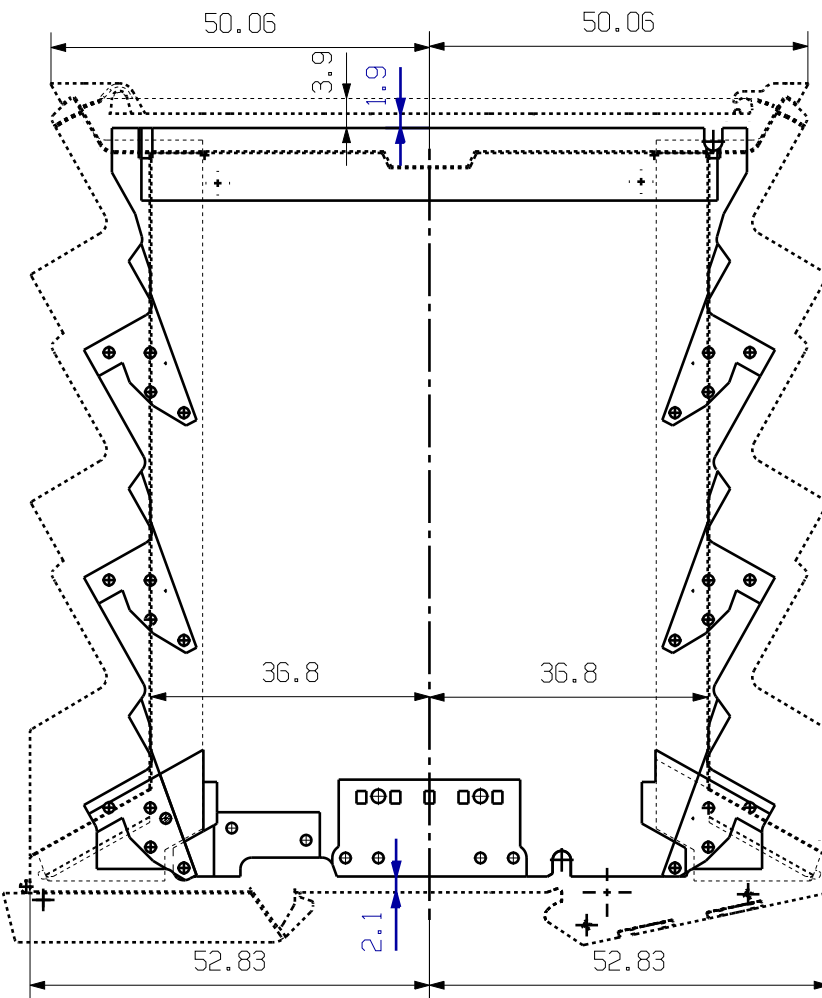
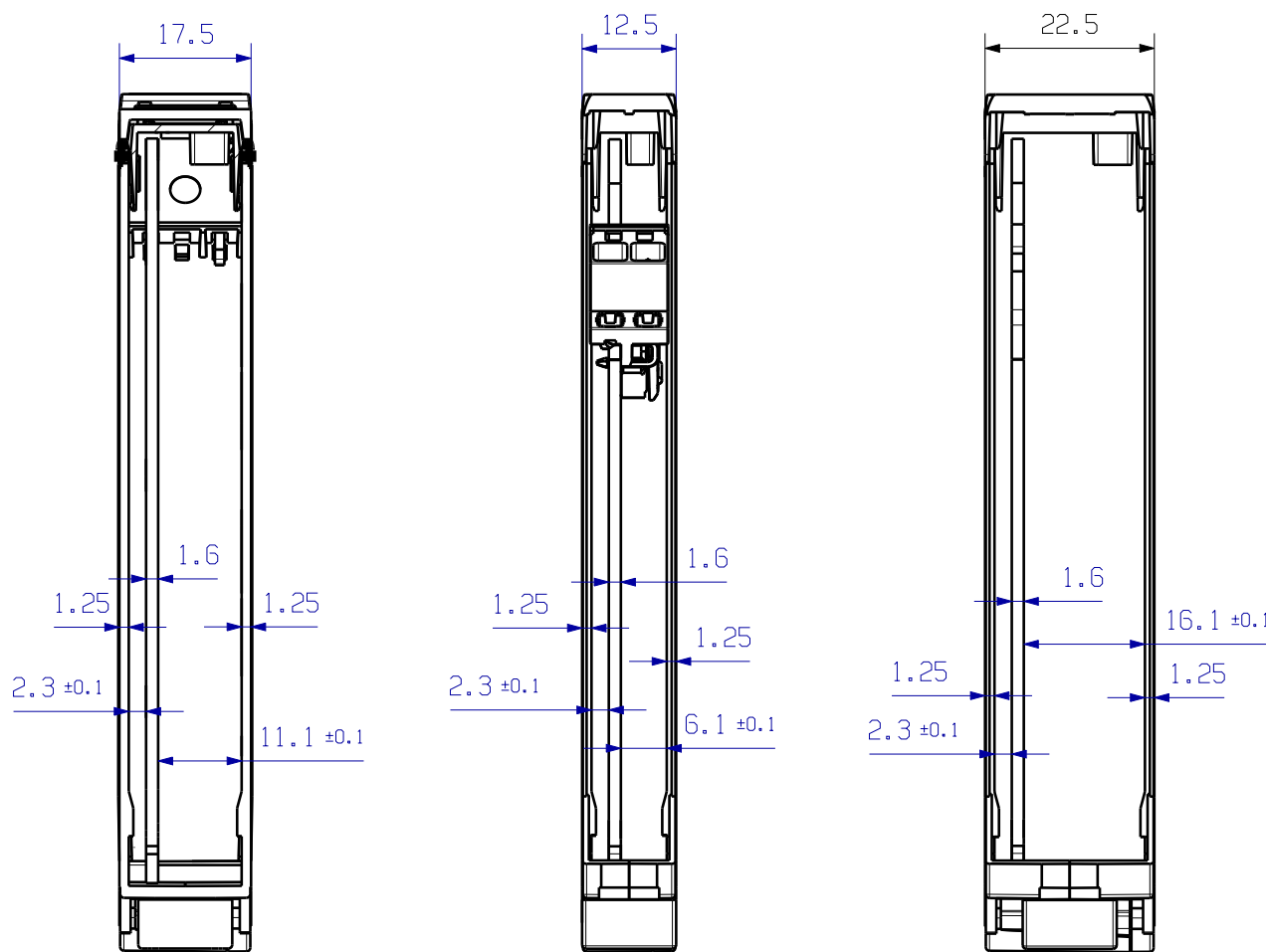
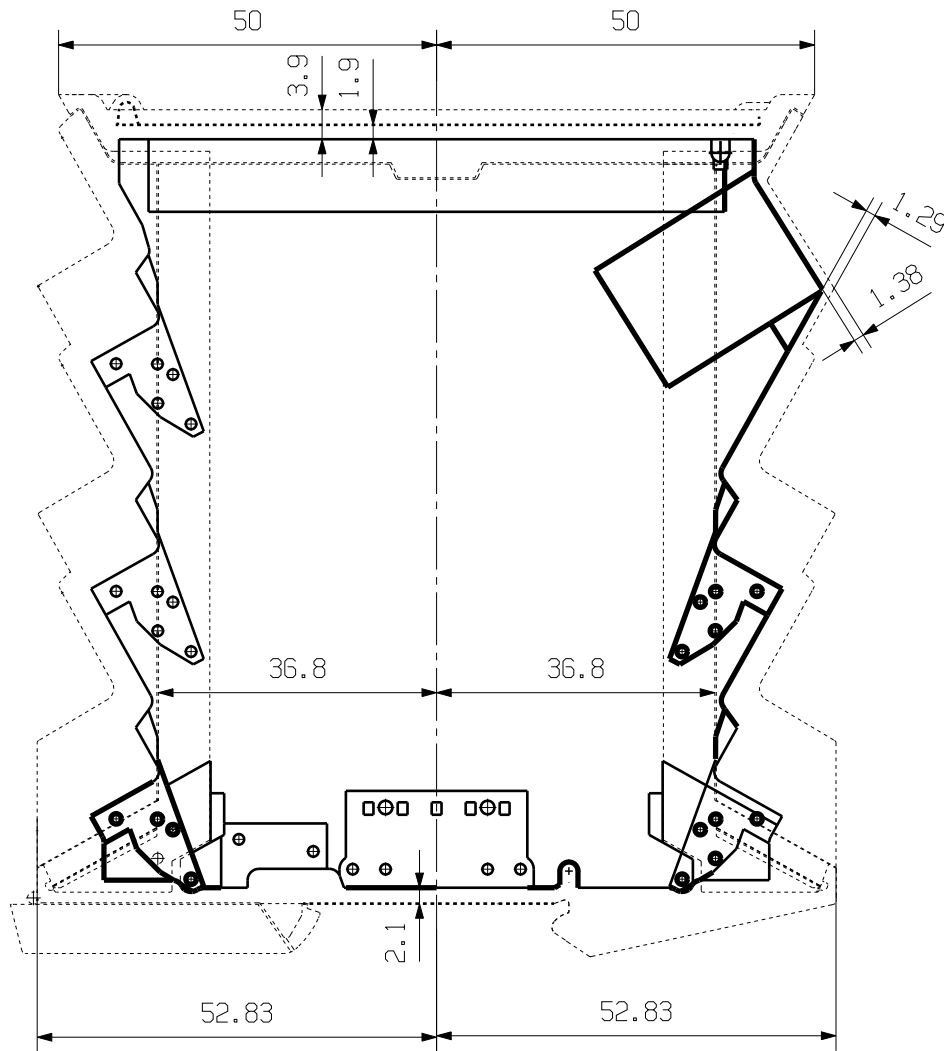

MATERIAL: .	PART NO.: .		MAT. NO.: .	CAT. NO.: .
	FINISH TO .		SURFACE AREA: . mm²	
	FINISH: .		TOLERANCES TO ISO 8013	
	GENERAL TOLERANCES: .		TOLERANCES TO ISO 2768-1	
72825/5 16.10.13	00	Weidmüller		C 48760 09
MODIFICATION		DRAWING NO. SHEET 03 OF 05 SHEETS		ISSUE NO.
DRAWN	13.10.2009	NAME		
RESPONSIBLE		VAN_DIESEN_B		
CHECKED	25.10.2013	HECKERT_M		
APPROVED		HAWKE_D		
R. PART NO.: .	SCALE: 1/1		LP-POSITIONEN IM GEHÄUSE LP-POSITION INSIDE HOUSING	
SUPERSEDES: .	APPROVED		PRODUCT FILE: CH20M...	